



Report of: **Service Director, Public Protection**

Meeting of	Date	Agenda Item	Ward(s)
Licensing Sub-Committee	20 June 2012		Bunhill

Delete as appropriate	Exempt	Non-exempt

Subject: PREMISES LICENCE NEW APPLICATION
Tesco, 24 Chiswell Street, London EC1V 4PA

1. Synopsis

- 1.1 This is an application for a new premise licence under the Licensing Act 2003.
- 1.2 The new application is to allow the sale of alcohol between 6am and 11pm, Mondays to Sundays, for consumption off the premises.

2. Recommendations

- 2.1 To determine the application for a new premises licence under Section 17 of the Licensing Act 2003.
- 2.2 If the Committee grants the application it should be subject to:
 - i. conditions prepared by the Licensing Officer which are consistent with the Operating Schedule (See appendix 3);
 - ii. conditions recommended by responsible Authorities (see appendix 3);
 - iii. any conditions deemed necessary by the Committee to promote the four licensing objectives.

3. Background

3.1 Papers are attached as follows:-

Appendix 1: application form;

Appendix 2a: name & address details of those persons making representations;

Appendix 2: representations;

Appendix 3: suggested conditions and map of premise location.

3.2 Representation was received from Islington's Licensing health and Safety Officer.

4. Planning Implications

4.1 The Planning Team have confirmed that the premises has the requisite planning consent.

5. Conclusion and reasons for recommendations

5.1 The Council is required to consider this application in the light of all relevant information, and if approval is given, it may attach such conditions necessary to promote the licensing objectives.

Background papers:

The Council's Statement of Licensing Policy

Licensing Act 2003

Secretary of States Guidance

Final Report Clearance

Signed by

Service Director – Public Protection

Date 11/6/12

Received by

Head of Scrutiny and Democratic Services

Date

Report author: Simon Gallacher

Tel: 020 7527 3879

E-mail: simon.gallacher@islington.gov.uk

**Application for a premises licence to be granted
under the Licensing Act 2003**

PLEASE READ THE FOLLOWING INSTRUCTIONS FIRST

Before completing this form please read the guidance notes at the end of the form. If you are completing this form by hand please write legibly in block capitals. In all cases ensure that your answers are inside the boxes and written in black ink. Use additional sheets if necessary.
You may wish to keep a copy of the completed form for your records.

I/We	Tesco Stores Ltd
-------------	------------------

(Insert name(s) of applicant)

apply for a premises licence under section 17 of the Licensing Act 2003 for the premises described in Part 1 below (the premises) and I/we are making this application to you as the relevant licensing authority in accordance with section 12 of the Licensing Act 2003

Part 1 – Premises Details

Postal address of premises or, if none, ordnance survey map reference or description			
Tesco Stores Ltd 24 Chiswell Street			
Post town	London	Post code	EC1Y 4TY

Telephone number at premises (if any)	-
Non-domestic rateable value of premises	Not Yet Assessed, but enclosing cheque for £315.00 to cover fee

Part 2 - Applicant Details

Please state whether you are applying for a premises licence as
Please tick yes

- | | | |
|---|---|-----------------------------|
| a) an individual or individuals * | | please complete section (A) |
| b) a person other than an individual * | | |
| i. as a limited company | X | please complete section (B) |
| ii. as a partnership | | please complete section (B) |
| iii. as an unincorporated association or | | please complete section (B) |
| iv. other (for example a statutory corporation) | | please complete section (B) |
| c) a recognised club | | please complete section (B) |

d)	a charity	please complete section (B)
e)	the proprietor of an educational establishment	please complete section (B)
f)	a health service body	please complete section (B)
g)	a person who is registered under Part 2 of the Care Standards Act 2000 (c14) in respect of an independent hospital	please complete section (B)
h)	the chief officer of police of a police force in England and Wales	please complete section (B)

* If you are applying as a person described in (a) or (b) please confirm:

	Please tick yes
• I am carrying on or proposing to carry on a business which involves the use of the premises for licensable activities; or	X
• I am making the application pursuant to a <ul style="list-style-type: none"> • statutory function or • a function discharged by virtue of Her Majesty's prerogative 	

(A) INDIVIDUAL APPLICANTS (fill in as applicable)

Mr	Mrs	Miss	Ms	Other Title (for example, Rev)	
Surname			First names		
I am 18 years old or over				Please tick yes	
Current postal address if different from premises address					
Post Town		Postcode			
Daytime contact telephone number					
E-mail address (optional)					

SECOND INDIVIDUAL APPLICANT (if applicable)

Mr	Mrs	Miss	Ms	Other Title (for example, Rev)	
Surname			First names		
I am 18 years old or over				Please tick yes	
Current postal address if different from premises address					
Post Town		Postcode			
Daytime contact telephone number					
E-mail address (optional)					

(B) OTHER APPLICANTS

Please provide name and registered address of applicant in full. Where appropriate please give any registered number. In the case of a partnership or other joint venture (other than a body corporate), please give the name and address of each party concerned.

Name Tesco Stores Ltd

Address

Tesco House
Delamare Road
Cheshunt
Waltham Cross
Herts
EN8 9SL

Registered number (where applicable)
Company Number: 00519500

Description of applicant (for example, partnership, company, unincorporated association etc.)
Limited Company

Telephone number (if any) 01707 298345

E-mail address (optional) licensing.team@uk.tesco.com

PLEASE NOTE THIS EMAIL ADDRESS HAS RECENTLY CHANGED.

Part 3 Operating Schedule

When do you want the premises licence to start?	Day As soon as possible Month Year
If you wish the licence to be valid only for a limited period, when do you want it to end?	Day Month Year

Please give a general description of the premises (please read guidance note1)

Retail premises (supermarket) selling a range of goods and services. This includes the sale of alcohol for consumption off the premises. Sales of alcohol for consumption off the premises are made from the supermarket sales floor as shown on the enclosed plan.

If 5,000 or more people are expected to attend the premises at any one time, please state the number expected to attend.	N/A
--	-----

What licensable activities do you intend to carry on from the premises?
(Please see sections 1 and 14 of the Licensing Act 2003 and Schedules 1 and 2 to the Licensing Act 2003)

Provision of regulated entertainment		Please tick yes
a)	plays (if ticking yes, fill in box A)	
b)	films (if ticking yes, fill in box B)	
c)	indoor sporting events (if ticking yes, fill in box C)	
d)	boxing or wrestling entertainment (if ticking yes, fill in box D)	
e)	live music (if ticking yes, fill in box E)	
f)	recorded music (if ticking yes, fill in box F)	
g)	performances of dance (if ticking yes, fill in box G)	
h)	anything of a similar description to that falling within (e), (f) or (g) (if ticking yes, fill in box H)	
Provision of entertainment facilities:		
i)	making music (if ticking yes, fill in box I)	
j)	dancing (if ticking yes, fill in box J)	

k)	entertainment of a similar description to that falling within (i) or (j) (if ticking yes, fill in box K)	
Provision of late night refreshment (if ticking yes, fill in box L)		
Supply of alcohol (if ticking yes, fill in box M)		X

In all cases complete boxes N, O and P

A

Plays Standard days and timings (please read guidance note 6)			Will the performance of a play take place indoors or outdoors or both – please tick (please read guidance note 2)	Indoors		
Day	Start	Finish		Outdoors		
Mon				Please give further details here (please read guidance note 3)	Both	
Tue			State any seasonal variations for performing plays (please read guidance note 4)			
Wed						
Thur			Non standard timings. Where you intend to use the premises for the performance of plays at different times to those listed in the column on the left, please list (please read guidance note 5)			
Fri						
Sat						
Sun						

M

Supply of alcohol Standard days and timings (please read guidance note 6)			Will the supply of alcohol be for consumption (Please tick box) (please read guidance note 7)	On the premises	
				Off the premises	X
				Both	
Day	Start	Finish	State any seasonal variations for the supply of alcohol (please read guidance note 4) N/A		
Mon	0600	2300			
Tue	0600	2300			
Wed	0600	2300			
Thur	0600	2300			
Fri	0600	2300			
Sat	0600	2300			
Sun	0600	2300			
			Non standard timings. Where you intend to use the premises for the supply of alcohol at different times to those listed in the column on the left, please list (please read guidance note 5)		
			N/A		

State the name and details of the individual whom you wish to specify on the licence as premises supervisor

Name	Greg Bartley
Address	39 Offley Road Hitchin Herts
Postcode	SG5 2BB
Personal Licence number (if known)	Harlow/pers/0094
Issuing licensing authority (if known)	Harlow District Council

N

Please highlight any adult entertainment or services, activities, other entertainment or matters ancillary to the use of the premises that may give rise to concern in respect of children (please read guidance note 8)

N/A

O

Hours premises are open to the public Standard days and timings (please read guidance note 6)			State any seasonal variations (please read guidance note 4)
Day	Start	Finish	N/A Non standard timings. Where you intend the premises to be open to the public at different times from those listed in the column on the left, please list (please read guidance note 5)
Mon	0600	2300	
Tue	0600	2300	
Wed	0600	2300	
Thur	0600	2300	
Fri	0600	2300	
Sat	0600	2300	
Sun	0600	2300	

P Describe the steps you intend to take to promote the four licensing objectives:

a) General – all four licensing objectives (b,c,d,e) (please read guidance note 9)

We are a national retailer that sells alcohol as part of a broad offering of goods and services. We have held off-licences in our stores for many years and are an approved British Institute of Inn-keeping examination centre. We have written training policies and formal training programmes are in place, which ensure our people are equipped to meet all licensing objectives. All training and revision/refresher materials are reviewed regularly. All stores currently comply with our 'Think 25' policy, this is brought to customer's attention through point of sale material within the store. We take legal compliance very seriously and in addition to local training we employ a central alcohol licensing compliance manager and have a compliance committee.

b) The prevention of crime and disorder

The premises will have digital CCTV system that covers many areas of the shop floor, including the proposed area which will be used for beer and wine, should we be successful with our application. Images will be retained for a minimum of 21 days and made available on enforcement request. Ordinarily, a member of the Management team will be on the premises all the time the store is open. A person will have responsibility for the premises whilst the premises are open.

c) Public safety

A person will have responsibility for the premises whilst the premises are open. Management will be trained to support the running of the premises including looking after our customers and staff. The store will adhere to all rules and regulations relating to public safety.

d) The prevention of public nuisance

We intend to be an active member of the community.
We welcome the opportunity to liaise with Police and enforcement authorities should the need arise.

e) The protection of children from harm

All staff will be trained and regularly refreshed in the corporate 'Think 25' Policy. Staff will be trained to look at the customer and 'Think 25' when selling alcohol.
A till prompt will appear on the initial sale of alcohol that will remind the seller of their responsibilities including not to sell alcohol to anyone under the age of 18.
The store will display signage around the premises informing both staff and customers of our 'Think 25' policy on alcohol.

		Please tick yes
<input type="checkbox"/>	I have made or enclosed payment of the fee	X
<input type="checkbox"/>	I have enclosed the plan of the premises	X
<input type="checkbox"/>	I have sent copies of this application and the plan to responsible authorities and others where applicable	X
<input type="checkbox"/>	I have enclosed the consent form completed by the individual I wish to be premises supervisor, if applicable	X
<input type="checkbox"/>	I understand that I must now advertise my application	X
<input type="checkbox"/>	I understand that if I do not comply with the above requirements my application will be rejected	X

IT IS AN OFFENCE, LIABLE ON CONVICTION TO A FINE UP TO LEVEL 5 ON THE STANDARD SCALE, UNDER SECTION 158 OF THE LICENSING ACT 2003 TO MAKE A FALSE STATEMENT IN OR IN CONNECTION WITH THIS APPLICATION

Part 4 – Signatures (please read guidance note 10)

Signature of applicant or applicant's solicitor or other duly authorised agent (See guidance note 11). If signing on behalf of the applicant please state in what capacity.

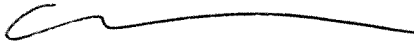
Signature	
Date	16/4/12
Capacity	Greg Bartley - Licensing Manager

For joint applications signature of 2nd applicant or 2nd applicant's solicitor or other authorised agent. (Please read guidance note 12). If signing on behalf of the applicant please state in what capacity.

Signature	
Date	
Capacity	

Contact name (where not previously given) and postal address for correspondence associated with this application (please read guidance note 13)

Greg Bartley
Licensing Team, Tesco Stores Ltd, Cirrus Building C, Shire Park

Post town	Welwyn Garden City	Post code	AL7 1ZR
Telephone number (if any)	01707 298345		
If you would prefer us to correspond with you by e-mail your e-mail address (optional)			
licensing_team@uk.tesco.com			

Client	Room No.	Room Name	Area (sqm)	Planned Space	Actual Space
Client	1	RECEPTION	10.00	10.00	10.00
	2	SALES	15.00	15.00	15.00
	3	SALES	15.00	15.00	15.00
	4	SALES	15.00	15.00	15.00
	5	SALES	15.00	15.00	15.00
	6	SALES	15.00	15.00	15.00
	7	SALES	15.00	15.00	15.00
	8	SALES	15.00	15.00	15.00
	9	SALES	15.00	15.00	15.00
	10	SALES	15.00	15.00	15.00
	11	SALES	15.00	15.00	15.00
	12	SALES	15.00	15.00	15.00
	13	SALES	15.00	15.00	15.00
	14	SALES	15.00	15.00	15.00
	15	SALES	15.00	15.00	15.00
	16	SALES	15.00	15.00	15.00
	17	SALES	15.00	15.00	15.00
	18	SALES	15.00	15.00	15.00
	19	SALES	15.00	15.00	15.00
	20	SALES	15.00	15.00	15.00

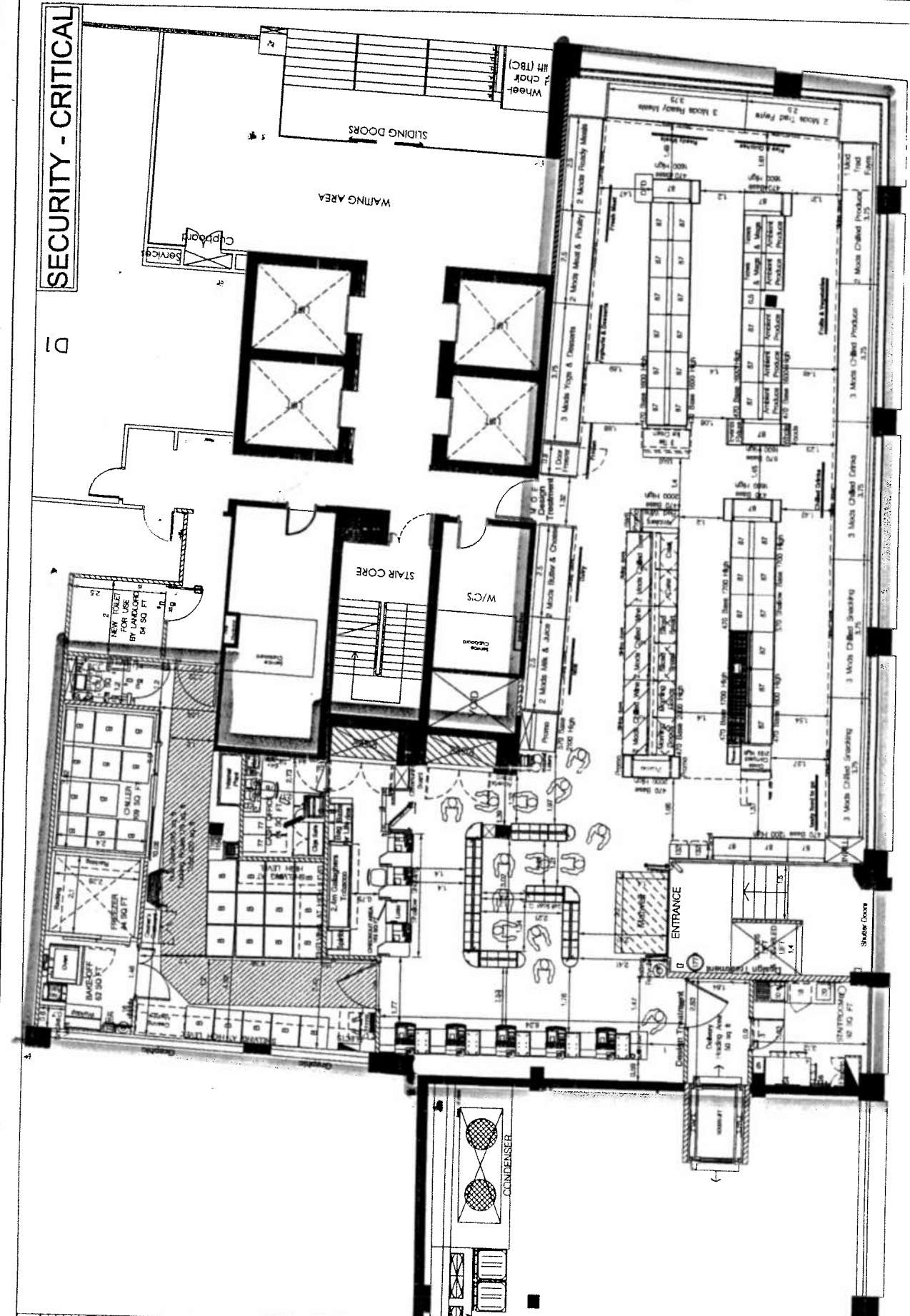

SECURITY - CRITICAL

TESCO express
 TESCO STORES GROUP
 EXPRESS STORES LIMITED
 P.O. BOX 400, CITRUS BUILDING, SHIRE PARK
 WELWYN HILLS, HERTS, SG13 7JF, UK
 TEL: 0457 626 200
 FAX: 0457 626 201
 E-MAIL: tesco@tesco.com

PROJECT
6545 LONDON 24 CHIS ST EXP

DESCRIPTION
STANDALONE PROPOSED RETAIL LAYOUT

DRAWING NO. **6545BLOCKPLAN.dgn**

PHASE - ISSUE **BLOCKPLAN**

SYSTEM ID. NO. **RETAIL**

SCALE **1:100 @A3**

DATE **13.03.2012**

PLANNER **Jonathon Turner @ HSC Dhanalakshmi**

DATE	REV	AMENDMENTS
11.03.12	1	15. Fine extinguisher foam
11.03.12	2	16. One extinguisher Co2

REV. AMENDMENTS

BUILDING SURVEY:- RECEIVED

LOTTERY:- APPROVED

NO ATM

COFFEE MACHINE:- APPROVED

SSC:- NOT APPLICABLE

IDM DATES:- WEEK 6

FORMAT EXCEPTION:-

RDG DATES:-

Geoff Weaver	Licensing Health and Safety Officer	Public Protection Division	222 Upper Street	London	N1 1XR
--------------	---	----------------------------	------------------	--------	--------



ISLINGTON

**Islington Licensing Authority
Licensing Act 2003**

Representation form from Responsible Authority for Health and Public Safety

Name	Geoff Weaver
Job title	Senior Building Surveyor (Licensing Health and Safety)
Postal address	Islington Council, Building Control Service 222 Upper Street, London N1 1XR
email	geoff.weaver@islington.gov.uk
Contact telephone number	020 7527 5986
Name and address of the premises concerning the representation	Tesco Express 24 Chiswell Street EC1Y 4TY
Public Safety	The premises are being constructed and the building works should be inspected and approved before the premises are occupied under the licence. Insufficient detail on the premises plan of the ventilation, lighting and emergency lighting, fire fighting appliances, fire and emergency warning systems, exits and exit signage.
Suggested conditions that could be added to the licence to remedy the public safety representation	The premises shall not be used under the licence until the arrangements at the premises are suitable and sufficient for health and public safety and have been approved in writing by the responsible authority for health and public safety.

Signed: _____ Date: _____

Please return this form along with any additional sheets to: Applicant and Islington Council, Licensing Team, 222 Upper Street, London N1 1XR or email to licensing@islington.gov.uk This form must be returned within the statutory period. For more details please check with the Licensing Support Team on 020 7527 3031.

Suggested conditions of approval consistent with the operating schedule

1. The premises shall have a digital CCTV system that covers many areas of the shop floor, including the proposed area which will be used for beer and wine. Images shall be retained for a minimum of 21 days and made available on enforcement request.
2. There shall be a member of staff on the premises that shall take responsibility for the premises whilst they are open.
3. All members of the management team shall be trained to support the running of the premises and the public safety of the customers and staff.
4. The licensee shall adhere to all rules and regulations regarding public safety.
5. The manager/Designated Premises Supervisor shall actively participate in and support the local shopwatch scheme.
6. All staff shall be trained and regularly refreshed in the corporate 'Think 25' Policy. Staff shall be trained to look at the customers and 'Think 25' when selling alcohol.
7. A till prompt shall appear on the initial sale of alcohol that shall remind the seller of their responsibilities including not to sell alcohol to anyone under the age of 18.
8. Signage shall be displayed around the premises informing both staff and customers of the 'Think 25' policy on alcohol.

Suggested conditions of approval recommended by Health and Safety

9. The premises shall not be used under the licence until the arrangements at the premises are suitable and sufficient for health and public safety and have been approved in writing by the responsible authority for health and public safety.

