



Report of: **Service Director, Public Protection**

Meeting of	Date	Agenda	Ward(s)
Licensing Sub-Committee	12 th September 2012	B1	Mildmay

Delete as appropriate		Non-exempt
-----------------------	--	------------

Subject: PREMISES LICENCE NEW APPLICATION
RE: STAR FOOD & WINE, 138 – 140 BALLS POND ROAD, LONDON, N1 4AD

1. Synopsis

- 1.1 This is an application for a new premise licence under the Licensing Act 2003.
- 1.2 The new application is to:
 - i) Allow the sale by retail of alcohol, Sunday to Thursday 06:00 to 01:00, Friday and Saturday 06:00 to 03:00 the following day.

2. Recommendations

- 2.1 To determine the application for a new premises licence under Section 17 of the Licensing Act 2003.
- 2.2 If the Committee grants the application it should be subject to:
 - i. conditions of the current premises licence;
 - ii. conditions prepared by the Licensing Officer which are consistent with the Operating Schedule (See appendix 3);
 - iii. conditions recommended by responsible Authorities (see appendix 3);
 - iv. any conditions deemed necessary by the Committee to promote the four licensing objectives.

3. Background

- 3.1 This application is for a new premises licence for 138 – 140 Balls Pond Road, to allow the sale by retail of alcohol:
 - 3.1.1 Sunday to Thursday 06:00 to 01:00 the following day,
 - 3.1.2 Saturday and Friday 06:00 to 03:00 the following day.
- 3.2 This premises previously held two separate licences:
 - 3.2.1 Star Off Licence, 138 Balls Pond Road which held a 24 hour off licence seven days a week
 - 3.2.2 Star Supermarket 140 Balls Pond Road which held a licence for the sale of alcohol from 06:00 until 01:00 Monday to Sunday.
- 3.3 The licensee for both premises carried out building works to remove the party wall to convert two premises into one thereby making one large shop unit.
- 3.4 These works were carried out with building regulations approval but not Licensing and Planning's authorisation.
- 3.5 Under the Licensing Act 2003 the approved layout of the premises is part of the Licence conditions with the premises plan forming annexe 4 of the licence. Any amendments made to the layout of the premises prior to a variation application being granted constitute an offence and any licensable activities undertaken at the premises are unauthorised. Effectively this action invalidated both premises licences. Licensing Officers visited the premises on 21st June 2012 and advised the occupier of the premises that the premises licences were invalid and that he would need to apply for a new premises licence.
- 3.6 The licensee has reinstated the original layouts of the two premises and has been trading under the terms and conditions of the Star Supermarket pending the outcome of the new premises licence application submitted on 26 July 2012.
- 3.7 Planning permission was required to cover changes to the external appearance resulting in two premises being converted into one.
- 3.8 Trading Standards and HMRC visited the premises on July 6th 2012 and seized a large quantity of illicit alcohol.
- 3.9 Papers are attached as follows:-

Appendix 1:	application form;
Appendix 1(A):	current licences;
Appendix 2:	representations;
Appendix 3:	suggested conditions and map of premise location.
- 3.10 The Licensing Authority has received 3 letters of representation, from the Council Health and Safety, Trading Standard and the Licensing Authority.

4 Planning Implications

- 4.1 The applicant need to contact planning in respect of the new shop front but the alterations do not affect the planning usage of the units as they are both still in the A1 use class.

5 Conclusion and reasons for recommendations

- 5.1 The Council is required to consider this application in the light of all relevant information, and if approval is given, it may attach such conditions necessary to promote the licensing objectives.

Background papers:

The Council's Statement of Licensing Policy

Licensing Act 2003

Secretary of States Guidance

Final Report Clearance

Signed by

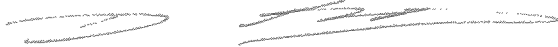

Service Director – Public Protection

Date *3rd September 2012*

Received by

Head of Scrutiny and Democratic Services

Date

Report author: Anthony Baptiste

Tel: 020 7527 3014

Fax: 020 7527 3430

E-mail: Anthony.baptiste@islington.gov.uk

Application for a premises licence to be granted under the Licensing Act 2003

PLEASE READ THE FOLLOWING INSTRUCTIONS FIRST

Before completing this form please read the guidance notes at the end of the form. If you are completing this form by hand please write legibly in block capitals. In all cases ensure that your answers are inside the boxes and written in black ink. Use additional sheets if necessary. You may wish to keep a copy of the completed form for your records.

I/We MURAT KILIC
(Insert name(s) of applicant)

apply for a premises licence under section 17 of the Licensing Act 2003 for the premises described in Part 1 below (the premises) and I/we are making this application to you as the relevant licensing authority in accordance with section 12 of the Licensing Act 2003

Part 1 – Premises Details

Postal address of premises or, if none, ordnance survey map reference or description STAR FOOD & WINE 138-140 BALLS POND ROAD			
Post town	LONDON	Post code	N1 4AD
Telephone number at premises (if any)			
Non-domestic rateable value of premises	£15250		

Part 2 - Applicant Details

Please state whether you are applying for a premises licence as
Please tick yes

- a) an individual or individuals * please complete section (A)
- b) a person other than an individual *
 - i. as a limited company please complete section (B)
 - ii. as a partnership please complete section (B)
 - iii. as an unincorporated association or please complete section (B)
 - iv. other (for example a statutory corporation) please complete section (B)
- c) a recognised club please complete section (B)
- d) a charity please complete section (B)

26/7		Fee Paid		£190	
		CASH			
Receipt Number		0651381			

- e) the proprietor of an educational establishment please complete section (B)
- f) a health service body please complete section (B)
- g) a person who is registered under Part 2 of the Care Standards Act 2000 (c14) in respect of an independent hospital please complete section (B)
- h) the chief officer of police of a police force in England and Wales please complete section (B)

* If you are applying as a person described in (a) or (b) please confirm:

Please tick yes

- I am carrying on or proposing to carry on a business which involves the use of the premises for licensable activities; or
- I am making the application pursuant to a
 - statutory function or
 - a function discharged by virtue of Her Majesty's prerogative

(A) INDIVIDUAL APPLICANTS (fill in as applicable)

Mr <input checked="" type="checkbox"/>	Mrs <input type="checkbox"/>	Miss <input type="checkbox"/>	Ms <input type="checkbox"/>	Other Title (for example, Rev)	
Surname KILIC			First names MURAT		
I am 18 years old or over				<input checked="" type="checkbox"/> Please tick yes	
Current postal address if different from premises address		47B WARNEFORD STREET			
Post Town	LONDON		Postcode	E9 7NG	
Daytime contact telephone number					
E-mail address (optional)					

SECOND INDIVIDUAL APPLICANT (if applicable)

Mr <input type="checkbox"/>	Mrs <input type="checkbox"/>	Miss <input type="checkbox"/>	Ms <input type="checkbox"/>	Other Title (for example, Rev)	
Surname			First names		
I am 18 years old or over				<input type="checkbox"/> Please tick yes	

Current postal address if different from premises address			
Post Town		Postcode	
Daytime contact telephone number			
E-mail address (optional)			

(B) OTHER APPLICANTS

Please provide name and registered address of applicant in full. Where appropriate please give any registered number. In the case of a partnership or other joint venture (other than a body corporate), please give the name and address of each party concerned.

Name
Address
Registered number (where applicable)
Description of applicant (for example, partnership, company, unincorporated association etc.)
Telephone number (if any)
E-mail address (optional)

Part 3 Operating Schedule

When do you want the premises licence to start?

Day		Month		Year	
2	2	0	8	2	0
1	2				

If you wish the licence to be valid only for a limited period, when do you want it to end?

Day		Month		Year	
1	1	1	1	1	1

Please give a general description of the premises (please read guidance note1)
The premises is a tradition shop consisting of a ground floor, located on a major road.

Please refer to the enclosed plan.

If 5,000 or more people are expected to attend the premises at any one time, please state the number expected to attend.

What licensable activities do you intend to carry on from the premises?

(Please see sections 1 and 14 of the Licensing Act 2003 and Schedules 1 and 2 to the Licensing Act 2003)

Provision of regulated entertainment

Please tick yes

- a) plays (if ticking yes, fill in box A)
- b) films (if ticking yes, fill in box B)
- c) indoor sporting events (if ticking yes, fill in box C)
- d) boxing or wrestling entertainment (if ticking yes, fill in box D)
- e) live music (if ticking yes, fill in box E)
- f) recorded music (if ticking yes, fill in box F)
- g) performances of dance (if ticking yes, fill in box G)
- h) anything of a similar description to that falling within (e), (f) or (g) (if ticking yes, fill in box H)

Provision of entertainment facilities:

- i) making music (if ticking yes, fill in box I)
- j) dancing (if ticking yes, fill in box J)
- k) entertainment of a similar description to that falling within (i) or (j) (if ticking yes, fill in box K)

Provision of late night refreshment (if ticking yes, fill in box L)

Supply of alcohol (if ticking yes, fill in box M)

In all cases complete boxes N, O and P

A

Plays Standard days and timings (please read guidance note 6)			<u>Will the performance of a play take place indoors or outdoors or both – please tick</u> (please read guidance note 2)	Indoors	<input type="checkbox"/>
Day	Start	Finish		Outdoors	<input type="checkbox"/>
Mon				Both	<input type="checkbox"/>
Tue				<u>Please give further details here</u> (please read guidance note 3)	
Wed			<u>State any seasonal variations for performing plays</u> (please read guidance note 4)		
Thur			<u>Non standard timings. Where you intend to use the premises for the performance of plays at different times to those listed in the column on the left, please list</u> (please read guidance note 5)		
Fri					
Sat					
Sun					

B

Films Standard days and timings (please read guidance note 6)			Will the exhibition of films take place indoors or outdoors or both – please tick (please read guidance note 2)	Indoors	<input type="checkbox"/>
				Outdoors	<input type="checkbox"/>
				Both	<input type="checkbox"/>
Day	Start	Finish	Please give further details here (please read guidance note 3)		
Mon					
Tue			State any seasonal variations for the exhibition of films (please read guidance note 4)		
Wed					
Thur			Non standard timings. Where you intend to use the premises for the exhibition of films at different times to those listed in the column on the left, please list (please read guidance note 5)		
Fri					
Sat					
Sun					

C

Indoor sporting events Standard days and timings (please read guidance note 6)			Please give further details (please read guidance note 3)
Day	Start	Finish	
Mon			
Tue			State any seasonal variations for indoor sporting events (please read guidance note 4)
Wed			
Thur			Non standard timings. Where you intend to use the premises for indoor sporting events at different times to those listed in the column on the left, please list (please read guidance note 5)
Fri			
Sat			
Sun			

D

Boxing or wrestling entertainments Standard days and timings (please read guidance note 6)			<u>Will the boxing or wrestling entertainment take place indoors or outdoors or both – please tick</u> (please read guidance note 2)	Indoors	<input type="checkbox"/>
				Outdoors	<input type="checkbox"/>
				Both	<input type="checkbox"/>
Day	Start	Finish	<u>Please give further details here</u> (please read guidance note 3)		
Mon					
Tue			<u>State any seasonal variations for boxing or wrestling entertainment</u> (please read guidance note 4)		
Wed					
Thur			<u>Non standard timings. Where you intend to use the premises for boxing or wrestling entertainment at different times to those listed in the column on the left, please list</u> (please read guidance note 5)		
Fri					
Sat					
Sun					

E

Live music Standard days and timings (please read guidance note 6)			Will the performance of live music take place indoors or outdoors or both – please tick (please read guidance note 2)	Indoors	<input type="checkbox"/>
				Outdoors	<input type="checkbox"/>
				Both	<input type="checkbox"/>
Day	Start	Finish	Please give further details here (please read guidance note 3)		
Mon					
Tue					
Wed			State any seasonal variations for the performance of live music (please read guidance note 4)		
Thur					
Fri			Non standard timings. Where you intend to use the premises for the performance of live music at different times to those listed in the column on the left, please list (please read guidance note 5)		
Sat					
Sun					

F

Recorded music Standard days and timings (please read guidance note 6)			Will the playing of recorded music take place indoors or outdoors or both – please tick (please read guidance note 2)	Indoors	<input type="checkbox"/>
				Outdoors	<input type="checkbox"/>
				Both	<input type="checkbox"/>
Day	Start	Finish			
Mon			Please give further details here (please read guidance note 3)		
Tue			State any seasonal variations for the playing of recorded music (please read guidance note 4)		
Wed			Non standard timings. Where you intend to use the premises for the playing of recorded music at different times to those listed in the column on the left, please list (please read guidance note 5)		
Thur					
Fri					
Sat					
Sun					

G

Performances of dance Standard days and timings (please read guidance note 6)			<u>Will the performance of dance take place indoors or outdoors or both – please tick</u> (please read guidance note 2)	Indoors	<input type="checkbox"/>
Day	Start	Finish		Outdoors	<input type="checkbox"/>
Mon				Both	<input type="checkbox"/>
				Please give further details here (please read guidance note 3)	
Tue			State any seasonal variations for the performance of dance (please read guidance note 4)		
Wed			Non standard timings. Where you intend to use the premises for the performance of dance at different times to those listed in the column on the left, please list (please read guidance note 5)		
Thur					
Fri					
Sat					
Sun					

H

<p>Anything of a similar description to that falling within (e), (f) or (g) Standard days and timings (please read guidance note 6)</p>			<p><u>Please give a description of the type of entertainment you will be providing</u></p>		
Day	Start	Finish	<p><u>Will this entertainment take place indoors or outdoors or both – please tick</u> (please read guidance note 2)</p>	Indoors	<input type="checkbox"/>
Mon				Outdoors	<input type="checkbox"/>
				Both	<input type="checkbox"/>
Tue			<p><u>Please give further details here</u> (please read guidance note 3)</p>		
Wed					
Thur					
Fri			<p><u>State any seasonal variations for entertainment of a similar description to that falling within (e), (f) or (g)</u> (please read guidance note 4)</p>		
Sat			<p><u>Non standard timings. Where you intend to use the premises for the entertainment of a similar description to that falling within (e), (f) or (g) at different times to those listed in the column on the left, please list</u> (please read guidance note 5)</p>		
Sun					

I

Provision of facilities for making music Standard days and timings (please read guidance note 6)			<u>Please give a description of the facilities for making music you will be providing</u>	
			<u>Will the facilities for making music be indoors or outdoors or both – please tick</u> (please read guidance note 2)	
Day	Start	Finish	Indoors	<input type="checkbox"/>
			Outdoors	<input type="checkbox"/>
			Both	<input type="checkbox"/>
Mon			<u>Please give further details here</u> (please read guidance note 3)	
Tue				
Wed			<u>State any seasonal variations for the provision of facilities for making music</u> (please read guidance note 4)	
Thur				
Fri			<u>Non standard timings. Where you intend to use the premises for provision of facilities for making music at different times to those listed in the column on the left, please list</u> (please read guidance note 5)	
Sat				
Sun				

J

Provision of facilities for dancing Standard days and timings (please read guidance note 6)			<u>Will the facilities for dancing be indoors or outdoors or both – please tick</u> (see guidance note 2)	Indoors <input type="checkbox"/> Outdoors <input type="checkbox"/> Both <input type="checkbox"/>
			<u>Please give a description of the facilities for dancing you will be providing</u>	
Day	Start	Finish	<u>Please give further details here</u> (please read guidance note 3)	
Mon				
Tue				
Wed				
Thur				
Fri				
Sat				
Sun			<u>State any seasonal variations for providing dancing facilities</u> (please read guidance note 4)	
			<u>Non standard timings. Where you intend to use the premises for the provision of facilities for dancing entertainment at different times to those listed in the column on the left, please list</u> (please read guidance note 5)	

K

Provision of facilities for entertainment of a similar description to that falling within i or j Standard days and timings (please read guidance note 6)			<u>Please give a description of the type of entertainment facility you will be providing</u>		
Day	Start	Finish	Will the entertainment facility be indoors or outdoors or both – please tick (please read guidance note 2)	Indoors	<input type="checkbox"/>
Mon				Outdoors	<input type="checkbox"/>
				Both	<input type="checkbox"/>
Tue			Please give further details here (please read guidance note 3)		
Wed					
Thur			State any seasonal variations for the provision of facilities for entertainment of a similar description to that falling within i or j (please read guidance note 4)		
Fri					
Sat			Non standard timings. Where you intend to use the premises for the provision of facilities for entertainment of a similar description to that falling within i or j at different times to those listed in the column on the left, please list (please read guidance note 5)		
Sun					

L

Late night refreshment Standard days and timings (please read guidance note 6)			Will the provision of late night refreshment take place indoors or outdoors or both – please tick (please read guidance note 2)	Indoors	<input type="checkbox"/>
				Outdoors	<input type="checkbox"/>
				Both	<input type="checkbox"/>
Day	Start	Finish			
Mon			<u>Please give further details here</u> (please read guidance note 3)		
Tue					
Wed			<u>State any seasonal variations for the provision of late night refreshment</u> (please read guidance note 4)		
Thur					
Fri			<u>Non standard timings. Where you intend to use the premises for the provision of late night refreshment at different times, to those listed in the column on the left, please list</u> (please read guidance note 5)		
Sat					
Sun					

M

Supply of alcohol Standard days and timings (please read guidance note 6)			Will the supply of alcohol be for consumption (Please tick box) (please read guidance note 7)	On the premises	<input type="checkbox"/>
				Off the premises	<input checked="" type="checkbox"/>
				Both	<input type="checkbox"/>
Day	Start	Finish	State any seasonal variations for the supply of alcohol (please read guidance note 4) The premises shall be open for non-licensable activities without limit. (24 Hour)		
Mon	06:00	01:00			
Tue	06:00	01:00			
Wed	06:00	01:00			
Thur	06:00	01:00			
Fri	06:00	03:00			
Sat	06:00	03:00			
Sun	06:00	01:00			
			Non standard timings. Where you intend to use the premises for the supply of alcohol at different times to those listed in the column on the left, please list (please read guidance note 5) N/A		

State the name and details of the individual whom you wish to specify on the licence as premises supervisor

Name MURAT KILIC	
Address 47B WARNEFORD STREET LONDON	
Postcode	E9 7NG
Personal Licence number (if known) LBH-PER-N-0734	
Issuing licensing authority (if known) HACKNEY COUNCIL	

N

Please highlight any adult entertainment or services, activities, other entertainment or matters ancillary to the use of the premises that may give rise to concern in respect of children (please read guidance note 8)

None.

O

<p>Hours premises are open to the public Standard days and timings (please read guidance note 6)</p>			<p>State any seasonal variations (please read guidance note 4) The premises shall be open for non-licensable activities without limit.</p>
Day	Start	Finish	
Mon	00:00	00:00	<p>Non standard timings. Where you intend the premises to be open to the public at different times from those listed in the column on the left, please list (please read guidance note 5)</p>
Tue	00:00	00:00	
Wed	00:00	00:00	
Thur	00:00	00:00	
Fri	00:00	00:00	
Sat	00:00	00:00	
Sun	00:00	00:00	

P Describe the steps you intend to take to promote the four licensing objectives:

a) General – all four licensing objectives (b,c,d,e) (please read guidance note 9)

The Licensee, that is the person in whose name the premises licence is issued, shall ensure that all times when the premises are for any licensable activity, there are sufficient competent staff on duty at the premises for the purpose of fulfilling the terms and conditions of the licence and for preventing crime and disorder. The Licensee shall ensure that all staff will undertake training in their responsibilities in relation to the sale of alcohol, particularly with regard to drunkenness and underage persons. Records will be kept of training and refresher training.

b) The prevention of crime and disorder

The Licensee will install comprehensive CCTV coverage at the premises and it is operated and maintained at the premises.

The CCTV system shall conform to the following points:

1. Cameras must be sited to observe the entrance and exit doors both inside and outside.
2. Cameras on the entrances must capture full frame shots of the heads and shoulders of all people entering the premises i.e. capable of identification.
3. Cameras viewing till areas must capture frames not less than 50% of screen.
4. Cameras overlooking floor areas should be wide angled to give an overview of the premises.
5. Be capable of visually confirming the nature of the crime committed.
6. Provide a linked record of the date, time and place of any image.
7. Provide good quality images –colour during opening times.
8. Operate under existing light levels within and outside the premises.
9. Have the recording device located in a secure area or locked cabinet.
10. Have a monitor to review images and recorded picture quality.
11. Be regularly maintained to ensure continuous quality of image capture retention.
12. Have signage displayed in the customer area to advise that CCTV is in operation.
13. Digital images must be kept for 31 days.
14. Police will have access to images at any reasonable time.
15. The equipment must have a suitable export method, e. G. CD/DVD writer so that the police can make an evidential copy of the data they require. This data should be in the native file format, to ensure that no image quality is lost when making the copy, if this format is non-standard (i.e. manufacturer proprietary) then the manufacturer should supply the replay software to ensure that the video on the CD can be replayed by the police on a standard computer. Copies must be made available to Police on request.

c) Public safety

Appropriate fire safety procedures are in place including fire extinguishers (foam, H2O and CO2), fire blanket, internally illuminated fire exit signs, numerous smoke detectors and emergency lighting (see enclosed plan for details of locations). All appliances are inspected annually.

All emergency exits shall be kept free from obstruction at all times.

d) The prevention of public nuisance

All customers will be asked to leave quietly.

Clear and legible notices will be prominently displayed to remind customers to leave quietly and have regard to our neighbours.

e) The protection of children from harm

The licensee and staff will ask persons who appear to be under the age of 25 for photographic ID such as proof of age cards, the Connexions Card and Citizen Card, photographic driving licence or passport, an official identity card issued by HM Forces or by an EU country, bearing the photograph and date of birth of bearer.

The Challenge 25 logo and posters will be displayed at the premises.

All staff will be trained for UNDERAGE SALES PREVENTION regularly.

A register of refused sales shall be kept and maintained on the premises.

Please tick yes

- I have made or enclosed payment of the fee
- I have enclosed the plan of the premises
- I have sent copies of this application and the plan to responsible authorities and others where applicable
- I have enclosed the consent form completed by the individual I wish to be premises supervisor, if applicable
- I understand that I must now advertise my application
- I understand that if I do not comply with the above requirements my application will be rejected

IT IS AN OFFENCE, LIABLE ON CONVICTION TO A FINE UP TO LEVEL 5 ON THE STANDARD SCALE, UNDER SECTION 158 OF THE LICENSING ACT 2003 TO MAKE A FALSE STATEMENT IN OR IN CONNECTION WITH THIS APPLICATION

Part 4 – Signatures (please read guidance note 10)

Signature of applicant or applicant’s solicitor or other duly authorised agent (See guidance note 11). **If signing on behalf of the applicant please state in what capacity.**

Signature	
Date	22 nd July 2012
Capacity	Agent for the Applicant

For joint applications signature of 2nd applicant or 2nd applicant’s solicitor or other authorised agent. (please read guidance note 12). **If signing on behalf of the applicant please state in what capacity.**

Signature	
Date	
Capacity	

Contact name (where not previously given) and postal address for correspondence associated with this application (please read guidance note 13)

Jun Simon
 ADA GROUP
 167 STOKE NEWINGTON ROAD

Post town	LONDON	Post code	N16 8BP
------------------	--------	------------------	---------

Telephone number (if any)	0207 193 8393
----------------------------------	---------------

If you would prefer us to correspond with you by e-mail your e-mail address (optional)

<p>SCALE</p> <p>1:50</p> <p>1:100</p> <p>1:200</p> <p>1:500</p> <p>1:1000</p>	<p>CEILING</p> <p>DESK/REAR DESK</p> <p>REAR DESK</p> <p>TABLE/CHAIR</p> <p>RECEPTION/RECEPTION</p> <p>SALIENT/SLIP</p> <p>ARMCHAIR/CHAIR</p> <p>CHAIR</p> <p>CAPRIS/CHAIR</p> <p>OFFICE/CHAIR</p> <p>OFFICE/CHAIR</p> <p>OFFICE/CHAIR</p> <p>FIRE BRACKETS</p>	<p>AMENDMENTS</p> <p>A</p> <p>B</p>	<p>The contents of this plan including the printed notes are copyright and reproduction in whole or part is not permitted without prior consent of Amanda Jarry in writing.</p> <p>STAR FOOD & WINF 138 BALLS POND NI 4AD LONDON</p> <p>PROPOSE</p> <p>- GROUND FLOOR PLAN</p> <p>SCALE: 1:100 of A4 Date: 22.01.12</p> <p>ReCNo: AT-138-NI4AD-1</p>	<p>ACT 2003</p> <p>55 STOKES NEWINGTON HIGH STREET NI6 8LL</p> <p>Tel: 020 72413636 FAX: 08716615283</p> <p>www.act2003.com</p>
---	---	-------------------------------------	---	---

PROPOSE
- GROUND FLOOR PLAN

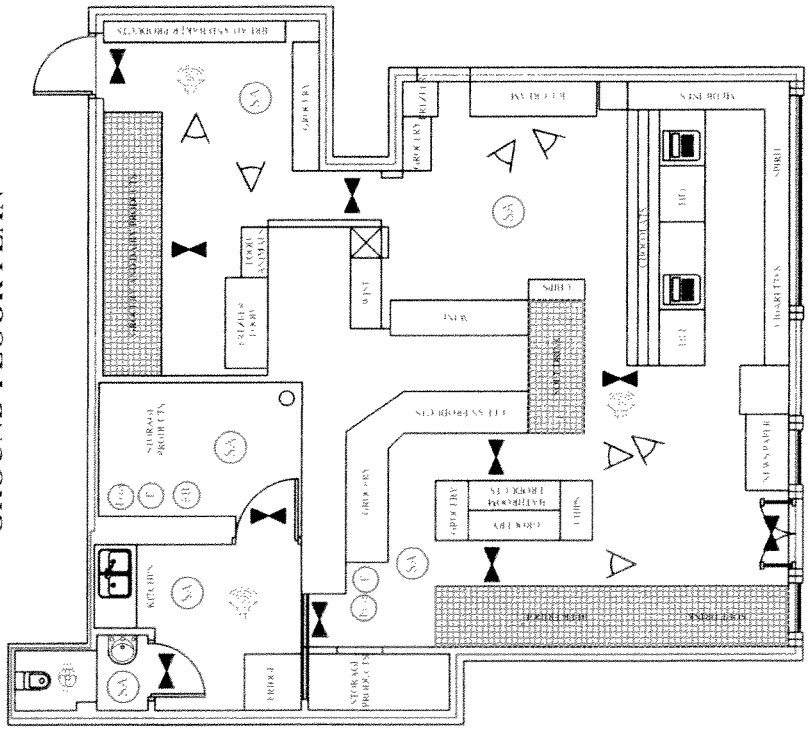



PREMISES LICENCE LICENSING ACT 2003

Premises licence number	LN/12003-070411		
Postal address of premises, or if none, ordnance survey map reference or description			
STAR SUPERMARKET 140 BALLS POND ROAD			
Post town	London	Post code	N1 4AD
Telephone number	0207 226 7332		

Where the licence is time limited the dates
Not Applicable

Licensable activities authorised by the licence
Ground floor only

- The sale by retail of alcohol

The times the licence authorises the carrying out of licensable activities

- The sale by retail of alcohol:

Monday	06:00	to	01:00	the following day
Tuesday	06:00	to	01:00	the following day
Wednesday	06:00	to	01:00	the following day
Thursday	06:00	to	01:00	the following day
Friday	06:00	to	01:00	the following day
Saturday	06:00	to	01:00	the following day
Sunday	06:00	to	01:00	the following day

Gaming Machine Provision:
Not permitted

The opening hours of the premises:

Monday	06:00	to	01:00	the following day
Tuesday	06:00	to	01:00	the following day
Wednesday	06:00	to	01:00	the following day
Thursday	06:00	to	01:00	the following day
Friday	06:00	to	01:00	the following day
Saturday	06:00	to	01:00	the following day
Sunday	06:00	to	01:00	the following day

Where the licence authorises supplies of alcohol whether these are on and/or off supplies
Off supplies

Name, (registered) address, telephone number and e-mail (where relevant) of holder of premises licence

Mr Gazi Kavruk
42 Westcliffe House
Boxter Road
London
N1 3HS
07879 883 008

Registered number of holder, for example company number, charity number (where applicable)

Name, address and telephone number of designated premises supervisor where the premises licence authorises the supply of alcohol

Mr Deval Shah
10 Sovereign Grove
Wembley
Middlesex
HA0 2DZ

Personal licence number and issuing authority of personal licence held by designated premises supervisor where the premises licence authorises the supply of alcohol

582116 L B Brent

Islington Council
Public Protection Division
222 Upper Street
London N1 1XR
Tel: 020 7527 3031
Email: licensing@islington.gov.uk

Service Manager (Commercial)

Date of Issue

Annex 1 - Mandatory conditions

1. No supply of alcohol may be made under the premises licence-
 - a) at a time when there is no designated premises supervisor in respect of the premises licence, or
 - b) at a time when the designated premises supervisor does not hold a personal licence or his personal licence is suspended.
2. Every supply of alcohol under the premises licence must be made or authorised by a person who holds a personal licence.

Annex 2 - Conditions consistent with the Operating Schedule

1. All staff shall be fully trained in relation to the sale of alcohol
2. CCTV system shall be installed and maintained inside the premises, including a CCTV unit, which monitors the immediate vicinity of the premises. All cameras shall continually record whilst the premises are open to the public and the video recordings shall be kept available for a minimum of 31 days with time and date stamping. Tape recordings shall be made available to an authorised officer or a police officer with 24 hours of any request.
3. The premises shall enforce a proof of age scheme in relation to the sale of alcohol.
4. No high strength alcohol products shall be sold at discount prices under this licence.
5. An incident and accident book shall be completed at the premises.
6. The premises shall not be used under the licence until the requirement specified in the schedule dated 22 December 2009 have been completed and approved in writing by the responsible authority for health and safety.

Annex 3 - Conditions attached after a hearing by the licensing authority

Annex 4 – Plans

Reference Number: **LN90544-090210**

Premises Licence Summary
Licensing Act 2003

Premises licence number LN/12003-070411

Premises details

Postal address of premises, or if none, ordnance survey map reference or description

STAR SUPERMARKET
140 BALLS POND ROAD

Post town	London	Post code	N1 4AD
------------------	--------	------------------	--------

Telephone number	0207 226 7332
-------------------------	---------------

Where the licence is time limited the dates

Not Applicable [

Licensable activities authorised by the licence

Ground floor only

- The sale by retail of alcohol

The times the licence authorises the carrying out of licensable activities

- The sale by retail of alcohol:

Monday	06:00	to	01:00	the following day
Tuesday	06:00	to	01:00	the following day
Wednesday	06:00	to	01:00	the following day
Thursday	06:00	to	01:00	the following day
Friday	06:00	to	01:00	the following day
Saturday	06:00	to	01:00	the following day
Sunday	06:00	to	01:00	the following day

Gaming Machine Provision:

Not permitted

The opening hours of the premises:

Monday	06:00	to	01:00	the following day
Tuesday	06:00	to	01:00	the following day
Wednesday	06:00	to	01:00	the following day
Thursday	06:00	to	01:00	the following day
Friday	06:00	to	01:00	the following day
Saturday	06:00	to	01:00	the following day
Sunday	06:00	to	01:00	the following day

Where the licence authorises supplies of alcohol whether these are on and/or off supplies

Off supplies

Name, (registered) address, telephone number and e-mail (where relevant) of holder of premises licence

Mr Gazi Kavruk
42 Westcliffe House
Boxter Road
London
N1 3HS
07879 883 008

Registered number of holder, for example company number, charity number (where applicable)

Name of designated premises supervisor where the premises licence authorises the supply of alcohol

Mr Deval Shah

State whether access to the premises by children is restricted or prohibited

No restrictions

Islington Council
Public Protection Division
222 Upper Street
London N1 1XR
Tel: 020 7527 3031
Email: licensing@islington.gov.uk



PREMISES LICENCE LICENSING ACT 2003

Premises licence number	LN/2177-031109		
Postal address of premises, or if none, ordnance survey map reference or description			
STAR OFF LICENCE 138 BALLS POND ROAD			
Post town	London	Post code	N1 4AD
Telephone number	020 7226 5237		

Where the licence is time limited the dates
Not Applicable

Licensable activities authorised by the licence [
Ground Floor
<ul style="list-style-type: none">The sale by retail of alcohol

The times the licence authorises the carrying out of licensable activities																												
<ul style="list-style-type: none">The sale by retail of alcohol: <table><tr><td>Monday</td><td>00:00</td><td>to</td><td>24:00</td></tr><tr><td>Tuesday</td><td>00:00</td><td>to</td><td>24:00</td></tr><tr><td>Wednesday</td><td>00:00</td><td>to</td><td>24:00</td></tr><tr><td>Thursday</td><td>00:00</td><td>to</td><td>24:00</td></tr><tr><td>Friday</td><td>00:00</td><td>to</td><td>24:00</td></tr><tr><td>Saturday</td><td>00:00</td><td>to</td><td>24:00</td></tr><tr><td>Sunday</td><td>00:00</td><td>to</td><td>24:00</td></tr></table>	Monday	00:00	to	24:00	Tuesday	00:00	to	24:00	Wednesday	00:00	to	24:00	Thursday	00:00	to	24:00	Friday	00:00	to	24:00	Saturday	00:00	to	24:00	Sunday	00:00	to	24:00
Monday	00:00	to	24:00																									
Tuesday	00:00	to	24:00																									
Wednesday	00:00	to	24:00																									
Thursday	00:00	to	24:00																									
Friday	00:00	to	24:00																									
Saturday	00:00	to	24:00																									
Sunday	00:00	to	24:00																									

The opening hours of the premises:																												
<table><tr><td>Monday</td><td>00:00</td><td>to</td><td>24:00</td></tr><tr><td>Tuesday</td><td>00:00</td><td>to</td><td>24:00</td></tr><tr><td>Wednesday</td><td>00:00</td><td>to</td><td>24:00</td></tr><tr><td>Thursday</td><td>00:00</td><td>to</td><td>24:00</td></tr><tr><td>Friday</td><td>00:00</td><td>to</td><td>24:00</td></tr><tr><td>Saturday</td><td>00:00</td><td>to</td><td>24:00</td></tr><tr><td>Sunday</td><td>00:00</td><td>to</td><td>24:00</td></tr></table>	Monday	00:00	to	24:00	Tuesday	00:00	to	24:00	Wednesday	00:00	to	24:00	Thursday	00:00	to	24:00	Friday	00:00	to	24:00	Saturday	00:00	to	24:00	Sunday	00:00	to	24:00
Monday	00:00	to	24:00																									
Tuesday	00:00	to	24:00																									
Wednesday	00:00	to	24:00																									
Thursday	00:00	to	24:00																									
Friday	00:00	to	24:00																									
Saturday	00:00	to	24:00																									
Sunday	00:00	to	24:00																									

Where the licence authorises supplies of alcohol whether these are on and/or off supplies
Off supplies

Name, (registered) address, telephone number and e-mail (where relevant) of holder of premises licence
Mr Gazi Kavruk 138 Balls Pond Road London N1 4AD

Registered number of holder, for example company number, charity number (where applicable)

Name, address and telephone number of designated premises supervisor where the premises licence authorises the supply of alcohol

Mr Gazi Kavruk
42 Westcliff House
1 Baxter Road
London
N1 3HS

Personal licence number and issuing authority of personal licence held by designated premises supervisor where the premises licence authorises the supply of alcohol

LB Islington - 150351

Islington Council
Public Protection Division
222 Upper Street
London
N1 1XR
Tel: 020 7527 3031
Email: licensing@islington.gov.uk

Service Director - Public Protection

Date of Issue

Annex 1 - Mandatory conditions

1. No supply of alcohol may be made under the premises licence-
 - a) at a time when there is no designated premises supervisor in respect of the premises licence, or
 - b) at a time when the designated premises supervisor does not hold a personal licence or his personal licence is suspended.
2. Every supply of alcohol under the premises licence must be made or authorised by a person who holds a personal licence.

Annex 2 - Conditions consistent with the Operating Schedule

1. The restrictions on hours during which the sale of alcohol is authorised does not prohibit:
 - a) during the first 20 minutes after the above hours, the taking of the alcohol from the premises, unless the alcohol is supplied or taken in an open vessel;
 - b) the ordering of alcohol to be consumed off the premises, or the despatch by the vendor of alcohol so ordered;
 - c) the sale of alcohol to a trader or club for the purposes of the trade or club;
 - d) the sale or supply of alcohol to any canteen or mess, being a canteen in which the sale or supply of alcohol is carried out under the authority of the Secretary of State or an authorised mess of members of Her Majesty's naval military.
2. Alcohol shall not be sold in an open container or be consumed in the licensed premises.
3. The Licensee shall promote 'Challenge 25' or similar scheme.
4. The licensee shall ensure that staff are trained about age restricted products and ensure that they sign to confirm that they have understood the training. The licensee shall keep records of training and instruction given to staff.
5. The licensee shall put arrangements in place to ensure that before serving alcohol to young persons, staff ask to see accredited proof of age cards e.g. Citizencard, a Passport, or UK Driving Licence bearing the photograph and date of birth of the bearer.
6. The licensee and staff should note any refusals to sell to young people in a refusals log.
7. The licensee should regularly monitor staff to check how they are dealing with young people who ask for alcohol and other age restricted products.
8. CCTV shall be installed, operated and maintained in agreement with the Police. The system will enable frontal identification of every person entering the premises. The system shall record in real time and operate whilst the premises are open for licensable activities. The recordings shall be kept available for a minimum of 31 days. Recordings shall be made available to an Authorised Officer or a Police Officer (subject to the Data Protection Act 1998) within 24 hours of any request.
9. In the absence of adequate daylight, the lighting in any area accessible to the public shall be fully in operation when they are present.
10. Noise or vibration must not emanate from the premises so as to cause a nuisance to nearby properties.
11. The premises license holder shall ensure that there is an effective policy in place to control sale or supply of alcoholic drinks to children under the age of 18 years. The policy must require the production of a "proof of age" before such sales are made. The proof of age required/ acceptable (such as "proof of age" cards such as PASS (Proof of Age Standards Scheme) cards, photo driving licences, or passports) should be clearly set out in the policy.

Annex 3 - Conditions attached after a hearing by the licensing authority

Annex 4 – Plans

Reference Number: 2177-031109-Plan

Premises Licence Summary

Licensing Act 2003

Premises licence number	LN/2177-031109		
Postal address of premises, or if none, ordnance survey map reference or description			
STAR OFF LICENCE 138 BALLS POND ROAD			
Post town	London	Post code	N1 4AD
Telephone number	020 7226 5237		

Where the licence is time limited the dates
Not Applicable

Licensable activities authorised by the licence [
Ground Floor
<ul style="list-style-type: none">The sale by retail of alcohol

The times the licence authorises the carrying out of licensable activities																												
<ul style="list-style-type: none">The sale by retail of alcohol: <table><tr><td>Monday</td><td>00:00</td><td>to</td><td>24:00</td></tr><tr><td>Tuesday</td><td>00:00</td><td>to</td><td>24:00</td></tr><tr><td>Wednesday</td><td>00:00</td><td>to</td><td>24:00</td></tr><tr><td>Thursday</td><td>00:00</td><td>to</td><td>24:00</td></tr><tr><td>Friday</td><td>00:00</td><td>to</td><td>24:00</td></tr><tr><td>Saturday</td><td>00:00</td><td>to</td><td>24:00</td></tr><tr><td>Sunday</td><td>00:00</td><td>to</td><td>24:00</td></tr></table>	Monday	00:00	to	24:00	Tuesday	00:00	to	24:00	Wednesday	00:00	to	24:00	Thursday	00:00	to	24:00	Friday	00:00	to	24:00	Saturday	00:00	to	24:00	Sunday	00:00	to	24:00
Monday	00:00	to	24:00																									
Tuesday	00:00	to	24:00																									
Wednesday	00:00	to	24:00																									
Thursday	00:00	to	24:00																									
Friday	00:00	to	24:00																									
Saturday	00:00	to	24:00																									
Sunday	00:00	to	24:00																									

The opening hours of the premises:			
Monday	00:00	to	24:00
Tuesday	00:00	to	24:00
Wednesday	00:00	to	24:00
Thursday	00:00	to	24:00
Friday	00:00	to	24:00
Saturday	00:00	to	24:00
Sunday	00:00	to	24:00

Where the licence authorises supplies of alcohol whether these are on and/or off supplies
Off supplies

Name, (registered) address, telephone number and e-mail (where relevant) of holder of premises licence
Mr Gazi Kavruk 138 Balls Pond Road London N1 4AD

Registered number of holder, for example company number, charity number (where applicable)

Name of designated premises supervisor where the premises licence authorises the supply of alcohol

Mr Gazi Kavruk

State whether access to the premises by children is restricted or prohibited

No restrictions

Islington Council
Public Protection Division
222 Upper Street
London
N1 1XR
Tel: 020 7527 3031
Email: licensing@islington.gov.uk



Building Control Service
Planning and Development
222 Upper Street
London
N1 1XR

T 020 7527 5986
F 020 7527 5998
E geoff.weaver@islington.gov.uk
W www.islington.gov.uk

Our ref : GW
Your ref:

Date: 7 August 2012

Jun Simon
ADA Group
167 Stoke Newington Road
London
N16 8BP

Dear Sirs

**Licensing Act 2003
Representation from Responsible Authority for Health and Public Safety
Star Food & Wine 138 – 140 Balls Pond Road N1 4AD**

With reference to the recent application for a premises licence under the Licensing Act 2003 at the above named premises, as the health and safety consultant for the responsible authority for health and public safety I will be making a representation to this application.

At a survey of the premises on 27 July 2012 it was found that the requirements specified in the attached schedule are in need of urgent attention to ensure the existing arrangements at the premises are adequate for health and public safety.

The premises should be maintained in good condition. Staff should be trained in the health and safety measures applicable to the premises and the action to be taken in the event of an emergency or evacuation. Enclosed for the attention of the licensee are **Health and Safety Standards for Places of Assembly, Shops and Commercial Premises**.

This communication is without prejudice to the necessity of complying with any other statutory controls which may be applicable, whether administered by the council or by any other authority.

Please give notification of the commencement and completion of the works.

Should you require any advice or information please contact me at the above address.

Yours faithfully

Geoff Weaver
Senior Building Surveyor (Licensing Health and Safety)

**Islington Licensing Authority
Licensing Act 2003**

Representation form from Responsible Authority for Health and Public Safety

Name	Geoff Weaver
Job title	Senior Building Surveyor (Licensing Health and Safety)
Postal address	Islington Council, Building Control Service 222 Upper Street, London N1 1XR
email	geoff.weaver@islington.gov.uk
Contact telephone number	020 7527 5986
Name and address of the premises concerning the representation	Star Food & Wine 138 – 140 Balls Pond Road N1 4AD
Public Safety	The arrangements at the premises are insufficient for health and public safety. See attached requirements schedule.
Suggested conditions that could be added to the licence to remedy the public safety representation	The premises shall not be used under the licence until the requirements specified in the schedule dated 7 August 2012 have been completed and approved in writing by the responsible authority for health and public safety.

Signed: _____ Date: _____

Please return this form along with any additional sheets to: Applicant and Islington Council, Licensing Team, 222 Upper Street, London N1 1XR or email to licensing@islington.gov.uk This form must be returned within the statutory period. For more details please check with the Licensing Support Team on 020 7527 3031.

**Licensing Act 2003 – Requirements schedule dated 7 August 2012 for
Star Food & Wine 138 – 140 Balls Pond Road N1 4AD**

- (1) The existing emergency lighting luminaires in all areas of the premises should be inspected and tested to ensure that each luminaire is wired to the local lighting circuit in such a manner as to operate not only in the event of failure of the mains supply but also on failure of the supply to the local lighting circuit.
- (2) Mains operated smoke and heat alarms with a standby power supply such as a rechargeable or replaceable battery or capacitor in accordance with BS 5839 – 6 should be provided in the areas of the premises including the basement.

Smoke alarms should be sited so that no point is further than 7.5m from the nearest smoke alarm. Heat alarms should be sited so that no point is further than 5.3m from the nearest heat alarm. Smoke and heat alarms should not be mounted within 500mm of any walls or obstructions.

Smoke and heat alarms should be interlinked so that detection of smoke or heat by one unit operates the alarm signal in all of them. Smoke and heat alarms should be wired in compliance with BS 7671 to a single independent circuit at the main distribution board. The circuit should be clearly labelled **Fire Alarm do not isolate**.

- (3) The living accommodation stairway and the passageway to the final exit should be enclosed and protected from all areas of the shop with 60 minute fire resisting construction.
- (4) One water or foam fire extinguisher (rating 13A) and one carbon dioxide fire extinguisher (rating 34B) should be provided behind or adjacent to the cashiers/sales counter.

Fire extinguishers should be on brackets or stands and located so as not to obstruct exit routes or cause a hazard to persons in and about the premises.

Appropriate signs should be fixed adjacent to the fire extinguishers indicating the type of fire fighting appliance and the class of fire covered.

- (5) Copies of the inspection and test certificates specified below, certified by an approved competent person, should be submitted to the responsible authority for health and public safety.

Electrical installation for the smoke/heat alarm system
Emergency lighting
Fire fighting appliances

Note: Approved competent persons for certification are specified in the attached document **Health and Safety Standards for Places of Assembly, Shops and Commercial Premises**.



ISLINGTON

PUBLIC PROTECTION DIVISION

Trading Standards
222 Upper Street
London N1 1XR

Tel: x 3874
E-mail: doug.love@islington.gov.uk

Please reply to: Doug Love

MEMO TO:

**LICENSING TEAM
222 UPPER STREET**

Our Ref:
Your Ref:
Date: 10/08/12

LICENSING ACT 2003: REPRESENTATIONS BY RESPONSIBLE AUTHORITY

Star Food & Wine, 138-140 Ball's Pond Road, N1 4AD

I have examined the application for a licence for the above premises on behalf of the Trading Standards Section and I have also met with Gazi Kavruk who effectively owns the business. I understand that Murat Kilic, the applicant, is Mr Kavruk's cousin and works in the shop. I wish to make the following representations.

1. Enforcement action

1.1 On July 6th 2012, I visited the premises with an HMRC officer, to undertake an inspection of their stock of alcohol and tobacco. The following items were identified as illicit and seized by the HMRC officer:

- 9 x 70cl Famous Grouse whisky
- 3 x 70cl High Commissioner whisky
- 4 x 70cl of Harry House
- 9 x 70cl Vladivar vodka
- 4 x 70cl Nicolaij vodka
- 1 x 70cl Stolichnaya vodka
- 1 x 70cl Moskovskaya vodka
- 1 x 70cl Soplca vodka
- 24 bottles of cheap Italian wine
- 2 bottles of counterfeit Jacob's Creek wine

1.2 At a subsequent PACE interview, Mr Kavruk stated that:

- the business was owned by F. O. R. Ltd (a subsequent Companies' House check reveals that this company was, in fact, dissolved in October 2010)
- the Italian wines came as transferred stock when he bought the shop at 140 over a few months previously
- he was unsure where the spirits came from, but he says that he never buys from anywhere other than cash and carry businesses. It is possible that they came also as transferred stock when he bought either 138 or 140 – he stated that there were some spirits that came with both shops when he bought them.
- he had learnt a lot during and after the seizure about how to identify illicit goods. He was sent guidance in March and December 2011 which he cannot remember much about – he says he usually gets his English speaking son to interpret for him. He was pleased to receive the Turkish language summary advice that Trading Standards have produced.

1.3 There have been no sales to volunteer test purchasers recorded.

2. Trading Standards' concerns

- 2.1. The seizure of the alcohol is clearly information that needs to be known by the Licensing Sub-Committee (LS-C). The applicant, although legally responsible for the licensable activities in the shop, will be an employee of Mr Kavruk, so it is important that the LS-C are satisfied that he will have the authority as well as the ability and desire to ensure that the Licensing Objectives are promoted.
- 2.2. The legal ownership of the business seems a little confused.

3. Proposed steps to prevent crime and disorder and to promote the protection of children from harm

- 3.1. I note that the application proposes conditions including those that Trading Standards regularly ask for. I would just ask that the ninth proposed condition is replaced with the slightly updated wording that is in current use:
 - The licensee shall ensure that staff are trained about age restricted products and ensure that they sign to confirm that they have understood the training. The training shall include the assessment of age; making a challenge; acceptable proof of age; and recording refusals. The licensee shall keep records of training and instruction given to staff.
- 3.2. I believe that the LS-C should hear this application, because of the recent seizure for which, in other circumstances, may have led to Trading Standards applying for a review of the premises licence.

4. Conclusion

- 4.1 If the LS-C is convinced by the evidence presented by the applicant that he has the ability, desire and authority to manage the premises to a high standard, I believe the licence should be granted.

I believe these representations are specific and proportionate to the known trading characteristics of this retail sector and are consistent with the Islington Council Statement of Licensing Policies 28, 32 and 39.

Doug Love
Principal Consumer Services Officer

Licensing Act 2003- Representation from the Licensing Authority
Application: STAR FOOD AND WINE 138-140 BALLS POND ROAD LONDON N1

I am submitting a representation on behalf of the Licensing Authority against a new application for a Premises Licence to permit the sale of alcohol for consumption off the premises on:

- Sun to Thurs 1am
- Fri and Sat 3am

The information and recommendations contained in this representation is consistent with the Licensing Policy Statement for 2011-2014 which was agreed by Council in December 2010 following full public consultation.

The grounds for the representation are:

- Public nuisance
- Crime and disorder

The Licensing Authority is concerned that if this application is granted it will increase the availability of alcohol for consumption late at night which could lead to an increase in public nuisance, crime and disorder.

The premises, which is in Mildmay Ward on the boundary with Canonbury Ward, is located on a busy main road and surrounded by residential premises.

There are 48 licensed to sell alcohol in Mildmay Ward and of these

- 20 premises are licensed for off sales of alcohol
- 2 premises in Newington Green have 24 hour licences

The closing times of the nearest off licences to Star Food and Wine are:

UK Supermarket	95 Grosvenor Ave	8am to 11pm Mon to Sat, 10am to 10.30pm Sun
Grosvenor Wine	89 Grosvenor Avenue, Islington, N5 2NL	8am to 11pm Mon to Sat, 10am to 10.30pm Sun
Express Super Save	130 Ball's Pond Road, N1 4AD	8am to 11pm Mon to Sat, 10am to 10.30pm Sun
Sapna News	55 King Henry's Walk, Islington, N1 4NH	8am to 11pm Mon to Sat, 10am to 10.30pm Sun
Emek Supermarket	Mildmay Court, 44 Mildmay Park, N1 4PR	8am to 11pm Mon to Sat, 10am to 10.30pm Sun
Jays Newsagent	74 Ball's Pond Road, Islington, N1 4AJ	8am to 11pm Mon to Sat, 10am to 10.30pm Sun
Ruby's News	140 Ball's Pond Road, Islington, N1 4AD	6am to 1am Mon to Sun

From the above it can be seen that the area already has sufficient licensed premises to cater for the demands of local residents and any additional outlets supplying alcohol beyond 11pm day will be detrimental to the local residents in terms of noise and disturbance in the early hours of the morning.

The Licensing Authority fully supports any representations for the Police and is committed to supporting the Reclaim the Night programme of activities to reduce the incidence of alcohol related crime through reducing access to alcohol late at night.

In determining this application the Licensing Committee should be mindful of:

Licensing Policy 22 – *‘Where relevant representations are received the Licensing Authority may restrict the operational hours of the premises where this is necessary to promote the licensing objectives.’*

This application will not enhance the development of a thriving and safe night time economy in the area nor is there any evidence to suggest that in this case stricter licence conditions to control disturbances to residents will provide adequate control.

Licensing Policy 23 – *‘... the type of premises and their cumulative impact upon the area*

Licensing Policy paragraph 109 in which the Licensing Authority expresses its concern over the increasing number of licensed shops selling alcohol for consumption off the premises and advises that it will ‘...consider restricting the hour in locations where longer hours are not considered appropriate because of the nature of the area or where representations are received...’..’

In view of the number of off licences already operating in the area the Licensing Authority is of the opinion that the area has reached saturation point and any more off licences will result in a negative cumulative impact on the public nuisance and crime and disorder licensing objectives.

Licensing Authority recommends that the application for a licence from 6am until 1am Thurs to Sundays and 3am Friday and Saturday is refused.

If, having considered all the evidence, the committee is minded to grant a licence it is recommended that the licensing hours be restricted to 8am to 11pm Mon to Sat, 10am to 10.30pm Sun which is consistent with all the other off licences operating in the immediate area, with the exception of the neighbouring premises. This approach would contribute to promoting the licensing objectives by minimising any adverse impacts to residents beyond 11pm.

Janice Gibbons
Service Manager
Islington Council
Public Protection Division
222 Upper St
London N1 1XR

15 August 2012

Suggested conditions of approval consistent with the operating schedule

1. The Licensee, that is the person in whose name the premises licence is issued, shall ensure that all times when the premises are for any licensable activity, there are sufficient competent staff on duty at the premises for the purpose of fulfilling the terms and conditions of the licence and preventing crime and disorder. The Licensee shall ensure that all staff will undertake training in their responsibilities in relation to the sale of alcohol, particularly with regard to drunkenness and underage persons. Records will be kept of training and refresher training.
2. The Licensee will install comprehensive CCTV coverage at the premises and it is operated and maintained at the premises.
3. The CCTV system shall conform to the following points:
 - Cameras must be cited to observe the entrance and exit doors both inside and out
 - Cameras on the entrances must capture full frame shots of the head and shoulders of all people entering the premises i.e. capable of identification.
 - Cameras viewing till areas must capture frames not less than 50% of screen.
 - Cameras overlooking floor areas should be wide angled to give an overview of the premises.
 - Be capable of visually confirming the nature of the crime committed.
 - Provide a linked record of the date, time and place of any image.
 - Provide good quality images – colour during opening times.
 - Operate under existing light levels within and outside the premises.
 - Have the recording device located in a secure area or locked cabinet.
 - Have a monitor to review images and record picture quality.
 - Be regularly maintained to ensure continuous quality of image capture retention.
 - Have signage displayed in the customer to advise that CCTV is in operation.
 - Digital images must be kept for 31 days.
 - Police will have access to images at any reasonable time.
 - The equipment must have a suitable export method, e.g CD/DVD writer so that the police can make an evidential copy of the data they require. This data should be in the native file format, to ensure that no image quality is lost when making a copy. If the format is non-standard (i.e. manufacturer proprietary) then the manufacturer should supply the replay software to ensure that the video on the CD can be replayed by the police on a standard computer. Copies must be made available to Police on request.
4. Appropriate fire safety procedures are in place including fire extinguishers (foam, H2O and CO2), fire blanket, internally illuminated fire exit signs, numerous smoke detectors and emergency lighting (see enclosed plan for detail of locations). All appliances are inspected annually. All emergency exits shall be kept free from obstruction at all times.
5. All customers will be asked to leave quietly.
6. Clear and legible notices will be prominently displayed to remind customers to leave quietly and have regard to our neighbours.
7. The licensee and staff will ask persons who appear to be under the age of 25 for photographic ID such as proof of age cards, the Connexions Card and Citizen Card, photographic driving licence or passport, an official identity card issued by HM Forces or by an EU country, bearing the photograph and date of birth of bearer.
8. The Challenge 25 logo and posters will be displayed at the premises

9. All staff will be trained for UNDERAGE SALES PREVENTION regularly.
10. A register of refused sales shall be kept and maintained on the premises.

Suggested conditions of approval recommended by Health and Safety Officer

11. The premises shall not be used under the licence until the requirements specified in the schedule dated 7 August 2012 have been completed and approved in writing by the responsible authority for health and public safety.

Suggested conditions of approval recommended by Trading Standards

12. The licensee shall ensure that staff are trained about age restricted products and ensure that they sign to confirm that they have understood the training. The training shall include the assessment of age; making a challenge; acceptable proof of age; and recording refusals. The licensee shall keep records of training and instruction given to staff.

