



Report of: **Service Director, Public Protection**

Meeting of	Date	Agenda Item	Ward(s)
Licensing Sub-Committee	31 May 2012		Bunhill

Delete as appropriate	Exempt	Non-exempt
-----------------------	--------	------------

Subject: PREMISES LICENCE NEW APPLICATION
Basil, 156 Whitecross Street, London EC1Y 8JL

1. Synopsis

- 1.1 This is an application for a new premise licence under the Licensing Act 2003.
- 1.2 The new application is to allow the sale of alcohol between 12 midday and 11pm, Mondays to Sundays, for consumption on the premises.

2. Recommendations

- 2.1 To determine the application for a new premises licence under Section 17 of the Licensing Act 2003.
- 2.2 If the Committee grants the application it should be subject to:
 - i. conditions prepared by the Licensing Officer which are consistent with the Operating Schedule (See appendix 3);
 - ii. conditions recommended by responsible Authorities (see appendix 3);
 - iii. any conditions deemed necessary by the Committee to promote the four licensing objectives.

3. Background

3.1 Papers are attached as follows:-

- Appendix 1: application form;
- Appendix 2a: name & address details of those persons making representations;
- Appendix 2: representations;
- Appendix 3: suggested conditions, map of premise location, photograph of premises.

3.2 Representations were received by way of letters from a local resident and Islington's Health and Safety officer and a petition signed by 34 local residents submitted by the Whitecross Estate TRA.

4. Planning Implications

4.1 The Planning Team have confirmed that the premises has A1 retail use, which allows the premises to operate as a café. There are no restrictions on the hours of use.

5. Conclusion and reasons for recommendations

5.1 The Council is required to consider this application in the light of all relevant information, and if approval is given, it may attach such conditions necessary to promote the licensing objectives.

Background papers:

- The Council's Statement of Licensing Policy
- Licensing Act 2003
- Secretary of States Guidance

Final Report Clearance

Signed by

 Service Director - Public Protection

Date 21/5/12

Received by

Head of Scrutiny and Democratic Services

Date

Report author: Simon Gallacher

Tel: 020 7527 3879

E-mail: simon.gallacher@islington.gov.uk



**APPLICATION FOR A PREMISES LICENCE TO BE GRANTED
UNDER THE LICENSING ACT 2003**

PLEASE READ THE FOLLOWING INSTRUCTIONS FIRST

Before completing this form please read the guidance notes at the end of the form. If you are completing this form by hand please write legibly in block capitals. In all cases ensure that your answers are inside the boxes and written in black ink. Use additional sheets if necessary.

You may wish to keep a copy of the completed form for your records.

FUTUREFOOD 3000 LTD.

I/We ~~LORENZO ANONICA / MARS TRADING CO SA~~
(Insert name(s) of applicant)

apply for a premises licence under section 17 of the Licensing Act 2003 for the premises described in Part 1 below (the premises) and I/we are making this application to you as the relevant licensing authority in accordance with section 12 of the Licensing Act 2003

Part 1 – Premises Details

Postal address of premises or, if none, ordnance survey map reference or description	
BASH GROUND FLOOR 156 WHITE CROSS STREET	
Post town	LONDON
Post code	EC1V 8JL*

Telephone number at premises (if any)	07946 198940
Non-domestic rateable value of premises	£ 10,000

ISLINGTON COUNCIL LICENSING	
Date	09/03/12
Fee Paid	190.00
Method of payment	Cash
Receipt Number	53339
Received By	YQZ

Part 2 - Applicant Details

Please state whether you are applying for a premises licence as
Please tick yes

- a) an individual or individuals * please complete section (A)
- b) a person other than an individual *
i. as a limited company please complete section (B)
ii. as a partnership please complete section (B)
iii. as an unincorporated association or please complete section (B)
iv. other (for example a statutory corporation) please complete section (B)
- c) a recognised club please complete section (B)
- d) a charity please complete section (B)
- e) the proprietor of an educational establishment please complete section (B)
- f) a health service body please complete section (B)
- g) a person who is registered under Part 2 of the Care Standards Act 2000 (c14) in respect of an independent hospital please complete section (B)
- h) the chief officer of police of a police force in England and Wales please complete section (B)

* If you are applying as a person described in (a) or (b) please confirm:

- Please tick yes
- I am carrying on or proposing to carry on a business which involves the use of the premises for licensable activities; or
 - I am making the application pursuant to a
 - statutory function or
 - a function discharged by virtue of Her Majesty's prerogative

(A) INDIVIDUAL APPLICANTS (fill in as applicable)

Mr <input type="checkbox"/>	Mrs <input type="checkbox"/>	Miss <input type="checkbox"/>	Ms <input type="checkbox"/>	Other Title (for example, Rev)	
Surname			First names		
I am 18 years old or over					<input type="checkbox"/> Please tick yes
Current postal address if different from premises address					
Post Town				Postcode	
Daytime contact telephone number					
E-mail address (optional)					

SECOND INDIVIDUAL APPLICANT (if applicable)

Mr <input type="checkbox"/>	Mrs <input type="checkbox"/>	Miss <input type="checkbox"/>	Ms <input type="checkbox"/>	Other Title (for example, Rev)	
Surname			First names		
I am 18 years old or over					<input type="checkbox"/> Please tick yes
Current postal address if different from premises address					
Post Town				Postcode	
Daytime contact telephone number					
E-mail address (optional)					

(B) OTHER APPLICANTS

Please provide name and registered address of applicant in full. Where appropriate please give any registered number. In the case of a partnership or other joint venture (other than a body corporate), please give the name and address of each party concerned.

Name	XXXXXXXXXX FUTUREFOOD 3000 LTD
Address	GROUND FLOOR 156 WHITECROSS STREET LONDON XXXXXXXXXX EC1Y8JL
Registered number (where applicable)	7890544
Description of applicant (for example, partnership, company, unincorporated association etc.)	FUTURE FOOD 3000 LTD
Telephone number (if any)	07946 198940
E-mail address (optional)	FUTUREFOOD3000@HOTMAIL.COM

Part 3 Operating Schedule

When do you want the premises licence to start?

Day	Month	Year
01	04	2012

If you wish the licence to be valid only for a limited period, when do you want it to end?

Day	Month	Year

Please give a general description of the premises (please read guidance note 1)

A1 CAFE DELICATESSEN

If 5,000 or more people are expected to attend the premises at any one time, please state the number expected to attend.

What licensable activities do you intend to carry on from the premises?
(Please see sections 1 and 14 of the Licensing Act 2003 and Schedules 1 and 2 to the Licensing Act 2003)

Provision of regulated entertainment

Please tick yes

- a) plays (if ticking yes, fill in box A)
- b) films (if ticking yes, fill in box B)
- c) indoor sporting events (if ticking yes, fill in box C)
- d) boxing or wrestling entertainment (if ticking yes, fill in box D)
- e) live music (if ticking yes, fill in box E)
- f) recorded music (if ticking yes, fill in box F)
- g) performances of dance (if ticking yes, fill in box G)
- h) anything of a similar description to that falling within (e), (f) or (g) (if ticking yes, fill in box H)

Provision of entertainment facilities:

- i) making music (if ticking yes, fill in box I)
- j) dancing (if ticking yes, fill in box J)
- k) entertainment of a similar description to that falling within (i) or (j) (if ticking yes, fill in box K)

Provision of late night refreshment (if ticking yes, fill in box L)

Supply of alcohol (if ticking yes, fill in box M)

In all cases complete boxes N, O and P

A

Plays Standard days and timings (please read guidance note 6)			Will the performance of a play take place indoors or outdoors or both – please tick (please read guidance note 2)	Indoors	<input type="checkbox"/>
				Outdoors	<input type="checkbox"/>
				Both	<input type="checkbox"/>
Day	Start	Finish	Please give further details here (please read guidance note 3)		
Mon					
Tue			State any seasonal variations for performing plays (please read guidance note 4)		
Wed					
Thur			Non standard timings. Where you intend to use the premises for the performance of plays at different times to those listed in the column on the left, please list (please read guidance note 5)		
Fri					
Sat					
Sun					

L

Late night refreshment Standard days and timings (please read guidance note 6)			Will the provision of late night refreshment take place indoors or outdoors or both – please tick (please read guidance note 2)	Indoors	<input type="checkbox"/>
				Outdoors	<input type="checkbox"/>
				Both	<input type="checkbox"/>
Day	Start	Finish	Please give further details here (please read guidance note 3)		
Mon					
Tue			State any seasonal variations for the provision of late night refreshment (please read guidance note 4)		
Wed					
Thur			Non standard timings. Where you intend to use the premises for the provision of late night refreshment at different times, to those listed in the column on the left, please list (please read guidance note 5)		
Fri					
Sat					
Sun					

M

Supply of alcohol Standard days and timings (please read guidance note 6)			Will the supply of alcohol be for consumption (Please tick box) (please read guidance note 7)	On the premises <input checked="" type="checkbox"/>
				Off the premises <input type="checkbox"/>
				Both <input type="checkbox"/>
Day	Start	Finish	State any seasonal variations for the supply of alcohol (please read guidance note 4)	
Mon	12:00	23:00		
Tue	12:00	23:00		
Wed	12:00	23:00		
Thur	12:00	23:00		
Fri	12:00	23:00		
Sat	12:00	23:00		
Sun	12:00	23:00		
			Non standard timings. Where you intend to use the premises for the supply of alcohol at different times to those listed in the column on the left, please list (please read guidance note 5)	

State the name and details of the individual whom you wish to specify on the licence as premises supervisor

Name	LORENZO CANONICA
Address	100-1000
Postcode	
Personal Licence number (if known)	02227
Issuing licensing authority (if known)	LAMBETH

Personal licence
seen by Yesim Senel
09/03/12

N

Please highlight any adult entertainment or services, activities, other entertainment or matters ancillary to the use of the premises that may give rise to concern in respect of children (please read guidance note 8)

O

Hours premises are open to the public			State any seasonal variations (please read guidance note 4)
Standard days and timings (please read guidance note 6)			
Day	Start	Finish	
Mon	12:00	23:00	
Tue	12:00	23:00	
Wed	12:00	23:00	
Thur	12:00	23:00	Non standard timings. Where you intend the premises to be open to the public at different times from those listed in the column on the left, please list (please read guidance note 5)
Fri	12:00	23:00	
Sat	12:00	23:00	
Sun	12:00	23:00	

P

Describe the steps you intend to take to promote the four licensing objectives:

a) General – all four licensing objectives (b,c,d,e) (please read guidance note 9)

SEE BELOW

b) The prevention of crime and disorder

INSTALLATION CCTV
REFUSING DRUNK AND DISORDERLY CUSTOMER

c) Public safety

INSTALLATION CCTV
ASK TO THE PEOPLE TO STAY OUTSIDE OF
THE PREMISES AS LAW REQUIRED.
FOLLOW FIRE BRIGADE STANDARD FOR SAFETY.

d) The prevention of public nuisance

ASK PEOPLE TO LEAVE THE PREMISES QUIETLY
DON'T LET CUSTOMER TAKE DRINKS OUTSIDE
AND STAY QUIETLY.

e) The protection of children from harm

ASK FOR ID OF CUSTOMER THAT LOOKS UNDER ~~AGE~~
THE AGE OF 25 AS CHALLENGE REQUIRED

Please tick yes

- I have made or enclosed payment of the fee
- I have enclosed the plan of the premises
- I have sent copies of this application and the plan to responsible authorities and others where applicable
- I have enclosed the consent form completed by the individual I wish to be premises supervisor, if applicable
- I understand that I must now advertise my application
- I understand that if I do not comply with the above requirements my application will be rejected

IT IS AN OFFENCE, LIABLE ON CONVICTION TO A FINE UP TO LEVEL 5 ON THE STANDARD SCALE, UNDER SECTION 158 OF THE LICENSING ACT 2003 TO MAKE A FALSE STATEMENT IN OR IN CONNECTION WITH THIS APPLICATION

Part 4 – Signatures (please read guidance note 10)

Signature of applicant or applicant's solicitor or other duly authorised agent (**See guidance note 11**). If signing on behalf of the applicant please state in what capacity.

Signature	<i>Joan Carver</i>
Date	<i>9/03/2012</i>
Capacity	<i>DIRECTOR</i>

For joint applications signature of 2nd applicant or 2nd applicant's solicitor or other authorised agent. (please read guidance note 12). If signing on behalf of the applicant please state in what capacity.

Signature	
Date	
Capacity	

Contact name (where not previously given) and postal address for correspondence associated with this application (please read guidance note 13)

FUTURE FOOD 3000 LTD
LORENZO CALONICA

Post town		Post code	
Telephone number (if any)	<i>07946198940</i>		
If you would prefer us to correspond with you by e-mail your e-mail address (optional)			

Notes for Guidance

1. Describe the premises. For example the type of premises, its general situation and layout and any other information which could be relevant to the licensing objectives. Where your application includes off-supplies of alcohol and you intend to provide a place for consumption of these off-supplies you must include a description of where the place will be and its proximity to the premises.
2. Where taking place in a building or other structure please tick as appropriate. Indoors may include a tent.
3. For example the type of activity to be authorised, if not already stated, and give relevant further details, for example (but not exclusively) whether or not music will be amplified or unamplified.
4. For example (but not exclusively), where the activity will occur on additional days during the summer months.
5. For example (but not exclusively), where you wish the activity to go on longer on a particular day e.g. Christmas Eve.
6. Please give timings in 24 hour clock (e.g. 16:00) and only give details for the days of the week when you intend the premises to be used for the activity.
7. If you wish people to be able to consume alcohol on the premises please tick on, if you wish people to be able to purchase alcohol to consume away from the premises please tick off. If you wish people to be able to do both please tick both.
8. Please give information about anything intended to occur at the premises or ancillary to the use of the premises which may give rise to concern in respect of children, regardless of whether you intend children to have access to the premises, for example (but not exclusively) nudity or semi-nudity, films for restricted age groups, the presence of gaming machines.
9. Please list here steps you will take to promote all four licensing objectives together.
10. The application form must be signed.
11. An applicant's agent (for example solicitor) may sign the form on their behalf provided that they have actual authority to do so.
12. Where there is more than one applicant, both applicants or their respective agents must sign the application form.
13. This is the address which we shall use to correspond with you about this application.

Gallacher, Simon

From: Gallacher, Simon
Sent: 04 April 2012 14:13
To: Nash, Rosemary
Subject: FW: Ligor Premises Licence Application: Future Food 3000 Ltd. 'Basil', 156 Whitecross Street, London EC1Y 8QN.

-----Original Message-----

From: (om]
Sent: 04 April 2012 11:49
To: Gallacher, Simon
Subject: Re: Ligor Premises Licence Application: Future Food 3000 Ltd. 'Basil', 156 Whitecross Street, London EC1Y 8QN.

Dear Mr Gallagher,

Thank you for the information.
Please use our letter of objection as follows:

We write to formally oppose the application on these grounds:

- a) Whitecross Street is predominantly a residential area.
- b) There are already many more licenced premises in and around Whitecross Street than are necessary.
- c) Those existing licenced operations continue to be a predictably constant source of alarming noise and disturbance in the evenings and particularly at night, both during the week and at weekends.
- d) Environmental and health issues include, unpleasant behaviour, broken bottles, glasses, discarded cans and cigarette ends on the street and urination on our doorsteps.
- e) The property, adjacent to ours, forms part of the ground floor of Coltash Court a wholly residential block of flats, many of whose residents are petitioning against this proposal.
- f) The licence application is for 'ON premises', but the semi enclosed forecourt will undoubtedly be furnished with tables and chairs for outdoor consumption which will further amplify the nuisance.
- g) Islington police presented a report on 23 February 2012 which showed that Islington has the second highest rate of alcohol-related crime in London and listed this part of the borough as a hot-spot. They view it as a 'saturation zone' and will resist the expansion of licenced trade in the area.

Yours faithfully,

11 May 2012

Dear Mr Gallacher,

Licensing Act 2003 Notice of Hearing on 31 May 2012: Basil, 156 Whitecross Street,
London EC1Y

Further to our email of 4 April 2012 opposing the above application and following receipt of your letter of 9 May 2012 we write to inform you that we will be unable to attend on the above date but wish our following points to be known to the committee:

If the application is granted we strongly urge that these conditions be imposed for the reasons outlined beneath.

Conditions:

- a) Under no circumstances should the outdoor area be furnished or used after 10pm.
- b) Cctv cameras must be installed to monitor activity at all times.
- c) Rubbish should be cleared and disposed of legally.
- d) The planter adjacent to the out door area and adjoining our building must not be used as seating and should be kept free of litter.
- e) A Monday to Friday licence would keep the vicinity at weekends quieter for residents.

Reasons:

- 1) Whitecross Street is a well populated residential street as well as a lunchtime food market. There are already many licensed premises as well as off sales shops which more than amply supply demand.
- 2) The premises concerned are directly beneath the residential Coltash Court, a matter of feet from the flats above and immediately adjacent to our residence.
- 3) There is a history of noise and disturbance in the area resulting from alcohol related behaviour particularly in the evenings and at night throughout the week.
- 4) Environmental and health issues include unpleasant behaviour, broken glasses, discarded cans, cigarette ends on the street and urination on our doorsteps.
- 5) The licence application is for 'ON premises', but the semi enclosed paved area in front of the premises will be furnished and used as an outdoor consumption area with the inevitable noise pollution echoing around and beyond the Coltash Court forecourt.
- 6) Islington police presented a report on 23 February 2012 which showed that Islington has the second highest rate of alcohol-related crime in London and listed this part of the borough as a hot-spot. They view it as a 'saturation zone' and will resist the expansion of licenced trade in the area.

Yours faithfully

Nash, Rosemary

From: ([redacted]@islington.gov.uk [mailto:[redacted]@islington.gov.uk] com]
Sent: 27 April 2012 15:10
To: Gallacher, Simon; Licensing

Attachments: Petition.pdf; petition2.pdf



Petition.pdf (402
KB)



petition2.pdf (56
KB)

Application for a Premises Licence, Ground floor, 156
Whitecross Street, London EC1Y 8JL

Dear Mr Gallacher,

As the Chair of the Whitecross Estate TRA I attach a copy of a recent petition objecting to the proposed licence: Two Attachements..

May I remind Islington Council that there is at least 30 bedrooms living rooms and kitchens above these premises as all flats are built with all rooms facing West and the first one will be only feet away. These flats were not built to have licenced premises but small shops. The problems we will face are tha acoustics of the buildings as all noise resonates, the cigarette smoke because of our ventilation system which will draw it into the bulding and the noise nuisance as there are those who go to bed early and to get up early in the mornings. As at least two members of the TRA will be attending the licencing application meeting please will you give us fair warning.

Best Wishes

Chair
Whitecross Estate TRA
8 Coltash Court
152 Whitecross Street
London EC1Y 8QL

①

Whitecross Estate and others: Petition regarding application by Basil, 156 Whitecross Street EC1Y 8JL for a premises license for selling and consuming on the premises of alcohol.

Concerns: Noise nuisance, odour nuisance, smoke pollution nuisance

Name, address, date, signature

Further comments

<p>L 214</p>	<p>This street is already a place of frequent disturbances and disturbance at night. It does not need more licensed premises especially at weekends. The position of these premises is totally unsuitable being under and adjacent to a large number of residential premises such as ours.</p>
<p>20 21</p>	
<p>L</p>	<p>More noise, rubbish in the street.</p>
<p>LOW</p>	<p>WE ARE ALREADY PLAQUED BY LATE NIGHT DRINKERS SITTING IMMEDIATELY IN FRONT OF THESE PREMISES INTO THE EARLY HOURS. SMOKERS WILL DRINK AND SMOKE OUTSIDE. THE ACOUSTICS OF THE HIGHRISE BUILDINGS JUST AMPLIFY THE SOUND.</p>
<p>2</p>	<p>MY BEDROOM IS OPPOSITE THE PREMISES AND I AM ALREADY REGULARLY DISTURBED BY DRINKERS. THIS WILL MAKE IT MUCH WORSE.</p>

3

Whitecross Estate and others: Petition regarding application by Basil, 156 Whitecross Street EC1Y 8JL for a premises license for selling and consuming on the premises of alcohol.

Concerns: Noise nuisance, odour nuisance, smoke pollution nuisance

Name, address, date, signature

Further comments

<p>1. 5 2. 1 - - - / W - - -</p>	<p>NO MORE NOISE <u>PLEASE</u> AT LEAST THE PUB IS CLOSED WEEKENDS - GIVE US SOME PEACE!</p>
<p>1 - - - a - - -</p>	<p>LET US HAVE SOME PEACE AT THE WEEKENDS!</p>
<p>1 - - - 1 - - - ✓ - - -</p>	<p>Enough noise through week - QUIET WEEKENDS PLEASE!</p>
<p>7 - - - L</p>	<p>SAME AS ABOVE</p>
<p>1 - - - E. - - -</p>	<p>AS ABOVE.</p>
<p>1 - - -</p>	

4

Whitecross Estate and others: Petition regarding application by Basil, 156 Whitecross Street EC1Y 8JL for a premises license for selling and consuming on the premises of alcohol.

Concerns: Noise nuisance, odour nuisance, smoke pollution nuisance

Name, address, date, signature

Further comments

<p>N 4 W E /</p>	<p>Enough restaurants and bars to much noise.</p>
<p>- T st A</p>	<p>as above</p>
<p>- /</p>	<p>as above</p>
<p>- st</p>	<p>To much noise + People hungry about</p>
<p>- /</p>	<p>Noise nuisance</p>
<p>- /</p>	<p>ENOUGH NOISE FROM THE PUB!!! NO MORE PLEASE</p>

5

Whitecross Estate and others: Petition regarding application by Basil, 156 Whitecross Street EC1Y 8JL for a premises license for selling and consuming on the premises of alcohol.

Concerns: Noise nuisance, odour nuisance, smoke pollution nuisance

Name, address, date, signature

Further comments

COU	WE HAVE a BABY
	Too Noisy Under My Flat
	ARE YOU AWARE THAT PEOPLE LIVE ABOVE THIS RESTAURANT ITS A DISGRACE THAT ISLINGTON COUNCIL WOULD EVEN CONTEMPLATE THINKING ABOUT IT.
8	WE DESERVE SOME RESPE & QUIET. ALREADY TOO MUCH NOISE IN THE EVENING & AT NIGHT WHICH THE COUNCIL APPEAR TO BE OBVIOUS TO. WHY? THIS USED TO BE SUCH A NICE AREA AND
	THE COUNCIL ARE RUINING IT AS IT IS NOW SATURATED WITH ANTS SOCIAL BEHAVIOUR & NOISE.
	I am chronically ill & night-time noise exacerbates my condition as the acoustics of the building amplifies noise. Cigarette smoke from people standing outside will enter the flats.

6

Whitecross Estate and others: Petition regarding application by Basil, 156 Whitecross Street EC1Y 8JL for a premises license for selling and consuming on the premises of alcohol.

Concerns: Noise nuisance, odour nuisance, smoke pollution nuisance

Name, address, date, signature

Further comments

<p>1 11</p>	<p>As others enough noise, there are more than enough premises selling alcohol!</p>
<p>1 11</p>	
<p>1 11</p>	<p>ASB Reasons Public Protection</p>
<p>1 11</p>	<p>We already suffer enough noise below our bedroom window.</p>

7

Whitecross Estate and others: Petition regarding application by Basil, 156 Whitecross Street EC1Y 8JL for a premises license for selling and consuming on the premises of alcohol.

Concerns: Noise nuisance, odour nuisance, smoke pollution nuisance

Name, address, date, signature

Further comments

Name, address, date, signature	Further comments
	The noise of an evening is already unbearable
	The noise is already too much from various establishments. The smell of food is disgusting, we can't have our windows open in summer because of the noise through the night and the stench from the food creeping in
	WE DON'T WANT OR NEED ANYMORE!!!

Rep 3



ISLINGTON

Futurefood 3000 Ltd
Basil
156 Whitecross Street
London
EC1V 8JL

Building Control Service
Planning and Development
222 Upper Street
London
N1 1XR

T 020 7527 5986
F 020 7527 5998
E geoff.weaver@islington.gov.uk
W www.islington.gov.uk

Our ref : GW
Your ref:

Date: 1 May 2012

Dear Sirs

**Licensing Act 2003
Representation from Responsible Authority for Health and Public Safety
Basil 156 Whitecross Street EC1V 8JL**

With reference to the recent application for a premises licence under the Licensing Act 2003 at the above named premises, as the health and safety consultant for the responsible authority for health and public safety I will be making a representation to this application.

At a survey of the premises on 30 April 2012 it was found that the requirements specified in the attached schedule are in need of urgent attention to ensure the existing arrangements at the premises are adequate for health and public safety.

The premises should be maintained in good condition. Staff should be trained in the health and safety measures applicable to the premises and the action to be taken in the event of an emergency or evacuation. Enclosed for your attention are **Health and Safety Standards for Places of Assembly, Shops and Commercial Premises**.

This communication is without prejudice to the necessity of complying with any other statutory controls which may be applicable, whether administered by the council or by any other authority.

Please give notification of the commencement and completion of the works.

Should you require any advice or information please contact me at the above address.

Yours faithfully

Geoff Weaver
Senior Building Surveyor (Licensing Health and Safety)

**Islington Licensing Authority
Licensing Act 2003**

Representation form from Responsible Authority for Health and Public Safety

Name	Geoff Weaver
Job title	Senior Building Surveyor (Licensing Health and Safety)
Postal address	Islington Council, Building Control Service 222 Upper Street, London N1 1XR
email	geoff.weaver@islington.gov.uk
Contact telephone number	020 7527 5986
Name and address of the premises concerning the representation	Basil 156 Whitecross Street EC1V 8JL
Public Safety	The arrangements at the premises are insufficient for health and public safety. See attached requirements schedule.
Suggested conditions that could be added to the licence to remedy the public safety representation	The premises shall not be used under the licence until the requirements specified in the schedule dated 1 May 2012 have been completed and approved in writing by the responsible authority for health and public safety.

Signed: _____ Date: _____

Please return this form along with any additional sheets to: Applicant and Islington Council, Licensing Team, 222 Upper Street, London N1 1XR or email to licensing@islington.gov.uk This form must be returned within the statutory period. For more details please check with the Licensing Support Team on 020 7527 3031.

**Licensing Act 2003 – Requirements schedule dated 1 May 2012 for
Basil 156 Whitecross Street EC1V 8JL**

(1) The non-maintained emergency lighting should be wired to the local lighting circuit in such a manner as to operate not only in the event of failure of the mains supply but also on failure of the supply to the local lighting circuit.

(2) The minimum provision for fire extinguishers should be:

One carbon dioxide fire extinguisher (rating 34B) adjacent to the emergency exit in the rear kitchen and one carbon dioxide fire extinguisher (rating 34B) behind or adjacent to the cashiers/sales counter in the restaurant.

Fire extinguishers should be on brackets or stands and located so as not to obstruct exit routes or cause a hazard to persons in and about the premises.

Appropriate signs should be fixed adjacent to the fire extinguishers indicating the type of fire fighting appliance and the class of fire covered.

(3) Copies of the inspection and test certificates specified below, certified by an approved competent person, should be submitted to the responsible authority for health and public safety.

Electrical installation
Emergency lighting
Fire alarm
Fire extinguishers

An approved competent person for the testing and certification of electrical installations and emergency lighting should be one of the following:

- (i) A qualified member of the Institution of Engineering and Technology, or
- (ii) A contractor enrolled with the National Inspection Council for Electrical Installation Contracting, or a member of the Electrical Contractors Association, or a competent person from an appropriate approved organisation.

For fire alarms any of the above, or

A member of the Loss Prevention Council 1014 Scheme, or a member of the British Approvals for Fire Equipment SP203 Scheme.

Inspection and service certificates for fire fighting appliances should be obtained from an organisation certified by the British Approvals for Fire Equipment (BAFE), or a competent person from an appropriate approved organisation.

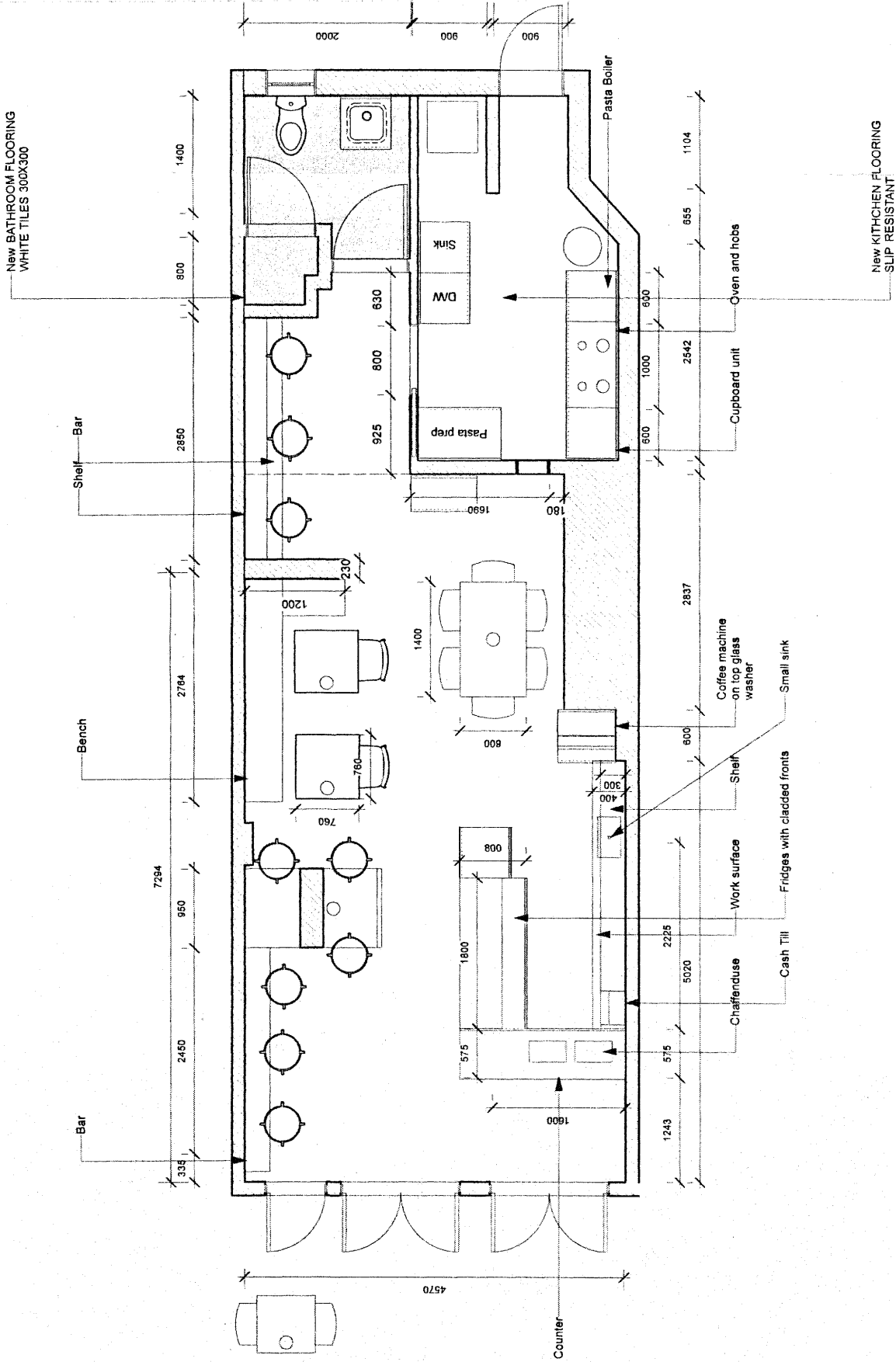

No Description Date By

PROPOSED

Basil

156 Whitecross Street
EC1Y 8TL

Proposed Floor Plan

044_01

DATE SCALE BY
14.02.12 1:50 @A3 NC

Proposed Floor Plan

Gallacher, Simon

From: Lorenzo Canonica [lollolondon84@gmail.com]
Sent: 10 May 2012 16:12
To: Gallacher, Simon
Subject: Premises licence application

Hallo Mr Gallacher, my name is Lorenzo Canonica, i'm the director of the futurefood3000 Ltd. I just received the letter with the petition regarding the application for premises licence at Basil
156 ground floor Whitecross street
EC1Y 8JL

I do understand the concerns of the neighbours and we are prepared to meet some conditions that they suggest ed in the petition. We are a business that is working just during the day and we are planning to set our opening time from monday till friday 10:00 am till 6:00/7:00 pm, weekend close. We may do some tasting on sundays but always till 6:00/7:00 maximum. We actually quite flexible regarding this matter and we more than happy to help the neighbourhood's quiet living. I'm a personal licence holder and i worked with mitchell and butlers for quite a long time so i know how to deal with alcohol.

Thank you for your time and if you need anything from me my phone number is 07946198940.

Best regards
Lorenzo Canonica

Suggested conditions of approval consistent with the operating schedule

1. CCTV shall be installed at the premises.
2. Customers shall be asked to leave the premises quietly.
3. Customers shall not be permitted to take drinks outside.
4. A "Challenge 25" policy shall be implemented at the premises.

Suggested conditions of approval recommended by Noise Team and agreed by applicant.

5. Notices shall be prominently displayed at exits requesting customers to respect the needs of local residents and to leave the premises and the area quietly.
6. No rubbish including bottles will be moved, removed or placed in outside areas on Sundays or Bank/Public Holidays and between the hours of 10pm and 7am other days of the week.
7. No deliveries on Sundays or Bank/Public Holidays and between the hours of 10pm and 7am other days of the week.
8. No drinks to be taken outside.

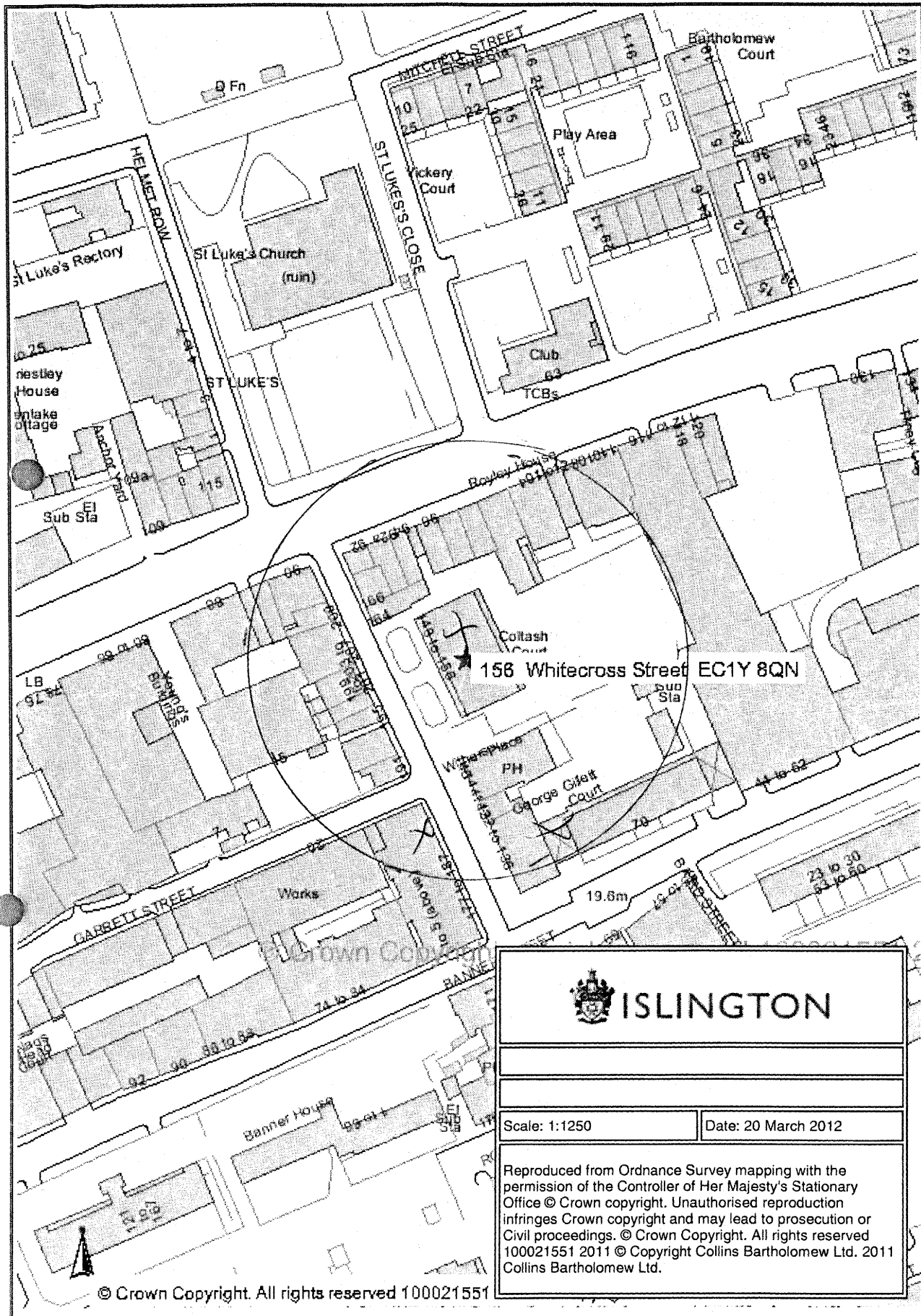

© Crown Copyright. All rights reserved 100021551

 ISLINGTON	
<p>Scale: 1:1250</p> <p>Date: 20 March 2012</p>	
<p>Reproduced from Ordnance Survey mapping with the permission of the Controller of Her Majesty's Stationary Office © Crown copyright. Unauthorised reproduction infringes Crown copyright and may lead to prosecution or Civil proceedings. © Crown Copyright. All rights reserved 100021551 2011 © Copyright Collins Bartholomew Ltd. 2011 Collins Bartholomew Ltd.</p>	

To see all the details that are visible on the screen, use the Print link next to the map.



To see all the details that are visible on the screen, use the Print link next to the map.

Google

