



Report of: **Service Director, Public Protection**

Meeting of	Date	Agenda Item	Ward(s)
Licensing Sub-Committee	18 <sup>th</sup> December 2012	33	Junction

Delete as appropriate		Non-exempt
-----------------------	--	------------

**Subject: PREMISES LICENCE VARIATION APPLICATION**  
**RE: A K LONDIS, 55-57 JUNCTION ROAD, LONDON, N19 5QU**

## 1. Synopsis

- 1.1 This is an application for the variation of a premise licence under the Licensing Act 2003.
- 1.2 The variation application is to:
  - i) Extend the current hours for the sale by retail of alcohol, Monday to Saturday 08:00 to 01:00 the following day, Sunday 08:00 to 00:00 for off sales only.
  - ii) Provide late night refreshment from Monday to Sunday 23:00 to 05:00 the following day.
  - iii) Remove the restrictions relating to the retail sale of alcohol on Good Friday and Christmas Day.

## 2. Recommendations

- 2.1 To determine the application for a variation of the premises licence under Section 34 of the Licensing Act 2003.
- 2.2 If the Committee grants the application it should be subject to:
  - i. conditions of the current premises licence;
  - ii. conditions prepared by the Licensing Officer which are consistent with the Operating Schedule (See appendix 4);
  - iii. conditions recommended by responsible Authorities (see appendix 4);

- iv. any conditions deemed necessary by the Committee to promote the four licensing objectives.

### 3. Background

- 3.1 The premises currently holds a licence to permit the sale of alcohol for off sales only on
  - i) Monday to Saturday from 08.00hrs to 23.00hrs and Sunday 08:00hrs to 22.30hrs.
  - ii) The premises were a Nisa convenience store and off licence which has been recently gutted and refurbished. The premises have been changed to a Londis convenience store and off licence which aims to serve hot food such as sausage rolls and pasties till 05.00hrs.
- 3.2 Papers are attached as follows:-
  - Appendix 1: application form;
  - Appendix 2a: name & address details of those persons making representations;
  - Appendix 2: representations;
  - Appendix 3: current licence.
  - Appendix 4 suggested conditions and map of premise location.
- 3.3 The Licensing Authority has received 3 letters of representation, none of which are from people who requested that they remain anonymous.

### 4. Planning Implications

- 4.1 The planning officer has confirmed that as premises is to remain as a convenience store then no planning permission is required. As the selling of sausage rolls and pasties is not the primary part of the business it therefore does not constitute a change of use. There are no planning conditions on opening hours.

### 5. Conclusion and reasons for recommendations

- 4.1 The Council is required to consider this application in the light of all relevant information, and if approval is given, it may attach such conditions necessary to promote the licensing objectives.

#### Background papers:

The Council's Statement of Licensing Policy  
Licensing Act 2003  
Secretary of States Guidance

Final Report Clearance

Signed by

  
Service Director – Public Protection

Date 6/12/12

Received by

Head of Scrutiny and Democratic Services

Date

Report author: Anthony Baptiste

Tel: 020 7527 3014

E-mail: [Anthony.baptiste@islington.gov.uk](mailto:Anthony.baptiste@islington.gov.uk)

Checked OK, D. White.

22 OCT 2012

**Application to vary a premises licence under the Licensing Act 2003**

**PLEASE READ THE FOLLOWING INSTRUCTIONS FIRST**

Before completing this form please read the guidance notes at the end of the form. If you are completing this form by hand please write legibly in block capitals. In all cases ensure that your answers are inside the boxes and written in black ink. Use additional sheets if necessary.

You may wish to keep a copy of the completed form for your records.

I **Mr Dipan PATEL**

*(Insert name(s) of applicant)*

**being the premises licence holder, apply to vary a premises licence under section 34 of the Licensing Act 2003 for the premises described in Part 1 below**

<b>Premises licence number</b> 118686/3290
---

**Part 1 – Premises Details**

Postal address of premises or, if none, ordnance survey map reference or description			
Nisa Local 55-57 Junction Road			
Post town	London	Postcode	N19 5QU

Telephone number at premises (if any)	0207 272 7012
Non-domestic rateable value of premises	£37000

**Part 2 – Applicant details**

Daytime contact telephone number	0207 272 7012		
E-mail address (optional)			
Current postal address if different from premises address			
Post town		Postcode	

<b>ISLINGTON COUNCIL LICENSING</b>			
Date	22/10/12	Fee Paid	£315
Cheque Number	002283		
Receipt Number	54266		
Signature	DIPAN		

**Part 3 - Variation**

Please tick as appropriate

Do you want the proposed variation to have effect as soon as possible?

Yes

No

If not, from what date do you want the variation to take effect?

DD		MM		YYYY			

**Please describe briefly the nature of the proposed variation (Please see guidance note 1).**

1. To vary the hours that alcohol may be sold for consumption off the premises from those currently shown on the licence to 08:00 – 01:00 on Monday to Saturday and 08:00 to 00:00 on Sunday.
2. To permit the sale of hot food and or hot drink from 23:00 to 05:00 on all days.
3. To remove the restrictions relating to the retail sale of alcohol on Good Friday and Christmas Day.
4. To remove outdated and unenforceable conditions.
5. To add conditions which are enforceable and promote the licensing objectives.
6. To retain the existing unrestricted opening hours

If your proposed variation would mean that 5,000 or more people are expected to attend the premises at any one time, please state the number expected to attend:

**Part 4 Operating Schedule**

Please complete those parts of the Operating Schedule below which would be subject to change if this application to vary is successful.

**Provision of regulated entertainment**

**Please tick all that apply**

- a) plays (if ticking yes, fill in box A)
- b) films (if ticking yes, fill in box B)
- c) indoor sporting events (if ticking yes, fill in box C)
- d) boxing or wrestling entertainment (if ticking yes, fill in box D)
- e) live music (if ticking yes, fill in box E)
- f) recorded music (if ticking yes, fill in box F)
- g) performances of dance (if ticking yes, fill in box G)
- h) anything of a similar description to that falling within (e), (f) or (g) (if ticking yes, fill in box H)

**Provision of late night refreshment** (if ticking yes, fill in box I)

**Sale by retail of alcohol** (if ticking yes, fill in box J)

**In all cases complete boxes K, L and M**

A

Plays Standard days and timings (please read guidance note 6)			Will the performance of a play take place indoors or outdoors or both – please tick (please read guidance note 2)	Indoors	<input type="checkbox"/>
Day	Start	Finish		Outdoors	<input type="checkbox"/>
Mon	N	A	<u>Please give further details here</u> (please read guidance note 3)		
Tue					
Wed			<u>State any seasonal variations for performing plays</u> (please read guidance note 4)		
Thur					
Fri			<u>Non standard timings. Where you intend to use the premises for the performance of plays at different times to those listed in the column on the left, please list</u> (please read guidance note 5)		
Sat					
Sun					

B

Films Standard days and timings (please read guidance note 6)			Will the exhibition of films take place indoors or outdoors or both – please tick (please read guidance note 2)	Indoors	<input type="checkbox"/>
				Outdoors	<input type="checkbox"/>
				Both	<input type="checkbox"/>
Day	Start	Finish	Please give further details here (please read guidance note 3)		
Mon	N	A			
Tue			State any seasonal variations for the exhibition of films (please read guidance note 4)		
Wed					
Thur			Non standard timings. Where you intend to use the premises for the exhibition of films at different times to those listed in the column on the left, please list (please read guidance note 5)		
Fri					
Sat					
Sun					



C

Indoor sporting events Standard days and timings (please read guidance note 6)			<u>Please give further details</u> (please read guidance note 3)
Day	Start	Finish	
Mon	N	A	<u>State any seasonal variations for indoor sporting events</u> (please read guidance note 4)
Tue			
Wed			
Thur			<u>Non standard timings. Where you intend to use the premises for indoor sporting events at different times to those listed in the column on the left, please list</u> (please read guidance note 5)
Fri			
Sat			
Sun			

D

Boxing or wrestling entertainments Standard days and timings (please read guidance note 6)			<u>Will the boxing or wrestling entertainment take place indoors or outdoors or both – please tick</u> (please read guidance note 2)	Indoors	<input type="checkbox"/>
				Outdoors	<input type="checkbox"/>
				Both	<input type="checkbox"/>
Day	Start	Finish	<u>Please give further details here</u> (please read guidance note 3)		
Mon	N	A			
Tue					
Wed			<u>State any seasonal variations for boxing or wrestling entertainment</u> (please read guidance note 4)		
Thur					
Fri			<u>Non standard timings. Where you intend to use the premises for boxing or wrestling entertainment at different times to those listed in the column on the left, please list</u> (please read guidance note 5)		
Sat					
Sun					

E

Live music Standard days and timings (please read guidance note 6)			<u>Will the performance of live music take place indoors or outdoors or both – please tick</u> (please read guidance note 2)	Indoors	<input type="checkbox"/>
				Outdoors	<input type="checkbox"/>
				Both	<input type="checkbox"/>
Day	Start	Finish	<u>Please give further details here</u> (please read guidance note 3)		
Mon	N	A			
Tue					
Wed			<u>State any seasonal variations for the performance of live music</u> (please read guidance note 4)		
Thur					
Fri			<u>Non standard timings. Where you intend to use the premises for the performance of live music at different times to those listed in the column on the left, please list</u> (please read guidance note 5)		
Sat					
Sun					

F

Recorded music Standard days and timings (please read guidance note 6)			Will the playing of recorded music take place indoors or outdoors or both – please tick (please read guidance note 2)	Indoors	<input type="checkbox"/>
				Outdoors	<input type="checkbox"/>
Day	Start	Finish		Both	<input type="checkbox"/>
Mon	N	A	Please give further details here (please read guidance note 3)		
Tue					
Wed			State any seasonal variations for the playing of recorded music (please read guidance note 4)		
Thur					
Fri			Non standard timings. Where you intend to use the premises for the playing of recorded music at different times to those listed in the column on the left, please list (please read guidance note 5)		
Sat					
Sun					

G

Performances of dance Standard days and timings (please read guidance note 6)			<b><u>Will the performance of dance take place indoors or outdoors or both – please tick</u></b> (please read guidance note 2)	Indoors	<input type="checkbox"/>
Day	Start	Finish		Outdoors	<input type="checkbox"/>
Mon	N	A	<b><u>Please give further details here</u></b> (please read guidance note 3)	Both	<input type="checkbox"/>
Tue					
Wed			<b><u>State any seasonal variations for the performance of dance</u></b> (please read guidance note 4)		
Thur					
Fri			<b><u>Non standard timings. Where you intend to use the premises for the performance of dance at different times to those listed in the column on the left, please list</u></b> (please read guidance note 5)		
Sat					
Sun					

H

<b>Anything of a similar description to that falling within (e), (f) or (g)</b> Standard days and timings (please read guidance note 6)			Please give a description of the type of entertainment you will be providing		
Day	Start	Finish	<b>Will this entertainment take place indoors or outdoors or both – please tick</b> (please read guidance note 2)	Indoors	<input type="checkbox"/>
Mon	N	A		Outdoors	<input type="checkbox"/>
				Both	<input type="checkbox"/>
Tue			<b>Please give further details here</b> (please read guidance note 3)		
Wed					
Thur			<b>State any seasonal variations for entertainment of a similar description to that falling within (e), (f) or (g)</b> (please read guidance note 4)		
Fri					
Sat			<b>Non standard timings. Where you intend to use the premises for the entertainment of a similar description to that falling within (e), (f) or (g) at different times to those listed in the column on the left, please list</b> (please read guidance note 5)		
Sun					

<b>Late night refreshment</b> Standard days and timings (please read guidance note 6)			<b><u>Will the provision of late night refreshment take place indoors or outdoors or both – please tick</u></b> (please read guidance note 2)	Indoors	<input checked="" type="checkbox"/>
				Outdoors	<input type="checkbox"/>
				Both	<input type="checkbox"/>
Day	Start	Finish			
Mon	23:00	05:00	<b><u>Please give further details here</u></b> (please read guidance note 3)		
Tue	23:00	05:00			
Wed	23:00	05:00	<b><u>State any seasonal variations for the provision of late night refreshment</u></b> (please read guidance note 4)		
Thur	23:00	05:00			
Fri	23:00	05:00	<b><u>Non standard timings. Where you intend to use the premises for the provision of late night refreshment at different times, to those listed in the column on the left, please list</u></b> (please read guidance note 5)		
Sat	23:00	05:00			
Sun	23:00	05:00			

J

<b>Supply of alcohol</b> Standard days and timings (please read guidance note 6)			<b>Will the supply of alcohol be for consumption – please tick</b> (please read guidance note 7)	On the premises	<input type="checkbox"/>
				Off the premises	<input checked="" type="checkbox"/>
Day	Start	Finish		Both	<input type="checkbox"/>
Mon	08:00	01:00	<b>State any seasonal variations for the supply of alcohol</b> (please read guidance note 4)		
Tue	08:00	01:00			
Wed	08:00	01:00			
Thur	08:00	01:00	<b>Non-standard timings. Where you intend to use the premises for the supply of alcohol at different times to those listed in the column on the left, please list</b> (please read guidance note 5)		
Fri	08:00	01:00			
Sat	08:00	01:00			
Sun	08:00	00:00			

K

**Please highlight any adult entertainment or services, activities, other entertainment or matters ancillary to the use of the premises that may give rise to concern in respect of children** (please read guidance note 8).

No adult entertainment will be provided.



L

<b>Hours premises are open to the public</b> Standard days and timings (please read guidance note 6)			<b>State any seasonal variations</b> (please read guidance note 4)
Day	Start	Finish	
Mon	00:00	00:00	
Tue	00:00	00:00	
Wed	00:00	00:00	
Thur	00:00	00:00	
Fri	00:00	00:00	<b>Non standard timings. Where you intend the premises to be open to the public at different times from those listed in the column on the left, please list</b> (please read guidance note 5)
Sat	00:00	00:00	
Sun	00:00	00:00	

Please identify those conditions currently imposed on the licence which you believe could be removed as a consequence of the proposed variation you are seeking.

**All the conditions listed under Annex 2 of the current premises licence which are:**

- 1) The restrictions on hours during which the sale of alcohol is authorised does not prohibit:
  - a) during the first 20 minutes after the above hours, the taking of the alcohol from the premises, unless the alcohol is supplied or taken in an open vessel;
  - b) the ordering of alcohol to be consumed off the premises, or the dispatch by the vendor of alcohol so ordered;
  - c) the sale of alcohol to a trader or club for the purposes of the trade or club;
  - d) the sale or supply of alcohol to any canteen or mess, being a canteen in which the sale or supply of alcohol is carried out under the authority of the secretary of state or an authorised mess of members of her majesty's naval military.
- 2) Alcohol shall not be sold in an open container or be consumed in the licensed premises.

**AND**

The restriction on the retail sale of alcohol on Good Friday between 08:00 and 22:30 and on Christmas Day between 12:00 to 15:00 and 19:00 to 22:30.

Please tick as appropriate

- I have enclosed the premises licence
- I have enclosed the relevant part of the premises licence

If you have not ticked one of these boxes, please fill in reasons for not including the licence or part of it below

Reasons why I have not enclosed the premises licence or relevant part of premises licence.

Part B is not enclosed as it has been lost.

**M**

Describe any additional steps you intend to take to promote the four licensing objectives as a result of the proposed variation:

**a) General – all four licensing objectives (b, c, d and e) (please read guidance note 9)**

The Premises Licence Holder shall train all staff to uphold each of the four licensing objectives.

The Premises Licence Holder shall maintain written records of all staff training.

The Premises Licence Holder shall be maintain staff training records on the premises and make them available for inspection by officers of the Licensing Authority and the Metropolitan Police Service.

**b) The prevention of crime and disorder**

A Digital CCTV system comprising of multiple cameras is installed and shall be adequately maintained.

The head unit (recorder) for storing the images shall store such data on a hard drive or a similar quality medium.

The equipment to record the images shall be located out of the sight and reach of the public and adequately secured.

A CD or DVD burner shall form part of the system to facilitate making copies of the images.

The quality of the images shall be of a sufficiently high standard to allow identification of the subject matter.

Cameras shall cover all key areas and capture clear headshots of persons entering the shop, the till area and areas where alcohol is displayed for sale.

Images shall be retained for a period of 31 days before overwriting.

Images shall be disclosed to officers of the Metropolitan Police Service and authorised officers of the London Borough of Islington in accordance with the principles of The Data Protection Act 1998.

When the premises are open to the public, a staff member shall be available to efficiently operate the CCTV system.

A representative from the premises will actively participate in any scheme(s) promoted by both the Police and the Local Authority which are designed to improve partnership working and communication between premises, authorised persons, interested parties and responsible authorities within a defined area of the Borough.

Alcohol displayed for retail sale will not be accessible outside permitted hours for such sale.

No alcoholic goods will be purchased from sellers cold calling at the Premises.

The Premises Licence Holder will immediately report to The Licensing Authority any instance of a cold caller to the Premises attempting to sell alcohol.

Invoices (or copies) for all alcoholic goods found stored on the Premises will be kept at the Premises and upon request will be made available to officers from the Licensing Authority, The Metropolitan Police Service and Her Majesty's Revenue and Customs Departments.

A stock control system will be introduced, so that the Premises Licence Holder can quickly identify where and when alcoholic goods have been purchased.

An ultra-violet light will be available at the premises for the purpose of checking the United Kingdom Duty Stamp on spirits as soon as practicable after they have been purchased.

If any spirits purchased by the company have United Kingdom Duty Stamps that do not fluoresce under ultra-violet light, or are otherwise suspicious, the Premises Licence Holder shall identify the supplier to The Licensing Authority and Her Majesty's Revenue and Customs as soon as possible.

Spirits will not be purchased in a box that appears to have been re-sealed prior to the contract of sale.

#### **c) Public safety**

No further action other than compliance with The Regulatory Reform Fire Safety Order 2005 and the Health and Safety at Work Act 1974 and its associated regulations.

#### **d) The prevention of public nuisance**

Waste from the premises shall not be stored nor disposed of at a time or in a manner which may cause a nuisance.

Adequate signage will be displayed at each public exit from the premises asking customers to respect their neighbours and to leave the premises and area quietly.

**e) The protection of children from harm**

The premises shall abide by an age verification policy in relation to the sale of alcohol. The policy shall require individuals who appear to be under 25 years of age to produce, on request, to a member of staff, before being served alcohol, identification, bearing their photograph, date of birth and a holographic mark.

The Premises Licence Holder shall require staff to note any refusals to sell alcohol to individuals who appear to be under the age of 25 years in a refusals log.

The Designated Premises Supervisor shall check and sign the refusals log each month.

The refusals log shall be made available for inspection by authorised officers from the Licensing Authority and The Metropolitan Police Service.

The Premises Licence Holder shall ensure that staff are trained to understand the law relating to age restricted products and ensure that they sign to confirm that they have understood the training.

**Checklist:**

**Please tick to indicate agreement**

- I have made or enclosed payment of the fee.
- I have sent copies of this application and the plan to responsible authorities and others where applicable.
- I understand that I must now advertise my application.
- I have enclosed the premises licence or relevant part of it or explanation.
- I understand that if I do not comply with the above requirements my application will be rejected.

**IT IS AN OFFENCE, LIABLE ON SUMMARY CONVICTION TO A FINE NOT EXCEEDING LEVEL 5 ON THE STANDARD SCALE, UNDER SECTION 158 OF THE LICENSING ACT 2003, TO MAKE A FALSE STATEMENT IN OR IN CONNECTION WITH THIS APPLICATION.**

**Part 5 – Signatures** (please read guidance note 10)

**Signature of applicant (the current premises licence holder) or applicant’s solicitor or other duly authorised agent** (please read guidance note 11). **If signing on behalf of the applicant, please state in what capacity.**

Signature	
Date	18.10.12
Capacity	Duly authorised agent on behalf of the applicant.

**Where the premises licence is jointly held, signature of 2nd applicant (the current premises licence holder) or 2nd applicant’s solicitor or other authorised agent** (please read guidance note 12). **If signing on behalf of the applicant, please state in what capacity.**

Signature	
Date	
Capacity	

<b>Contact name (where not previously given) and address for correspondence associated with this application (please read guidance note 13)</b> Keith Walmsley 76 Billy Lows Lane			
<b>Post town</b>	Potters Bar, Hertfordshire	<b>Post code</b>	EN6 1XL
<b>Telephone number (if any)</b>	07525 471028		
<b>If you would prefer us to correspond with you by e-mail, your e-mail address (optional)</b> keith@premlc.com			

#### Notes for Guidance

**This application cannot be used to vary the licence so as to extend the period for which the licence has effect or to vary substantially the premises to which it relates. If you wish to make that type of change to the premises licence, you should make a new premises licence application under section 17 of the Licensing Act 2003.**

1. Describe the premises. For example the type of premises, its general situation and layout and any other information which could be relevant to the licensing objectives. Where your application includes off-supplies of alcohol and you intend to provide a place for consumption of these off-supplies, you must include a description of where the place will be and its proximity to the premises.
2. Where taking place in a building or other structure please tick as appropriate (indoors may include a tent).
3. For example state type of activity to be authorised, if not already stated, and give relevant further details, for example (but not exclusively) whether or not music will be amplified or unamplified.
4. For example (but not exclusively), where the activity will occur on additional days during the summer months.
5. For example (but not exclusively), where you wish the activity to go on longer on a particular day e.g. Christmas Eve.
6. Please give timings in 24 hour clock (e.g. 16:00) and only give details for the days of the week when you intend the premises to be used for the activity.
7. If you wish people to be able to consume alcohol on the premises, please tick 'on the premises'. If you wish people to be able to purchase alcohol to consume away from the premises, please tick 'off the premises'. If you wish people to be able to do both, please tick 'both'.
8. Please give information about anything intended to occur at the premises or ancillary to the use of the premises which may give rise to concern in respect of children regardless of whether you intend children to have access to the premises, for example (but not exclusively) nudity or semi-nudity, films for restricted age groups or the presence of gaming machines.
9. Please list here steps you will take to promote all four licensing objectives together.
10. The application form must be signed.
11. An applicant's agent (for example solicitor) may sign the form on their behalf provided that they have actual authority to do so.
12. Where there is more than one applicant, each of the applicants or their respective agents must sign the application form.
13. This is the address which we shall use to correspond with you about this application.

LONDIS 55-57 JUNCTION ROAD N19 5QU

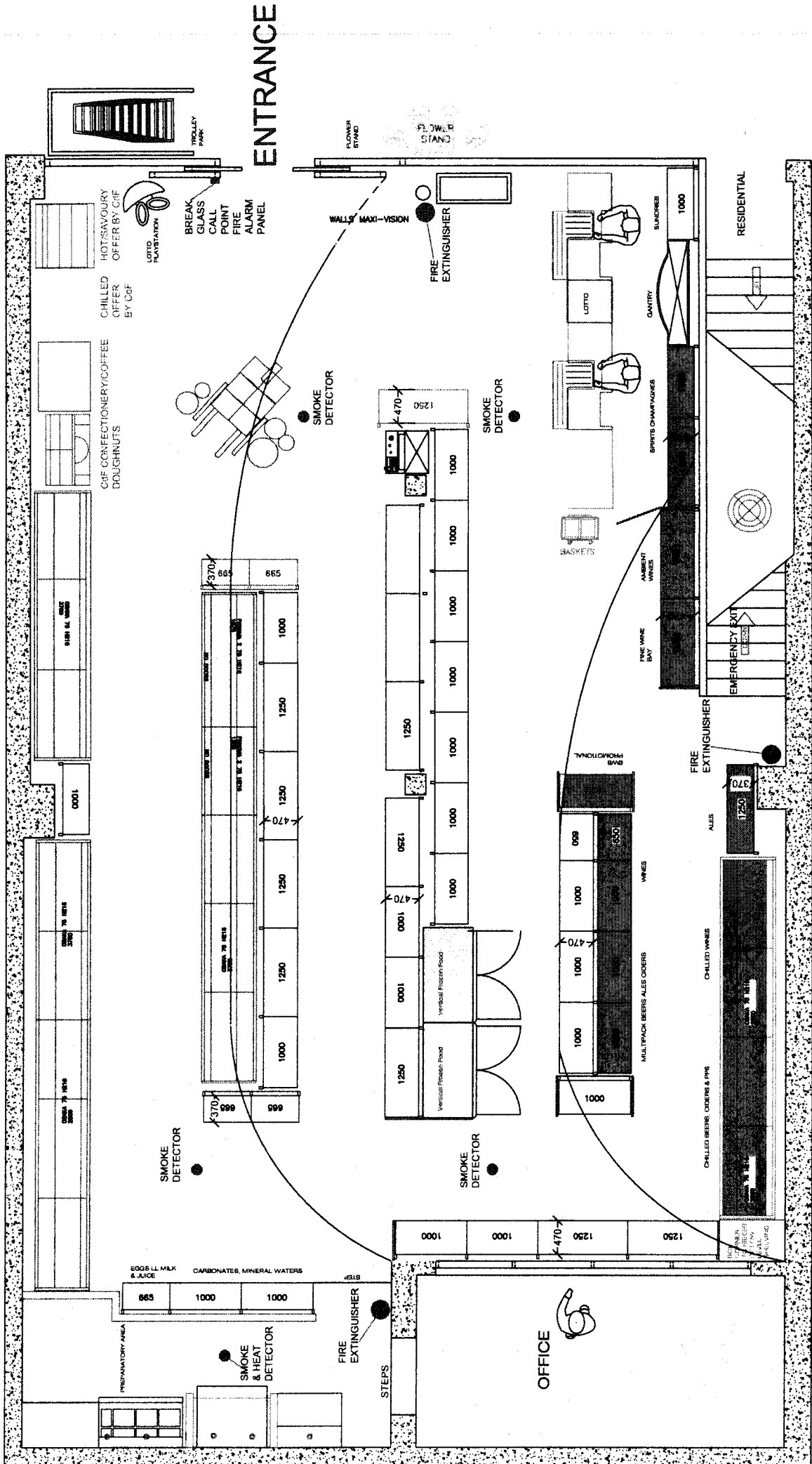

ENTRANCE

From: Kate Calvert [REDACTED]  
Sent: 22 October 2012 18:13  
To: Licensing  
Cc: [REDACTED]  
Subject: Premises Licence Variation: 55-57 Junction Road

I am responding on behalf of the Better Archway Forum to this application.

As we have stated before, we are extremely concerned about the effect of growing numbers of alcohol licences in Archway there being already more than 40. We are particularly concerned about licences applicable late at night of which there have also been a growing number. Finally, we believe that issuing alcohol licences to late night food outlets further exacerbates the position, resulting in greater public disorder and damage against property. Indeed, in our submission regarding LB Islington licensing policy we have proposed that properties either carry a licence for late night takeaway food, or for alcohol, but not for both.

If permission is given to sell late night refreshments to 5am there will always be the possibility that alcohol will accompany that, if not proffered by the business then shoplifted, or sold under coercion. The result in all events is to increase the amount of alcohol being carried and drunk on the streets around the shop, to the detriment of the majority.

This application comes from a good quality shop which may sensibly choose to operate in the evenings. However, we do not believe that it is appropriate for any such outlet to be open until 1am, still less to be selling alcohol until that time. The only people who buy alcohol at 1am are people who have already been drinking. Extending licensing hours in this way therefore effectively ensures greater numbers of drunks and greater drunkenness on the surrounding streets. This is both inconvenient - their disputes keep residents awake well into the night - and makes the streets less safe.

Accordingly we request that this application be refused.

Kate Calvert  
Chair, Better Archway Forum  
c/o Hargrave Park School  
51 Bredgar Road  
London N19 5BS

From: Fitzsimons, Aiden  
Sent: 29 October 2012 09:53  
To: Baptiste, Anthony  
Cc: Nash, Rosemary  
Subject: FW: Premises Licence Variation: 55-57 Junction Road

-----Original Message-----

From: [REDACTED]  
Sent: 28 October 2012 13:57  
To: Licensing  
Subject: Re: Premises Licence Variation: 55-57 Junction Road

I am responding to this application as a long-standing local resident.

I am extremely concerned about the effect of growing numbers of alcohol licences in Archway there being already more than 40. I am particularly concerned about licences applicable late at night of which there have also been a growing number. Issuing alcohol licences to late night food outlets further exacerbates the position, possibly resulting in greater public disorder and damage against property.

If permission is given to sell late night refreshments to 5am there will always be the possibility that alcohol will accompany that, if not proffered by the business then shoplifted, or sold under coercion. The result is in all events is to increase the amount of alcohol being carried and drunk on the streets around the shop, to the detriment of the majority.

This application comes from a good quality shop which may sensibly choose to operate in the evenings. However, I do not believe that it is appropriate for any such outlet to be open until 1am, still less to be selling alcohol until that time. The only people who buy alcohol at 1am are people who have already been drinking. Extending licensing hours in this way therefore effectively ensures greater numbers of drunks and greater drunkenness on the surrounding streets. This is both inconvenient - their disputes keep residents awake well into the night - and makes the streets less safe.

An area grows and thrives if there is a diversity of shops and businesses. In my opinion, given the current saturation of Archway by alcohol and gambling related enterprises this new enterprise will add little or no value to the area. In fact it may well diminish it further.

Accordingly I request that this application be refused.

Kind regards,



**Councillor Janet Burgess**

**Executive Member for Health and Wellbeing  
Labour Councillor for Junction Ward**

**Town Hall  
Upper Street  
Islington  
London N1 2UD  
[www.islington.gov.uk](http://www.islington.gov.uk)**

Rosemary Nash  
Licensing Department  
London Borough of Islington  
222 Upper Street  
London  
N1 1XR

**PA: Amanda Russell  
Tel: 020 7527 3051  
Fax: 020 7527 3008  
Email: [amanda.russell@islington.gov.uk](mailto:amanda.russell@islington.gov.uk)**

2<sup>nd</sup> November 2012

Dear Ms Nash,

I write to object to the application for increasing the hours of the licence at 55-57 Junction Road, Archway. I oppose the increase in hours when alcohol is on sale, in line with the consultation on the new Licensing Policy for Islington.

I do not believe that encouraging demand for alcohol by making it available for purchase for long hours is conducive to the Licensing Act's objectives relating to the prevention of crime and disorder, the protection of children from harm, public safety, and the prevention of public nuisance.

Islington has the highest number of alcohol-related hospital admissions of under 18s in London, and second highest number of adults. Alcohol is clearly having a very detrimental effect on our citizens, and such an extension of hours will not help to reduce the prevalence of excessive drinking. Archway is also a crime hotspot.

There are approximately 80 premises in the Archway area which have licences; a frequent comment in requests for extensions is that other premises in the area have long hours. I do not think that having 80 premises in a small area selling alcohol for most of the 24 hours is in any way necessary for the economy of the area. The Council is putting a good deal of money and resources into Archway to regenerate it; excessive amounts of alcohol easily available are not the way forward.

Thank you for your consideration of my submission,

Best wishes,



**Councillor Janet Burgess  
Executive Member for Health and Wellbeing  
Labour Councillor - Junction Ward**



**PREMISES LICENCE  
LICENSING ACT 2003**

<b>Premises licence number</b>	3028-170912		
<b>Postal address of premises, or if none, ordnance survey map reference or description</b>			
<b>PIONEER FOOD AND WINE 55-57 JUNCTION ROAD</b>			
<b>Post town</b>	London	<b>Post code</b>	N19 5QY
<b>Telephone number</b>	020 7272 7012		

<b>Where the licence is time limited the dates</b>
Not Applicable

<b>Licensable activities authorised by the licence</b>
The sale by retail of alcohol

<b>The times the licence authorises the carrying out of licensable activities</b>																												
<ul style="list-style-type: none"> <li>The sale by retail of alcohol: <table> <tr><td>Monday</td><td>08:00</td><td>to</td><td>23:00</td></tr> <tr><td>Tuesday</td><td>08:00</td><td>to</td><td>23:00</td></tr> <tr><td>Wednesday</td><td>08:00</td><td>to</td><td>23:00</td></tr> <tr><td>Thursday</td><td>08:00</td><td>to</td><td>23:00</td></tr> <tr><td>Friday</td><td>08:00</td><td>to</td><td>23:00</td></tr> <tr><td>Saturday</td><td>08:00</td><td>to</td><td>23:00</td></tr> <tr><td>Sunday</td><td>10:00</td><td>to</td><td>22:30</td></tr> </table> <p>Except on:  Good Friday: 08:00 to 22:30  Christmas Day: 12:00 to 15:00 and 19:00 to 22:30</p> </li> </ul>	Monday	08:00	to	23:00	Tuesday	08:00	to	23:00	Wednesday	08:00	to	23:00	Thursday	08:00	to	23:00	Friday	08:00	to	23:00	Saturday	08:00	to	23:00	Sunday	10:00	to	22:30
Monday	08:00	to	23:00																									
Tuesday	08:00	to	23:00																									
Wednesday	08:00	to	23:00																									
Thursday	08:00	to	23:00																									
Friday	08:00	to	23:00																									
Saturday	08:00	to	23:00																									
Sunday	10:00	to	22:30																									

<b>The opening hours of the premises:</b>
Not specified

<b>Where the licence authorises supplies of alcohol whether these are on and/or off supplies</b>
Off supplies

<b>Name, (registered) address, telephone number and e-mail (where relevant) of holder of premises licence</b>
Mr Dipan Patel 55-57 Junction Road London N19 5QY 020 7272 7012

**Registered number of holder, for example company number, charity number  
(where applicable)**

Not applicable

**Name, address and telephone number of designated premises supervisor where  
the premises licence authorises the supply of alcohol**

Mr Dipan Patel

[REDACTED]

[REDACTED]

[REDACTED]

[REDACTED]

**Personal licence number and issuing authority of personal licence held by  
designated premises supervisor where the premises licence authorises the  
supply of alcohol**

AN/199907119 – Barnet Council

Islington Council  
Public Protection Division  
222 Upper Street  
London N1 1XR  
Tel: 020 7527 3031  
Email: [licensing@islington.gov.uk](mailto:licensing@islington.gov.uk)

\_\_\_\_\_  
Service Director - Public Protection

\_\_\_\_\_  
Date of Issue

### **Annex 1 - Mandatory conditions**

1. No supply of alcohol may be made under the premises licence-
  - a) at a time when there is no designated premises supervisor in respect of the premises licence, or
  - b) at a time when the designated premises supervisor does not hold a personal licence or his personal licence is suspended.
2. Every supply of alcohol under the premises licence must be made or authorised by a person who holds a personal licence.

### **Annex 2 - Conditions consistent with the Operating Schedule**

- 1)
  - a) during the first 20 minutes after the above hours, the taking of the alcohol from the premises, unless the alcohol is supplied or taken in an open vessel;
  - b) the ordering of alcohol to be consumed off the premises, or the despatch by the vendor of alcohol so ordered;
  - c) the sale of alcohol to a trader or club for the purposes of the trade or club;
  - d) the sale of supply of alcohol to any canteen or mess, being a canteen in which the sale or supply of alcohol is carried out under the authority of the Secretary of State or an authorised mess of members of Her Majesty's naval military.
- 2) Alcohol shall not be sold in an open container or be consumed in the licensed premises

### **Annex 3 - Conditions attached after a hearing by the licensing authority**

Nil

### **Annex 4 – Plans:- SC/JR/N1**

**Suggested conditions of approval consistent with the operating schedule**

1. CCTV shall be installed, operated and maintained in agreement with the Police. The system will enable frontal identification of every person entering the premises. The system shall record in real time and operate whilst the premises are open for licensable activities. The recordings shall be kept available for a minimum of 31 days. Recordings shall be made available to an Authorised Officer or a Police Officer (subject to the Data Protection Act 1998) within 24 hours of any request.
2. No alcoholic goods will be purchased from sellers cold calling at the Premises.
3. The licensee will immediately report to Trading Standards any instance of a caller to the shop attempting to sell alcohol.
4. Invoices (or copies) for all alcoholic goods on the premises will be kept at the shop and made available to officers from the council, police or HMRC upon request.
5. A stock control system will be introduced, so that thy licensee can quickly identify where and when alcoholic goods have been purchased.
6. An ultra violet light will be made available at the premises for the purpose of checking the UK Duty Stamp on spirits as soon as practical after they have been purchased.
7. If any spirits bought by the business have UK Duty Stamps that do not fluoresce under the ultra-violet light, or are otherwise suspicious, the licensee shall identify this supplier to Islington Trading Standards and HMRC as soon as possible.
8. No spirits shall be purchased in a resealed box.
9. Refuse such as bottles must be placed into receptacles outside the premises at times that will minimise the disturbance to nearby properties.
10. Prominent, clear and legible notices must be displayed at all exits requesting the public to respect the needs of local residents and to leave the premises and the area quietly.
11. The licensee shall adopt "Challenge 25", the Retail of Alcohol Standards Group`s advice for off-licences, and promote it through the display of posters.
12. The licensee shall require staff to note any refusals to sell to young people in a refusals log. The refusals log shall be checked and signed monthly by the designated premises supervisor. The refusals log shall be made available for inspection upon request by the licensing team, police or trading standards.
13. The licensee shall ensure that staff are trained about age restricted products and ensure that they sign to confirm that they have understood the training. The training will include the assessment of age; making a challenge; acceptable proof of age; and recording refusals. The licensee shall keep records of training and instruction given to staff and make them available for inspection upon request by the licensing team, police or trading standards.

**Suggested conditions of approval recommended by Health and Safety Officer**

- (1) In addition to the lighting, emergency lighting in compliance with BS 5266 – 1 should be provided in the parts of the premises specified below:
  - Trading area of the shop so all gangways are clearly illuminated.
  - Ground floor staff only area.
  - The whole of the basement area and exit routes from the basement.

**Note:** Non-maintained emergency lighting should be wired to the local lighting circuit in such a manner as to operate not only in the event of failure of the mains supply but also on failure of the supply to the local lighting circuit.

- (2) A fire alarm and fire detection system type L2 in accordance with BS 5839 – 1 should be provided throughout all areas of the premises.

Details of your proposals for the fire alarm and fire detection system should be submitted for consideration and approval.

- (3) Graphic symbol exit signs in compliance with the Health and Safety (Safety Signs and Signals) Regulations should be provided:
- On the basement emergency exit doors.
  - Over the ground floor entrance/exit doors and graphic symbol exit route signs indicating the escape route to the entrance/exit doors should be suspended from the ceiling within the shop.
- (4) A sign worded **Fire escape keep clear** should be fixed on the outside of the basement emergency exit doors.
- (5) A sign worded **Private** or **Staff only** should be fixed on the door which leads down into the basement.
- (6) The basement emergency exit doors should be free from fastenings or secured with simple fastenings that can be readily operated without having to use two hands, keys, cards, codes or similar means when the premises are occupied.
- (7) One water or foam fire extinguisher (rating 13A) and one carbon dioxide fire extinguisher (rating 34B) should be provided in the following locations:
- Ground floor – Behind or adjacent to the cashiers/sales counter.
  - Basement – Adjacent to the emergency exit doors.

Fire extinguishers should be on brackets or stands and located so as not to obstruct exit routes or cause a hazard to persons in and about the premises.

Appropriate signs should be fixed adjacent to the fire extinguishers indicating the type of fire fighting appliance and the class of fire covered.

- (8) Mechanical extract ventilation should be installed in the basement toilet extracting direct to external air at a rate of not less than 6 litres/second. The extract fan should have a 15 minute over-run controlled by the light switch or occupant detecting sensor. Air inlet to the toilet should be provided, e.g. 10mm gap under the door.
- (9) Copies of the inspection and test certificates specified below, certified by an approved competent person, should be submitted to the responsible authority for health and public safety.
- Emergency lighting
  - Fire alarm
  - Fire fighting appliances

An approved competent person for the testing and certification of electrical installations and emergency lighting should be one of the following:

- (i) A qualified member of the Institution of Engineering and Technology, or

- (ii) A contractor enrolled with the National Inspection Council for Electrical Installation Contracting, or a member of the Electrical Contractors Association, or a competent person from an appropriate approved organisation.

For fire alarms any of the above, or

A member of the Loss Prevention Council 1014 Scheme, or a member of the British Approvals for Fire Equipment SP203 Scheme.

Inspection and service certificates for fire fighting appliances should be obtained from an organisation certified by the British Approvals for Fire Equipment (BAFE), or a competent person from an appropriate approved organisation.

