



Report of: **Service Director, Public Protection**

Meeting of	Date	Agenda Item	Ward(s)
Licensing Sub-Committee	13 th February 2013		Finsbury Park

Delete as appropriate		Non-exempt
-----------------------	--	------------

Subject: PREMISES LICENCE NEW APPLICATION

RE: EXPRESS FOOD STORE, 2-3 CLIFTON TERRACE, LONDON, N4 3JP

1. Synopsis

- 1.1 This is an application for a new premise licence under the Licensing Act 2003.
- 1.2 The new application is to:
 - i) permit the premises to sell alcohol, off supplies only, Mondays to Sundays for 24 hours a day.

2. Recommendations

- 2.1 To determine the application for a new premises licence under Section 17 of the Licensing Act 2003.

2.2 To consider the representation from the Police in the light of the revised Secretary of State Guidance to Local Authorities issued on 25th April 2012 namely:

The Licensing Authority should accept all reasonable and proportionate representations made by the Police unless the Authority has evidence that to do so would not be appropriate for the promotion of the Licensing Objectives.

2.3 If the Committee grants the application it should be subject to:

- i. conditions of the current premises licence;
- ii. conditions prepared by the Licensing Officer which are consistent with the Operating Schedule (See appendix 4);
- iii. conditions recommended by responsible Authorities (see appendix 4);
- iv. any conditions deemed necessary by the Committee to promote the four licensing objectives.

3. Background

3.1 Papers are attached as follows:-

- Appendix 1: application form;
Appendix 2: representations;
Appendix 3 current licence held at the location;
Appendix 4: suggested conditions and map of premise location.

3.2 There is a premise currently in effect at this location held by the applicant to permit the sale of alcohol on Monday to Sunday from 08:00 until 23:00.

3.3 The Licensing Team has received 3 letters of representation, from the Metropolitan Police, Licensing Authority and Public Health Authority.

4. Planning Implications

4.1 None.

5. Conclusion and reasons for recommendations

5.1 The Council is required to consider this application in the light of all relevant information, and if approval is given, it may attach such conditions necessary to promote the licensing objectives.

Background papers:

The Council's Statement of Licensing Policy
Licensing Act 2003
Secretary of States Guidance

Final Report Clearance

Signed by

Service Director – Public Protection

5-2-13
Date

Received by

Head of Scrutiny and Democratic Services

Date

Licensing Team

Tel: 020 75027 3031

Fax: 020 7527 3430

E-mail: licensing@islington.gov.uk

AF1

Application for a premises licence to be granted under the Licensing Act 2003

PLEASE READ THE FOLLOWING INSTRUCTIONS FIRST

Before completing this form please read the guidance notes at the end of the form. If you are completing this form by hand please write legibly in block capitals. In all cases ensure that your answers are inside the boxes and written in black ink. Use additional sheets if necessary.

You may wish to keep a copy of the completed form for your records.

I/We Mr RIZA BERKTAS

(Insert name(s) of applicant)

apply for a premises licence under section 17 of the Licensing Act 2003 for the premises described in Part 1 below (the premises) and I/we are making this application to you as the relevant licensing authority in accordance with section 12 of the Licensing Act 2003

Part 1 - Premises Details

Postal address of premises or, if none, ordnance survey map reference or description EXPRESS FOOD STORE 2-3 CLIFTON TERRACE			
		3/12/12	290.00
		100010	0652159
		AF1	
Post town	LONDON	Post code	N4 3JP

Telephone number at premises (if any)	
Non-domestic rateable value of premises	£17250

Part 2 - Applicant Details

Please state whether you are applying for a premises licence as
Please tick yes

- a) an individual or individuals * please complete section (A)
- b) a person other than an individual *
 - i. as a limited company please complete section (B)
 - ii. as a partnership please complete section (B)
 - iii. as an unincorporated association or please complete section (B)
 - iv. other (for example a statutory corporation) please complete section (B)
- c) a recognised club please complete section (B)
- d) a charity please complete section (B)

COMMERCIAL LICENSING
3 DEC 2012
PUBLIC PROTECTION DIVISION
LONDON

- e) the proprietor of an educational establishment please complete section (B)
- f) a health service body please complete section (B)
- g) a person who is registered under Part 2 of the Care Standards Act 2000 (c14) in respect of an independent hospital in Wales please complete section (B)
- ga) a person who is registered under Chapter 2 of Part 1 of the Health and Social Care Act 2008 (within the meaning of that Part) in an independent hospital in England please complete section (B)
- h) the chief officer of police of a police force in England and Wales please complete section (B)

* If you are applying as a person described in (a) or (b) please confirm:

Please tick yes

- I am carrying on or proposing to carry on a business which involves the use of the premises for licensable activities; or
- I am making the application pursuant to a
 - statutory function or
 - a function discharged by virtue of Her Majesty's prerogative

(A) INDIVIDUAL APPLICANTS (fill in as applicable)

Mr <input checked="" type="checkbox"/>	Mrs <input type="checkbox"/>	Miss <input type="checkbox"/>	Ms <input type="checkbox"/>	Other Title (for example, Rev)	
Surname BERKTAS			First names RIZA		
I am 18 years old or over				<input checked="" type="checkbox"/>	Please tick yes
Current postal address if different from premises address		6 TURNER HOUSE CORBAYN STREET			
Post Town	LONDON			Postcode	N4 3DD
Daytime contact telephone number					
E-mail address (optional)					

SECOND INDIVIDUAL APPLICANT (if applicable)

Mr <input type="checkbox"/>	Mrs <input type="checkbox"/>	Miss <input type="checkbox"/>	Ms <input type="checkbox"/>	Other Title (for example, Rev)	
Surname			First names		

I am 18 years old or over		<input type="checkbox"/> Please tick yes	
Current postal address if different from premises address			
Post Town		Postcode	
Daytime contact telephone number			
E-mail address (optional)			

(B) OTHER APPLICANTS

Please provide name and registered address of applicant in full. Where appropriate please give any registered number. In the case of a partnership or other joint venture (other than a body corporate), please give the name and address of each party concerned.

Name
Address
Registered number (where applicable)
Description of applicant (for example, partnership, company, unincorporated association etc.)
Telephone number (if any)
E-mail address (optional)

Part 3 Operating Schedule

When do you want the premises licence to start?

Day	Month	Year
<input type="text"/>	<input type="text"/>	<input type="text"/>

If you wish the licence to be valid only for a limited period, when do you want it to end?

Day	Month	Year
<input type="text"/>	<input type="text"/>	<input type="text"/>

Please give a general description of the premises (please read guidance note1)
SUPERMARKET

If 5,000 or more people are expected to attend the premises at any one time, please state the number expected to attend.

What licensable activities do you intend to carry on from the premises?

(Please see sections 1 and 14 of the Licensing Act 2003 and Schedules 1 and 2 to the Licensing Act 2003)

Provision of regulated entertainment

Please tick yes

- a) plays (if ticking yes, fill in box A)
- b) films (if ticking yes, fill in box B)
- c) indoor sporting events (if ticking yes, fill in box C)
- d) boxing or wrestling entertainment (if ticking yes, fill in box D)
- e) live music (if ticking yes, fill in box E)
- f) recorded music (if ticking yes, fill in box F)
- g) performances of dance (if ticking yes, fill in box G)
- h) anything of a similar description to that falling within (e), (f) or (g) (if ticking yes, fill in box H)

Provision of entertainment facilities:

- i) making music (if ticking yes, fill in box I)
- j) dancing (if ticking yes, fill in box J)
- k) entertainment of a similar description to that falling within (i) or (j) (if ticking yes, fill in box K)

Provision of late night refreshment (if ticking yes, fill in box L)

Supply of alcohol (if ticking yes, fill in box M)

In all cases complete boxes N, O and P

A

Plays Standard days and timings (please read guidance note 6)			Will the performance of a play take place indoors or outdoors or both – please tick (please read guidance note 2)	Indoors	<input type="checkbox"/>
				Outdoors	<input type="checkbox"/>
				Both	<input type="checkbox"/>
Day	Start	Finish	Please give further details here (please read guidance note 3)		
Mon					
Tue			State any seasonal variations for performing plays (please read guidance note 4)		
Wed					
Thur			Non standard timings. Where you intend to use the premises for the performance of plays at different times to those listed in the column on the left, please list (please read guidance note 5)		
Fri					
Sat					
Sun					

A

Form	Standard days and average (please read guidance note 6)	With the performance of a given take along INDICES OF OUTDOOR AIR QUALITY - please read guidance note 7)	Indoors
Day	Start	Finish	Indoors <input type="checkbox"/> Outdoors <input type="checkbox"/>
Mon		Please give further details here (please read guidance note 8)	Both <input type="checkbox"/>
Tue			
Wed		State any additional variations for performance data (please read guidance note 4)	
Thu			
Fri		Have a standard schedule. Where you intend to use the equipment for the duration of the performance of the equipment, please list the equipment in the column on the left. Please read guidance note 5)	
Sat			
Sun			

B

Form	Standard days and average (please read guidance note 6)	With the substitution of time take data indices of OUTDOOR AIR QUALITY - please read guidance note 7)	Indoors
Day	Start	Finish	Indoors <input type="checkbox"/> Outdoors <input type="checkbox"/>
Mon		Please give further details here (please read guidance note 8)	Both <input type="checkbox"/>
Tue			
Wed		State any additional variations for the substitution of time (please read guidance note 4)	
Thu			
Fri		Have a standard schedule. Where you intend to use the equipment for the duration of the performance of the equipment, please list the equipment in the column on the left. Please read guidance note 5)	
Sat			
Sun			

C

Form	Standard days and average (please read guidance note 6)	With the performance of a given take along INDICES OF OUTDOOR AIR QUALITY - please read guidance note 7)	Indoors
Day	Start	Finish	Indoors <input type="checkbox"/> Outdoors <input type="checkbox"/>
Mon		Please give further details here (please read guidance note 8)	Both <input type="checkbox"/>
Tue			
Wed		State any additional variations for the performance of the equipment (please read guidance note 4)	
Thu			
Fri		Have a standard schedule. Where you intend to use the equipment for the duration of the performance of the equipment, please list the equipment in the column on the left. Please read guidance note 5)	
Sat			
Sun			

D

Form	Standard days and average (please read guidance note 6)	With the performance of a given take along INDICES OF OUTDOOR AIR QUALITY - please read guidance note 7)	Indoors
Day	Start	Finish	Indoors <input type="checkbox"/> Outdoors <input type="checkbox"/>
Mon		Please give further details here (please read guidance note 8)	Both <input type="checkbox"/>
Tue			
Wed		State any additional variations for the performance of the equipment (please read guidance note 4)	
Thu			
Fri		Have a standard schedule. Where you intend to use the equipment for the duration of the performance of the equipment, please list the equipment in the column on the left. Please read guidance note 5)	
Sat			
Sun			

E

Form	Standard days and average (please read guidance note 6)	With the performance of a given take along INDICES OF OUTDOOR AIR QUALITY - please read guidance note 7)	Indoors
Day	Start	Finish	Indoors <input type="checkbox"/> Outdoors <input type="checkbox"/>
Mon		Please give further details here (please read guidance note 8)	Both <input type="checkbox"/>
Tue			
Wed		State any additional variations for the performance of the equipment (please read guidance note 4)	
Thu			
Fri		Have a standard schedule. Where you intend to use the equipment for the duration of the performance of the equipment, please list the equipment in the column on the left. Please read guidance note 5)	
Sat			
Sun			

F

Form	Standard days and average (please read guidance note 6)	With the performance of a given take along INDICES OF OUTDOOR AIR QUALITY - please read guidance note 7)	Indoors
Day	Start	Finish	Indoors <input type="checkbox"/> Outdoors <input type="checkbox"/>
Mon		Please give further details here (please read guidance note 8)	Both <input type="checkbox"/>
Tue			
Wed		State any additional variations for the performance of the equipment (please read guidance note 4)	
Thu			
Fri		Have a standard schedule. Where you intend to use the equipment for the duration of the performance of the equipment, please list the equipment in the column on the left. Please read guidance note 5)	
Sat			
Sun			

G

Performance of facilities for cleaning standard days and nights (please read guidance note 6)		<input type="checkbox"/> Indoors <input type="checkbox"/> Outdoors <input type="checkbox"/> Both	
Day	Start	Finish	
Mon			
Tue			
Wed			
Thu			
Fri			
Sat			
Sun			
<p>Will the performance of cleaning be indoors or outdoors or both - please tick (please read guidance note 2)</p> <p>Please give further details here (please read guidance note 3)</p> <p>State any seasonal variations for the performance of cleaning (please read guidance note 4)</p> <p>Non standard hours - Where you intend to use the premises for the purpose of entertainment, please state the dates and times in the column on the left, please tick (please read guidance note 5)</p>			

H

Provision of a facility for entertainment (please read guidance note 6)		<input type="checkbox"/> Indoors <input type="checkbox"/> Outdoors <input type="checkbox"/> Both	
Day	Start	Finish	
Mon			
Tue			
Wed			
Thu			
Fri			
Sat			
Sun			
<p>Please give a description of the type of entertainment you will be providing</p> <p>Will this entertainment take place indoors or outdoors or both - please tick (please read guidance note 2)</p> <p>Please give further details here (please read guidance note 3)</p> <p>State any seasonal variations for entertainment of a limited description to that falling within (a), (b) or (c) (please read guidance note 4)</p> <p>Non standard hours - Where you intend to use the premises for the purpose of entertainment, please state the dates and times in the column on the left, please tick (please read guidance note 5)</p>			

I

Provision of facilities for entertainment (please read guidance note 6)		<input type="checkbox"/> Indoors <input type="checkbox"/> Outdoors <input type="checkbox"/> Both	
Day	Start	Finish	
Mon			
Tue			
Wed			
Thu			
Fri			
Sat			
Sun			
<p>Please give a description of the facilities for making music you will be providing</p> <p>Will this entertainment take place indoors or outdoors or both - please tick (please read guidance note 2)</p> <p>Please give further details here (please read guidance note 3)</p> <p>State any seasonal variations for the provision of facilities for making music (please read guidance note 4)</p> <p>Non standard hours - Where you intend to use the premises for the purpose of entertainment, please state the dates and times in the column on the left, please tick (please read guidance note 5)</p>			

J

Provision of facilities for cleaning standard days and nights (please read guidance note 6)		<input type="checkbox"/> Indoors <input type="checkbox"/> Outdoors <input type="checkbox"/> Both	
Day	Start	Finish	
Mon			
Tue			
Wed			
Thu			
Fri			
Sat			
Sun			
<p>Will the facilities for cleaning be indoors or outdoors or both - please tick (please read guidance note 2)</p> <p>Please give a description of the facilities for cleaning you will be providing</p> <p>Please give further details here (please read guidance note 3)</p> <p>State any seasonal variations for providing cleaning facilities (please read guidance note 4)</p> <p>Non standard hours - Where you intend to use the premises for the purpose of entertainment, please state the dates and times in the column on the left, please tick (please read guidance note 5)</p>			

K

Provision of a facility for entertainment (please read guidance note 6)		<input type="checkbox"/> Indoors <input type="checkbox"/> Outdoors <input type="checkbox"/> Both	
Day	Start	Finish	
Mon			
Tue			
Wed			
Thu			
Fri			
Sat			
Sun			
<p>Please give a description of the type of entertainment facility you will be providing</p> <p>Will this entertainment take place indoors or outdoors or both - please tick (please read guidance note 2)</p> <p>Please give further details here (please read guidance note 3)</p> <p>State any seasonal variations for the provision of facilities for entertainment of a limited description to that falling within (a), (b) or (c) (please read guidance note 4)</p> <p>Non standard hours - Where you intend to use the premises for the purpose of entertainment, please state the dates and times in the column on the left, please tick (please read guidance note 5)</p>			

L

Provision of facilities for entertainment (please read guidance note 6)		<input type="checkbox"/> Indoors <input type="checkbox"/> Outdoors <input type="checkbox"/> Both	
Day	Start	Finish	
Mon			
Tue			
Wed			
Thu			
Fri			
Sat			
Sun			
<p>Will the provision of facilities for entertainment take place indoors or outdoors or both - please tick (please read guidance note 2)</p> <p>Please give further details here (please read guidance note 3)</p> <p>State any seasonal variations for the provision of entertainment (please read guidance note 4)</p> <p>Non standard hours - Where you intend to use the premises for the purpose of entertainment, please state the dates and times in the column on the left, please tick (please read guidance note 5)</p>			

M

Supply of alcohol Standard days and timings (please read guidance note 6)			Will the supply of alcohol be for consumption (Please tick box) (please read guidance note 7)	On the premises	<input type="checkbox"/>
				Off the premises	<input checked="" type="checkbox"/>
				Both	<input type="checkbox"/>
Day	Start	Finish	State any seasonal variations for the supply of alcohol (please read guidance note 4) NONE		
Mon	00:00	00:00			
Tue	00:00	00:00			
Wed	00:00	00:00			
Thur	00:00	00:00			
Fri	00:00	00:00			
Sat	00:00	00:00			
Sun	00:00	00:00			
			Non standard timings. Where you intend to use the premises for the supply of alcohol at different times to those listed in the column on the left, please list (please read guidance note 5) NONE		

State the name and details of the individual whom you wish to specify on the licence as premises supervisor

Name Mr RIZA BERKTAS	
Address 6 TURNER HOUSE CORBAYN STREET LONDON	
Postcode	N4 3DD
Personal Licence number (if known) 93793	
Issuing licensing authority (if known) LONDON BOROUGH OF ISLINGTON	

N

Please highlight any adult entertainment or services, activities, other entertainment or matters ancillary to the use of the premises that may give rise to concern in respect of children (please read guidance note 8)
 N/A

O

Hours premises are open to the public Standard days and timings (please read guidance note 6)			State any seasonal variations (please read guidance note 4) NONE
Day	Start	Finish	Non standard timings. Where you intend the premises to be open to the public at different times from those listed in the column on the left, please list (please read guidance note 5) NONE
Mon	00:00	00:00	
Tue	00:00	00:00	
Wed	00:00	00:00	
Thur	00:00	00:00	
Fri	00:00	00:00	
Sat	00:00	00:00	
Sun	00:00	00:00	

P Describe the steps you intend to take to promote the four licensing objectives:

a) General – all four licensing objectives (b,c,d,e) (please read guidance note 9)

- STAFF TO BE TRAINED REGULARLY ON LICENSING PROVISIONS AND THIS TO BE DOCUMENTED.

b) The prevention of crime and disorder

- ALL INSTANCES OF CRIME AND DISORDER SHALL BE REPORTED TO THE POLICE.
- AN INCIDENT BOOK SHALL BE USED TO RECORD ALL INSTANCES OF PUBLIC DISORDER.
- CCTV SHALL BE INSTALLED, OPERATED AND MAINTAINED IN AGREEMENT WITH THE POLICE. THE SYSTEM WILL ENABLE FRONTAL IDENTIFICATION OF EVERY PERSON ENTERING THE PREMISES. THE SYSTEM SHALL RECORD IN REAL TIME AND OPERATE WHILST THE PREMISES ARE OPEN FOR LICENSABLE ACTIVITIES. THE RECORDINGS SHALL BE KEPT AVAILABLE FOR A MINIMUM OF 31 DAYS. RECORDINGS SHALL BE MADE AVAILABLE TO AN AUTHORISED OFFICER OR A POLICE OFFICER (SUBJECT TO THE DATA PROTECTION ACT 1998) WITHIN 24 HRS OF ANY REQUEST.

c) Public safety

- TO COMPLY WITH THE FIRE REGULATIONS AND THE PROVISIONS OF THE MANAGEMENT REGULATIONS.
- MAINTAIN AND CHECK SYSTEMS IN PLACE, SMOKE DETECTORS, FIRE EXTINGUISHERS, EMERGENCY SAFETY LIGHTING AND FIRE ALARMS.

d) The prevention of public nuisance

DISCOURAGE NOISE FROM PATRONS ARRIVING AT, QUEUING OR DEPARTING FROM THE PREMISES BY DISPLAYING POLITE NOTICES FOR CUSTOMERS' ATTENTION.

e) The protection of children from harm

- THE LICENSEE SHALL ADOPT THE CHALLENGE 25, THE RETAIL OF ALCOHOL STANDARDS GROUP'S ADVICE FOR OFF-LICENSES.
 - THE LICENSEE SHALL ENSURE THAT STAFF ARE TRAINED ABOUT AGE RESTRICTED PRODUCTS AND ENSURE THAT THEY SIGN TO CONFIRM THAT THEY HAVE UNDERSTOOD THE TRAINING. THE LICENSEE SHALL KEEP RECORDS OF TRAINING AND INSTRUCTION GIVEN TO STAFF.
 - THE LICENSEE SHALL PUT ARRANGEMENTS IN PLACE TO ENSURE THAT BEFORE SERVING ALCOHOL TO YOUNG PERSONS, STAFF ASK TO SEE ACREDITED PROOF OF AGE CARDS FOR EXAMPLE PROOF OF AGE CARDS CARRYING THE 'PASS' LOGO, A PASSPORT, OR UK DRIVERS LICENCE BEARING THE PHOTOGRAPH AND THE DATE OF BIRTH OF THE BEARER.
 -THE LICENSEE SHALL REQUIRE STAFF TO NOTE ANY REFUSALS TO SELL TO YOUNG PEOPLE IN A REFUSALS LOG.

Please tick yes

- I have made or enclosed payment of the fee
- I have enclosed the plan of the premises
- I have sent copies of this application and the plan to responsible authorities and others where applicable
- I have enclosed the consent form completed by the individual I wish to be premises supervisor, if applicable
- I understand that I must now advertise my application
- I understand that if I do not comply with the above requirements my application will be rejected

IT IS AN OFFENCE, LIABLE ON CONVICTION TO A FINE UP TO LEVEL 5 ON THE STANDARD SCALE, UNDER SECTION 158 OF THE LICENSING ACT 2003 TO MAKE A FALSE STATEMENT IN OR IN CONNECTION WITH THIS APPLICATION

Part 4 – Signatures (please read guidance note 10)

Signature of applicant or applicant's solicitor or other duly authorised agent (See guidance note 11). **If signing on behalf of the applicant please state in what capacity.**

Signature	<i>Turner</i>
Date	<i>25/11/2012</i>
Capacity	AGENT

For joint applications signature of 2nd applicant or 2nd applicant's solicitor or other authorised agent. (please read guidance note 12). **If signing on behalf of the applicant please state in what capacity.**

Signature	
Date	

Capacity	
----------	--

Contact name (where not previously given) and postal address for correspondence associated with this application (please read guidance note 13) MR TURABI AY A.ANVA LTD 109 BAWDSEY AVENUE			
Post town	ILFORD	Post code	IG2 7TN
Telephone number (if any)	02085995036		
If you would prefer us to correspond with you by e-mail your e-mail address (optional) INFO@A-ANVA.CO.UK			

Notes for Guidance

1. Describe the premises. For example the type of premises, its general situation and layout and any other information which could be relevant to the licensing objectives. Where your application includes off-supplies of alcohol and you intend to provide a place for consumption of these off-supplies you must include a description of where the place will be and its proximity to the premises.
2. Where taking place in a building or other structure please tick as appropriate. Indoors may include a tent.
3. For example the type of activity to be authorised, if not already stated, and give relevant further details, for example (but not exclusively) whether or not music will be amplified or unamplified.
4. For example (but not exclusively), where the activity will occur on additional days during the summer months.
5. For example (but not exclusively), where you wish the activity to go on longer on a particular day e.g. Christmas Eve.
6. Please give timings in 24 hour clock (e.g. 16:00) and only give details for the days of the week when you intend the premises to be used for the activity.
7. If you wish people to be able to consume alcohol on the premises please tick on, if you wish people to be able to purchase alcohol to consume away from the premises please tick off. If you wish people to be able to do both please tick both.
8. Please give information about anything intended to occur at the premises or ancillary to the use of the premises which may give rise to concern in respect of children, regardless of whether you intend children to have access to the premises, for example (but not exclusively) nudity or semi-nudity, films for restricted age groups, the presence of gaming machines.
9. Please list here steps you will take to promote all four licensing objectives together.
10. The application form must be signed.
11. An applicant's agent (for example solicitor) may sign the form on their behalf provided that they have actual authority to do so.
12. Where there is more than one applicant, both applicants or their respective agents must sign the application form.
13. This is the address which we shall use to correspond with you about this application.

Consent of individual to being specified as premises supervisor

I MR RIZA BERKATAS
[full name of prospective premises supervisor]

of 6 TURNER HOUSE, CORRYN STREET
LONDON N4 3DD

[home address of prospective premises supervisor]

hereby confirm that I give my consent to be specified as the designated premises supervisor in relation to the application for

PREMISES LICENCE [type of application]

by MR RIZA BERKATAS [name of applicant]

relating to a premises licence [number of existing licence, if any]

for EXPRESS FOOD STORE, 2-3 CLIFTON TERRACE
LONDON N4 3JP

[name and address of premises to which the application relates]

and any premises licence to be granted or varied in respect of this application made

by MR RIZA BERKATAS [name of applicant]

concerning the supply of alcohol at EXPRESS FOOD STORE
2-3 CLIFTON TERRACE, LONDON N4 3JP

[name and address of premises to which application relates].

I also confirm that I am applying for, intend to apply for or currently hold a personal licence, details of which I set out below.

Personal licence number 913793
[insert personal licence number, if any]

Personal licence issuing authority SLINGTON
[insert name and address and telephone number of personal licence issuing authority, if any]

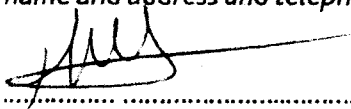
 signed

RIZA BERKATAS name (please print)

25/11/2012 dated

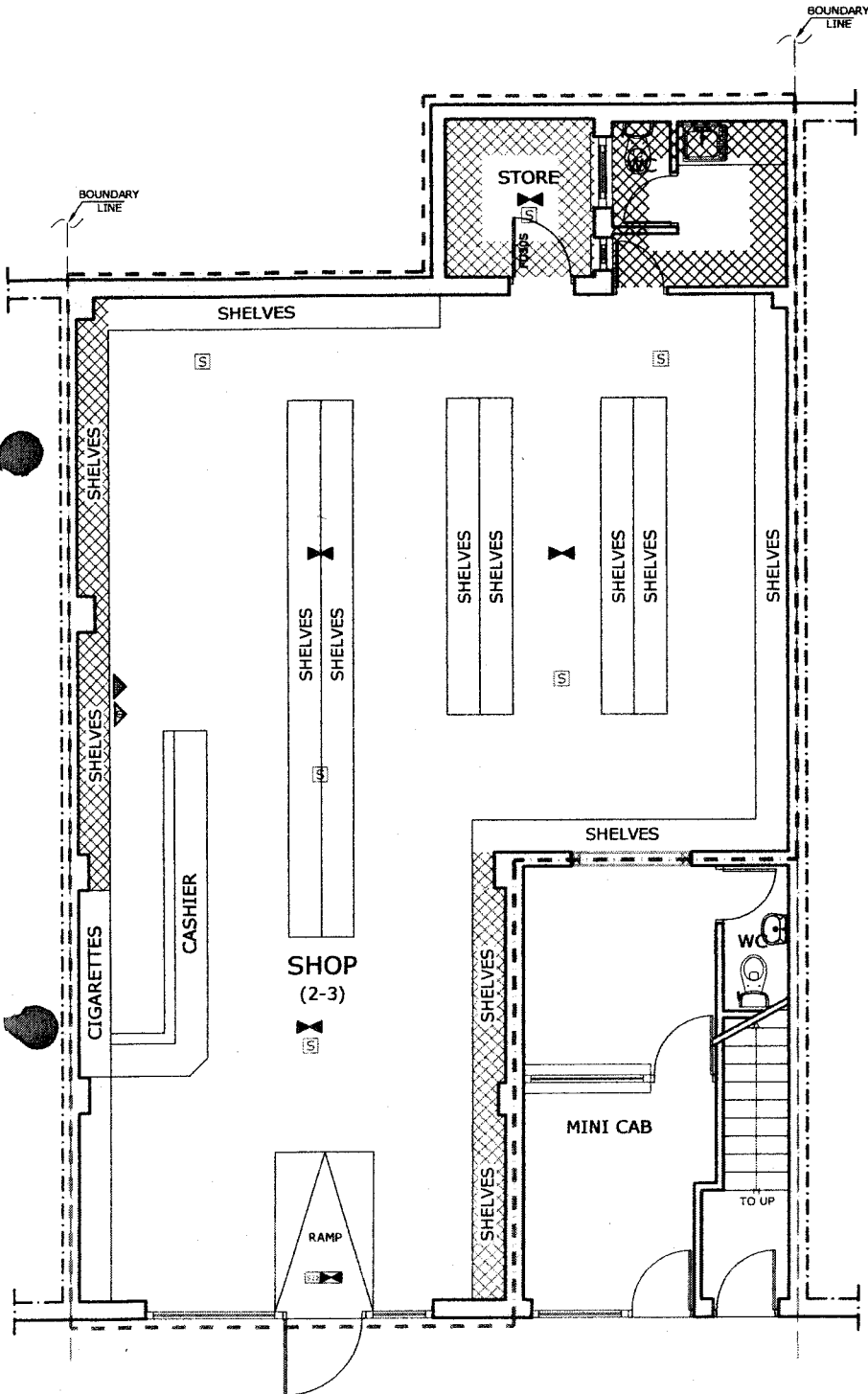

GROUND FLOOR PLAN
SCALE: 1/100

LEGEND

- AMBIT OF LICENSED PREMISES
- LIQUOR SALES
- STORAGE
- WC, PASSAGEWAY, ETC
- SAFETY LIGHTING
- SMOKE DETECTOR
- CARBON DIOXIDE FIRE EXTINGUISHER
- 9 LT. WATER FIRE EXTINGUISHER
- INTERNALLY ILLUMINATED FIRE ESCAPE SIGN (BS 5266)
- 30min FIRE RESISTANCE DOOR (FIRE DOOR TO HAVE INTUMESCENT STRIPS AND SELF CLOSER)
- AMBIT OF PREMISES

SHOP AREA: 123.30 m2

THE CONTENTS OF THIS PLAN INCLUDING THE PRINTED NOTES ARE COPYRIGHT AND REPRODUCTION IN WHOLE OR PART IS NOT PERMITTED WITHOUT PRIOR CONSENT OF A.ANVA LTD. IN WRITING

EXPRESS FOOD STORE
2-3 CLIFTON TERRACE
LONDON N4 3JP

GROUND FLOOR PLAN

SCALE: 1/100	REF. NO: 139.12/01
DATE: NOV. 12	DRG BY: A.AY

A.ANVA LTD.

P.O. BOX 1827
ILFORD. IG2 7WJ
TEL: 020 8599 5036 FAX: 020 8586 4401
MOBILE: 077 10942923 / 079 30407212
E-MAIL: info@a-anva.co.uk

Forde, Niall

From: Don.Stewart@met.pnn.police.uk
Sent: 19 December 2012 06:50
To: Licensing
Cc: info@a-anva.co.uk
Subject: Express Food Store Alcohol Profile - Nov11-Oct12
Attachments: Express Food Store Alcohol Profile - Nov11-Oct12.doc

<<Express Food Store Alcohol Profile - Nov11-Oct12.doc>>

Please find attached Police representation to Express Food Store.

Regards

Robin Clark Ps 45NI
Licensing Sergeant
Islington Police.

Tel - 0207 421 0248
Email - Ni_Licensing@Met.Police.Uk

Total Policing is the Met's commitment to be on the streets and in your communities to catch offenders, prevent crime and support victims. We are here for London, working with you to make our capital safer.

Consider our environment - please do not print this email unless absolutely necessary.

NOTICE - This email and any attachments may be confidential, subject to copyright and/or legal privilege and are intended solely for the use of the intended recipient. If you have received this email in error, please notify the sender and delete it from your system. To avoid incurring legal liabilities, you must not distribute or copy the information in this email without the permission of the sender. MPS communication systems are monitored to the extent permitted by law. Consequently, any email and/or attachments may be read by monitoring staff. Only specified personnel are authorised to conclude any binding agreement on behalf of the MPS by email. The MPS accepts no responsibility for unauthorised agreements reached with other employees or agents. The security of this email and any attachments cannot be guaranteed. Email messages are routinely scanned but malicious software infection and corruption of content can still occur during transmission over the Internet. Any views or opinions expressed in this communication are solely those of the author and do not necessarily represent those of the Metropolitan Police Service (MPS).

Find us at:

Facebook: [Facebook.com/metpoliceuk](https://www.facebook.com/metpoliceuk)

Twitter: [@metpoliceuk](https://twitter.com/metpoliceuk)

Key Issues

The figures for below highlight some of the key issues linked to alcohol and the night time economy within 500m of Express Food Store. Offences listed have occurred during the hours of 8pm to 6am between November 2011-October 2012.

- There were 156 violent offences, including:
 - 3 woundings
 - 22 GBH
 - 4 threats to kill
- There were 371 property crimes, including 45 personal robberies.

Borough Comparison Figures

The figures below show borough wide statistics for alcohol violence, alcohol related offences, and 999 calls with an **alcohol qualifier**. The time period in question is November 2011-October 2012 unless stated:

- There were 714 violent offences involving alcohol.
- The borough suffered 1563 crimes with alcohol as a contributing factor.
- Police were called to 702 emergency calls involving alcohol.
- There were 1861 violence offences between the hours of 2000-0600.
- There were 6977 property crime offences between the hours of 2000-0600.
- The London Ambulance Service attended 1272 incidents in Islington between Oct 2011 and Sep 2012 where alcohol was recorded as a feature.
- Islington has a known cohort of street drinkers. These individuals often congregate in favoured places such as particular parks or areas of street pavement. Between Oct 2011-Sep 2012, outreach teams recorded a total of 230 contacts with street drinkers across the borough.



Alcohol Issues - LBI Only

London Ambulance data indicates that between October 2011 and September 2012 (most recent data available) ambulances were called to 65 incidents in the area (Islington only) where alcohol was noted as a feature. Data mapped according to output areas highlights the Seven Sisters Road/Finsbury Park LT area. Note no data was available for areas outside Islington.

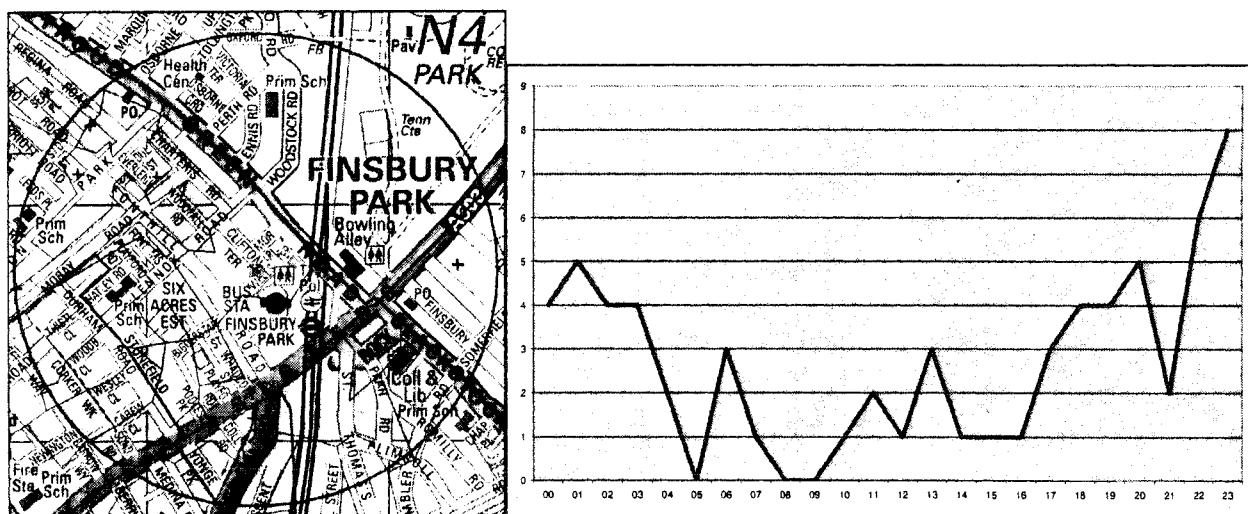

Temporal data for the town centre indicates that alcohol related attendances peaked between 22:00-01:00 hours over the period. The general trend data indicates that call out levels were higher in the hours around/following midnight.

Outreach

No outreach data available for this area.

999 Calls - Alcohol Qualifiers

The tables below show areas of high 999 call activity within the defined area that include an alcohol qualifier in the report, along with main call types and peak days/times:

CAD Call Type	Total
Police activity	6
Concern for safety	3
Contact	3
Robbery	2
Illness/injury	2
RTC - injury	1
Nuisance vehicle	1
Animal problems	1
Trespass	1
Domestic incident	1
Assistance required	1
Grand Total	52

	Mon	Tue	Wed	Thu	Fri	Sat	Sun	Total
0800-1159			1				3	4
1200-1559				2	1	1		4
1600-1959	2		1		2		2	
2000-2359	1			1	1		2	9
0000-0359	2	2	1		3			
0400-0759	1		1	1		3	1	7
Total	6	6	4	8	7		8	52

Calls regarding rowdy behaviour and violent offences are most frequent here. Saturday is the peak day, with peak times between 1600-2000 and 0000-0400 hours. Alcohol related calls in this area equates to 7.4% of the borough total overall.



Alcohol Related Crime

The maps and tables below show locations and hotspot areas for all alcohol related crime offences, and a breakdown of crime types and peak days/times:

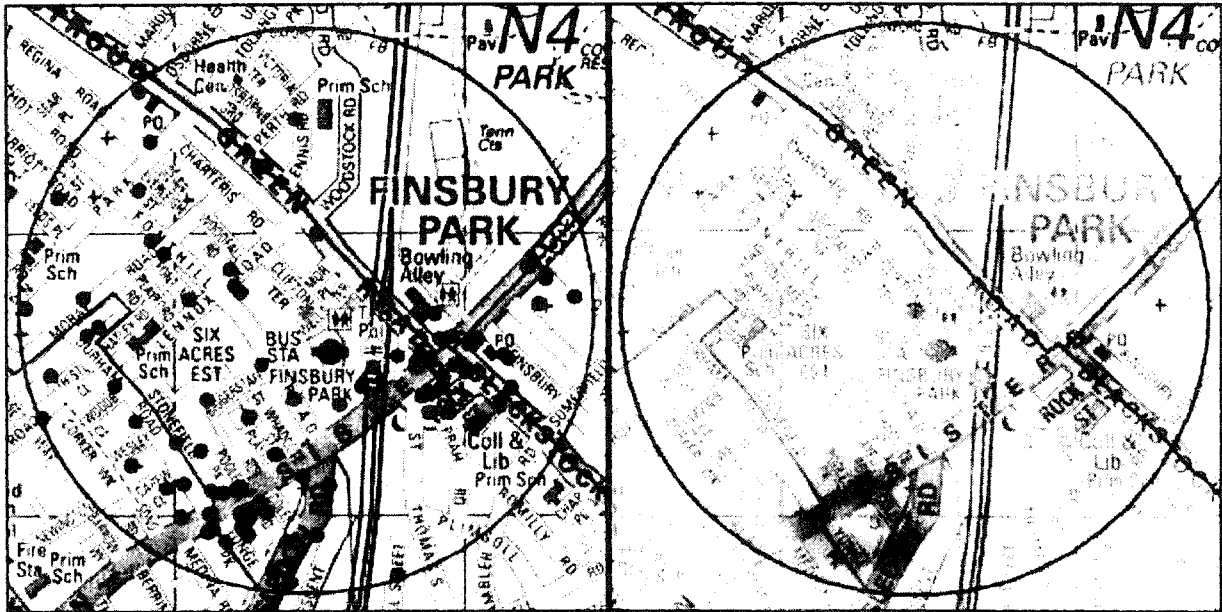

The area Seven Sisters Road/Isledon Road is the densest hotspot area.

Offence	Total
Common Assault	14
Rob pers	7
Spec Investing	7
Crime Related Incident	6
Sex Ass F	5
Crim Dam >£499	4
GBH/Wound	4
Shoplift <£200	4
Theft dwell	4
Ass Pol	3
Crim Dam <£500	3
GBH W/I	3
Other theft	3
Pub Order S 4	3
Other offence	25
Grand Total	112

	Mon	Tue	Wed	Thu	Fri	Sat	Sun	Total
0800-1159	1	1			1		3	6
1200-1559	1		3		3	2	1	10
1600-1959	2	2	2	4	3	7		20
2000-2359	3	3	3	2	4	4	3	22
0000-0359	4	3	1	5	4			
0400-0759					2	2	9	13
Total	11	9	9	11	17			112

ABH, and common assault are the most frequent offences. Friday-Sunday are the busiest days overall, with peak times being between 1600-0400 hours. Alcohol related crime in this area equates to 7.2% of the borough total.



Alcohol Related Violence

The maps and tables below show locations and hotspot areas for alcohol related violent crime offences within 500m of Express Food Store PH, and a breakdown of crime types and peak days/times:

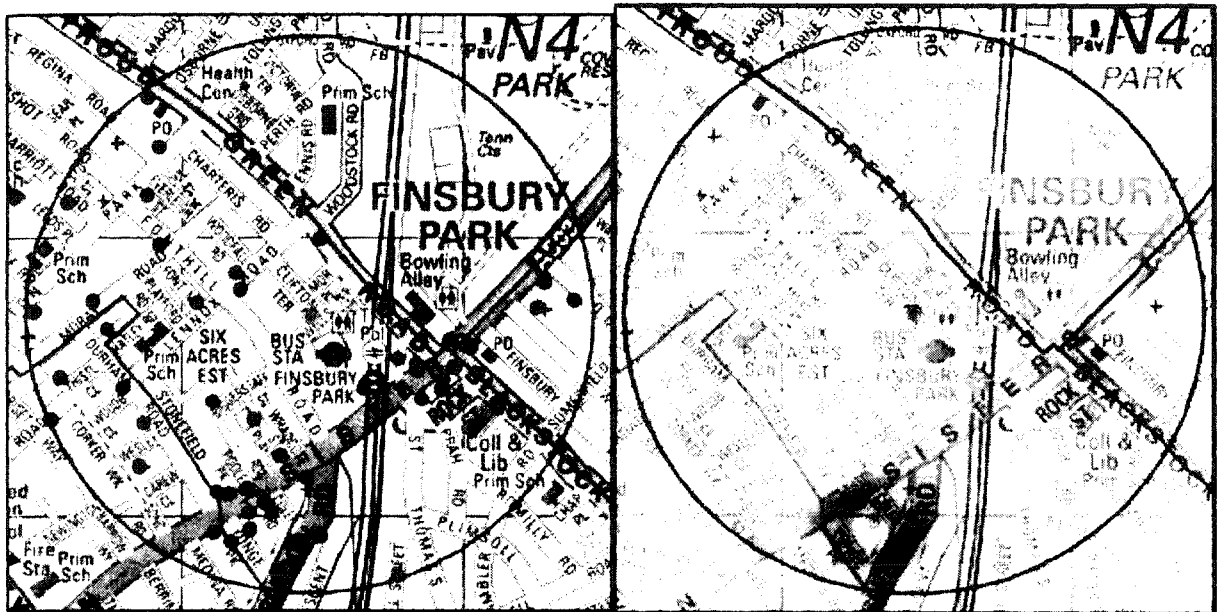

Most offences are located around Seven Sisters Road/Isledon Road area.

Offences	Total
Common Assault	14
GBH/Wound	4
Ass Pol	3
GBH W/I	3
Pub Order S 4	3
Race Dis	2
Racial Agg Ass	2
Child Cruelty	1
Crime Related Incident	1
False Imp	1
Harassment	1
Rac ABH/MWound	1
Racial Agg F/V	1
Racial Agg Har	1
Spec Investing	1
Grand Total	56

	Mon	Tue	Wed	Thu	Fri	Sat	Sun	Total
0800-1159	1	1					3	5
1200-1559			1		3	2		6
1600-1959	2	1			2	3		8
2000-2359	1	3	1	2		2	2	15
0000-0359	1	2	1	2	3			12
0400-0759						1	3	4
Total	5	7	3	4	12		12	56

ABH and common assault are the most frequent types of alcohol violence. Friday-Sunday are the peak days overall, with peak times between 2000-0400 hours. Alcohol related violence in this area equates to 7.8% of the borough total.



Licensed Premises within 500m of Express Food Store PH

The map below shows licensed premises within 500m of Express Food Store according to MapInfo Points of Interest dataset:

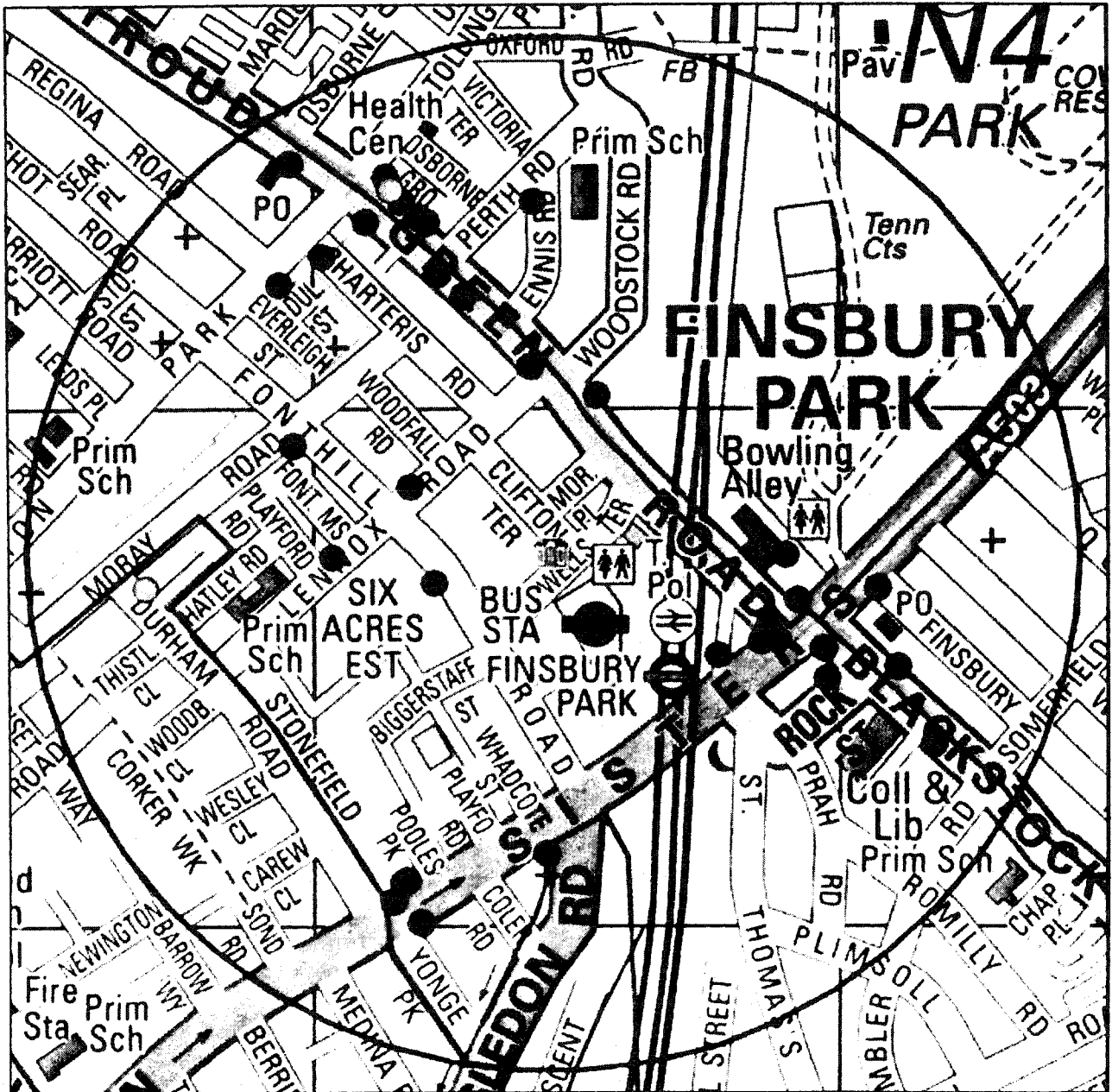

There are 11 pubs, 24 restaurants, 2 [unclear], and no [unclear] in this area.

I formally oppose the granting of this licence application on behalf of Islington Police. This statement provides the rationale for my decision.

Over recent years Islington has experienced rapid growth in its night time economy. The cumulative effect of this is a heavy footfall of persons who are not resident in Islington Borough but who are present between the hours of 8pm and 6am to take advantage of the extremely vibrant night-time economy.

Unfortunately there has not been commensurate increase in public services. Each new license or extension of an existing license will create additional demand on a range of public services. There is a direct link between the number of persons in public places who have consumed alcohol and the number of violent assaults that take place in that public place. This 'new' business for the police will involve reporting and investigating more instances of theft, anti social behaviour, drunkenness and serious assaults. No additional police resource will be available to cope with this extra demand. More people will be the victims of crime and more people will be injured.

The number of Police personnel available both in terms of uniform deterrence and investigative capacity is at its lowest between the hours of 11pm and 8am. At a time when both Police resources are being severely squeezed long with the resources available to NHS I would strongly resist increasing the number of persons who have consumed alcohol onto the streets of Islington. I have dwindling resources to deal with the consequences. The average investigation into an allegation of Grievous Bodily Harm costs Islington Police £2000 to investigate. Last year Islington investigated over 350 such crimes. This takes no account of the costs to the NHS. It also takes no account of the thousands of alcohol-related Actual Bodily Harm and Common Assault investigations that are taken on by Islington Police every year.

In an area that is already saturated with Licensed Premises it is just not sustainable to keep increasing the number of people on those streets after midnight. No matter how well any establishment is run internally their very business case is based on growing the number of people who end up on the streets of Islington having been drinking. As local public services are already stretched then the inevitable consequence of granting more post-midnight licences is an increase in the number of victims of serious violence. I would ask that the licence application be rejected.

**Detective Chief Inspector Steven Wallace
Islington Police**



Express Food Store Area (500m Radius)- Alcohol Related Crime:
November 2011-October 2012

Contents Page

1. Statement from DCI Wallace.....	2
2. Licensed Premises Map.....	3
3. Alcohol Related Violence.....	4
4. Alcohol Related Crime.....	5
5. Alcohol Related 999 Calls.....	6
6. London Ambulance Calls.....	7
7. Express Food Store Area Key Issues.....	8
8. Borough Comparison Figures.....	8

Licensing Act 2003**Representation from NHS North Central London (Islington Public Health) on behalf of health bodies providing services in Islington****Express Food Store, 2-3 Clifton Terrace, N4 3JP**

I am submitting a representation against the application to vary the premises license to permit the sale of alcohol 24 hours a day from the above premises. This representation is on behalf of NHS North Central London's Islington Public Health Department, which as a health body is a responsible authority.

The impact of alcohol is particularly great in Islington with some of the greatest levels of alcohol-related problems in London, including:

- The highest rate of alcohol-specific deaths in men in London
- One of the highest rates of alcohol-related hospital admissions in London
- Significantly higher levels of alcohol-related violent crime and claimants of incapacity benefit where main medical reason for being a claimant is alcoholism

Finsbury Park ward seems to particularly feel the affects of alcohol related harm and has higher rates of both alcohol-related and alcohol-specific hospital admissions.

The grounds for the representation are:

- Public safety
- Crime and disorder

The relevant policies in Islington's Licensing Policy

- Policy 23: Location, cumulative impact and saturation
- Policy 25: Shops selling alcohol

Express Food Store is located in Finsbury Park ward. This is an area which already has relatively high density of premises. Currently within Finsbury Park Ward there are:

- 85 premises licensed to sell alcohol, equivalent to one premises for every 127 residents aged 18 and over. This is close to the Islington average.
- 39 premises are licensed for off-sales of alcohol only (i.e. excluding on-licences that also sell alcohol for consumption off the premises), one for every 277 residents aged 18 and over in the ward, and 4th highest rate in Islington (the average is one per 390 in Islington)
- 10 off-licensed premises are licensed to sell alcohol for consumption 24 hours a day off the premises in Finsbury ward: one for every 1,079 residents (the average is one per 2,018 in Islington)

I am concerned that if this application is granted it will increase the availability of alcohol for consumption off premises. This could lead to an increase in public nuisance, crime and disorder and impact adversely on health of both those buying and consuming the alcohol but also the health of others who come in contact with them.

The area already has sufficient premises to meet demand of local residents and additional outlets supplying alcohol after 1am will be detrimental to the local residents in terms of noise and disturbance in the early hours of the morning.

Alcohol and health

Alcohol misuse imposes a major preventable burden to health and the effect of this in Islington is felt across all health services. Recent analysis has estimated that in Islington the cost of hospital admissions where alcohol is an attributable factor was £7429.9k, (£39.4 per Islington resident during the financial year 2008/09¹¹).

There is a growing body of evidence that an increased number of alcohol outlets results in significant increases in both alcohol consumption and alcohol-related harm, including injury, violence and medical harm. Evidence from a number of countries indicates reducing alcohol outlet density can have an impact on reducing violence and problem drinking. There is also strong and reasonably consistent evidence that changes in hours or days of trading can have a significant impact on volume of alcohol consumed and rates of alcohol related problems^{2,3,4,5,6}.

Impact of alcohol on health in Islington

The impact of alcohol on health in Islington is particularly severe. Alcohol-specific hospital admissions are those which are wholly related to alcohol (e.g. alcoholic liver disease or alcohol overdose). Islington has the second

North Central London

highest rate in London for hospital admissions where alcohol is the specific cause of admission. For men the rate is also significantly worse than England, with Islington having the 24th highest rate out of 326 boroughs nationally.

Currently Islington has one of the highest rates of alcohol-related hospital admissions (all hospital admissions in which alcohol is likely to have played a part, for example injuries/falls or high blood pressure) in London. The rate for both men and women is significantly worse than the England average. Increases in alcohol related admissions have been much higher in Islington than in England as a whole. For instance, in Islington, the increase in alcohol-related admissions in men was 39% and 44% for women between 2003/4 and 2009/10, compared to increases of 25% for both men and women in England.

Finsbury Park Ward

Ambulance callouts

The data on alcohol-related ambulance callouts reflects where the ambulance attended, not where the individual lives, and therefore includes people who live outside the borough but who come into Islington to work, socialise, etc. In 2011/12, there were 253 alcohol-related ambulance callouts in Finsbury Park ward (10.8% of all alcohol-related callouts in Islington), compared to an average of 146 per ward. Local analysis indicates that there is a general trend of ambulance callouts increasing as the number of licensed premises increases. At the smaller geographical Lower Super Output Area (equal to an area of around 1,500 residents), there were 33 alcohol-related ambulance call-outs in the vicinity of the Express Food Store, compared to an average of 20 across all Islington LSOAs. Across Islington, 53% of alcohol-related callouts resulted in conveying a person to hospital, and 6% resulted in assistance being given at the scene or conveyed to an NHS walk-in centre – this results in a substantial use of health service resource.

Hospital admissions

Finsbury ward had the 6th highest rate of alcohol-specific hospital admissions among Islington wards in 2011/12, with a rate of 857 per 100,000 people – equivalent to more than 90 admissions to hospital.

Of all the wards in Islington, Finsbury Park ward had the highest rate of alcohol-related hospital admissions in 2011/12 – a rate of 3,307 hospital admissions per 100,000 people – equivalent to more than 400 admissions. This rate in Finsbury Park ward was significantly higher than the average for Islington as a whole.

Conclusion

Islington experiences some of the highest levels of alcohol-related harm in London and the cumulative availability of alcohol is one area that is likely to be impacting on this.

Rates of hospital admissions as a result of alcohol are higher in Finsbury Park ward than in the borough as a whole, indicating alcohol is having a particular impact on residents in this part of Islington.

There is already good availability of alcohol through off licences in Finsbury Park, with a higher than average density as measured by the number of off licences per residents aged 18 and over.

There is evidence that increased availability of alcohol, both in terms of the time period in which alcohol is available (hours of sale) and number of premises from which alcohol is available results in an increase in alcohol related harm. The effect of this is increased pressure and costs to the NHS. The impacts are also felt across a range of groups including the council, policing and the community as a whole.

Recommendation

NHS North Central London's Islington Public Health Department recommends that:

1. The application for a 24 hour licence to supply alcohol is refused
2. The permitted hours of 07:00 to 01:00 at these premises not extended.

References

- 1 Baker, A., Lodge, H. Jacobson, B., Hamm, J. and Murage, P. (2012) Closing Time: Counting the cost of alcohol-attributable hospital admissions in London. London: London Health Observatory
- 2 Popova, S., Giesbrecht, N., Bekmuradov, D. And Patra, J. Hours and days of sale and density of alcohol outlets: impact on alcohol consumption and damage: a systematic review. Alcohol and alcoholism 2009;44(5):500-516
- 3 Newton, A., Sarker, S.J., Pahal, G.S., van den Burgh, E. and Young, C. Impact of the new licensing law on emergency hospital attendances: a cohort study. Emergency Medicine Journal 2007;24:532-534
- 4 Highes K, Jones L, Bellis M. Reducing harm in drinking environments factsheet. European Union 2009.
- 5 Livingstone M. et al. Changing the density of alcohol outlets to reduce alcohol related harm. Drug and Alcohol Review 2007; 26: 557-566
- 6 Bryden A et al. A systematic review of the influence on alcohol use of community level availability and marketing of alcohol. Health and Place 2012; 18(2):349-357

**Licensing Act 2003- Representation from the Licensing Authority
Application: Express Food Store, 2-3 Clifton Terrace, London N4 3JP**

I am submitting a representation on behalf of the Licensing Authority against the new application for a Premises Licence to permit the sale of alcohol 24 hours a day from the above premises.

The grounds for the representation are:

- Public nuisance
- Crime and disorder

The premises already has a premises licence under the trading name Nisa Local, which permits off sales of alcohol until 1am each day of the week. In May 2012 the licensee of Nisa Local applied for a 24 hour licence to permit the sale of alcohol. This application was refused by the Licensing Committee in June 2012.

Express Food Store is located in the Finsbury Park ward to just behind Finsbury Park station. This is situated in an alcohol related crime and disorder hotspot area any further increase in the late night availability of alcohol needs to be carefully managed to ensure that the area, which has already reached saturation point in terms of crime and disorder, is carefully managed.

The premise is close to the densely populated Andover Estate.

There are over 100 licensed premises in the Finsbury Park ward, 41 premises are licensed for the off sales of alcohol and 6 premises hold a 24 hour license. The nearest off licence, in Wells Terrace, holds a premises licence to permit off sales until 2am each day.

The area already has sufficient licensed premises to cater for demands of local residents and any additional outlets supplying alcohol in the early hours of the morning will be detrimental to the local residents in terms in terms of noise and disturbance and increase the potential for increasing alcohol related crime and disorder.

The Licensing Authority fully supports any representations for the Police in terms of crime and disorder and is committed to supporting the Reclaim the Night programme of activities to reduce the incidence of alcohol related crime through reducing access to alcohol late at night.

Whilst the section 10.13 of the Guidance issued under s812 Licensing Act 2003 encourages Local Authorities to grant premises licences for shops and supermarkets to permit alcohol sales whenever the outlet is open for shopping the Licensing Authority may restrict hours where there are good reasons, based up the licensing objectives. The Licensing Authority is of the opinion that the alcohol related crime hotspot data for this area provides good reasons for departing from this guidance.

In determining this application the Licensing Committee should be mindful of:

Licensing Policy 23 – '*... the type of premises and their cumulative impact upon the area*

Licensing Policy 25- in particular paragraph 109 in which the Licensing Authority expresses its concern over the increasing number of licensed shops selling alcohol for consumption off the premises and advises that it will '*...consider restricting the hour in locations where longer hours are not considered appropriate because of the nature of the area or where representations are received...*

The Licensing Authority recommends that the application for a 24 hour licence is refused and that consideration be given to granting a licence to permit off sales of alcohol until 1am.

Janice Gibbons
Service Manager
Islington Council
Public Protection Division
222 Upper St
London N1 1XR

12 December 2012



PREMISES LICENCE LICENSING ACT 2003

Premises licence number	LN14040-15062012		
Postal address of premises, or if none, ordnance survey map reference or description			
EURO EXPRESS FOOD AND WINE 2 CLIFTON TERRANCE			
Post town	LONDON	Post code	N4 3JP
Telephone number	N/A		

Where the licence is time limited the dates
Not Applicable

Licensable activities authorised by the licence

Ground floor only

- The sale by retail of alcohol

The times the licence authorises the carrying out of licensable activities

- The sale by retail of alcohol:

Monday	08:00	to	23:00
Tuesday	08:00	to	23:00
Wednesday	08:00	to	23:00
Thursday	08:00	to	23:00
Friday	08:00	to	23:00
Saturday	08:00	to	23:00
Sunday	08:00	to	23:00

Gaming Machine Provision:
Not applicable

The opening hours of the premises:

Monday	00:00	to	00:00
Tuesday	00:00	to	00:00
Wednesday	00:00	to	00:00
Thursday	00:00	to	00:00
Friday	00:00	to	00:00
Saturday	00:00	to	00:00
Sunday	00:00	to	00:00

Where the licence authorises supplies of alcohol whether these are on and/or off supplies
On supplies

Name, (registered) address, telephone number and e-mail (where relevant) of holder of premises licence

Mr Riza Berktas
6 Turner House
Corbayn Street
London
N4 3DD

Registered number of holder, for example company number, charity number (where applicable)

Not applicable

Name, address and telephone number of designated premises supervisor where the premises licence authorises the supply of alcohol

Mr Riza Berktas
6 Turner House
Corbayn Street
London
N4 3DD

Personal licence number and issuing authority of personal licence held by designated premises supervisor where the premises licence authorises the supply of alcohol

LN 937993 London Borough of Islington

Islington Council
Public Protection Division
222 Upper Street
London N1 1XR
Tel: 020 7527 3031
Email: licensing@islington.gov.uk

Service Director - Public Protection

Date of Issue

Annex 1 - Mandatory conditions

1. No supply of alcohol may be made under the premises licence:
 - a) at a time when there is no designated premises supervisor in respect of the premises licence, or
 - b) at a time when the designated premises supervisor does not hold a personal licence or his personal licence is suspended.
2. Every supply of alcohol under the premises licence must be made or authorised by a person who holds a personal licence.
3. All door supervisors shall be licensed by the Security Industry Authority.
4. The admission of children to the exhibition of a film shall be restricted in accordance with the recommendation of a film classification body as defined in the Video Recordings Act 1984 or Islington Council acting as the licensing authority where it has given notice in section 20(3) of the Licensing Act 2003.
5. The responsible person shall take all reasonable steps to ensure that staff on relevant premises do not carry out, arrange or participate in any "irresponsible promotions" in relation to the premises.

In this condition, an "irresponsible promotion" means any one or more of the following activities, or substantially similar activities, carried on for the purpose of encouraging the sale or supply of alcohol for consumption on the premises in a manner which carries a significant risk of leading or contributing to crime and disorder, prejudice to public safety, public nuisance, or harm to children:

 - a) games or other activities which require or encourage, or are designed to require or encourage, individuals to:
 - i) drink a quantity of alcohol within a time limit (other than to drink alcohol sold or supplied on the premises before the cessation of the period in which the responsible person is authorised to sell or supply alcohol), or
 - ii) drink as much alcohol as possible (whether within a time limit or otherwise);
 - b) provision of unlimited or unspecified quantities of alcohol free or for a fixed or discounted fee to the public or to a group defined by a particular characteristic (other than any promotion or discount available to an individual in respect of alcohol for consumption at a table meal, as defined in section 159 of the Act);
 - c) provision of free or discounted alcohol or any other thing as a prize to encourage or reward the purchase and consumption of alcohol over a period of 24 hours or less;
 - d) provision of free or discounted alcohol in relation to the viewing on the premises of a sporting event, where that provision is dependent on:
 - i) the outcome of a race, competition or other event or process, or
 - ii) the likelihood of anything occurring or not occurring;
 - e) selling or supplying alcohol in association with promotional posters or flyers on, or in the vicinity of, the premises which can reasonably be considered to condone, encourage or glamorise anti-social behaviour or to refer to the effects of drunkenness in any favourable manner.
6. The responsible person shall ensure that no alcohol is dispensed directly by one person into the mouth of another (other than where that other person is unable to drink without assistance by reason of a disability).
7. The responsible person shall ensure that free tap water is provided on request to customers where it is reasonably available.

8. The premises licence holder or club premises certificate holder shall ensure that an age verification policy applies to the premises in relation to the sale or supply of alcohol.

The policy must require individuals who appear to the responsible person to be under 18 years of age (or such older age as may be specified in the policy) to produce on request, before being served alcohol, identification bearing their photograph, date of birth and a holographic mark.

9. The responsible person shall ensure that:
 - a) where any of the following alcoholic drinks is sold or supplied for consumption on the premises (other than alcoholic drinks sold or supplied having been made up in advance ready for sale or supply in a securely closed container) it is available to customers in the following measures:
 - i) beer or cider: ½ pint;
 - ii) gin, rum, vodka or whisky: 25 ml or 35 ml; and
 - iii) still wine in a glass: 125 ml; and
 - b) customers are made aware of the availability of these measures.

Annex 2 - Conditions consistent with the Operating Schedule

1. All staff shall be trained regularly on licensing provisions and this to be documented.
2. All instances of crime and disorder shall be reported to the police.
3. An incident book shall be used to record all instances of public disorder.
4. CCTV shall be installed, operated and maintained in agreement with the police. The system will enable frontal identification of every person entering the premises. The system shall record in real time and operate whilst the premises are open for licensable activities. The recordings shall be kept available for a minimum of 31 days. Recordings shall be made available to an authorised officer or a police officer (subject to the data protection act 1998) within 24hrs of any request.
5. The premises shall comply with the fire regulations and the provisions of the management regulations.
6. The licence holder shall maintain and check systems in place, smoke detectors, fire extinguishers, emergency safety lighting and fire alarms
7. The licence holder shall discourage noise from patrons arriving at, queuing or departing from the premises by displaying polite notices for customers' attention.
8. The licensee shall adopt the challenge 25, the retail of alcohol standards group's advice for off-licenses.
9. The licensee shall ensure that staff are trained about age restricted products and ensure that they sign to confirm that they have understood the training. The licensee shall keep records of training and instruction given to staff.
10. The licensee shall put arrangements in place to ensure that before serving alcohol to young persons, staff ask to see accredited proof of age cards for example proof of age cards carrying the 'pass' logo, a passport, or uk drivers licence bearing the photograph and the date of birth of the bearer.
11. The licensee shall require staff to note any refusals to sell to young people in a refusals log.

Annex 3 - Conditions attached after a hearing by the licensing authority

Annex 4 – Plans

Reference Number: 139.12/01

LIC 139



Premises Licence Summary

Licensing Act 2003

Premises licence number	LN14040-15062012		
Postal address of premises, or if none, ordnance survey map reference or description			
EURO EXPRESS FOOD AND WINE 2 CLIFTON TERRANCE			
Post town	LONDON	Post code	N4 3JP
Telephone number	N/A		

Where the licence is time limited the dates
Not Applicable

Licensable activities authorised by the licence
Ground floor only
<ul style="list-style-type: none"> The sale by retail of alcohol

The times the licence authorises the carrying out of licensable activities																												
<ul style="list-style-type: none"> The sale by retail of alcohol: <table style="margin-left: 20px;"> <tr><td>Monday</td><td>08:00</td><td>to</td><td>23:00</td></tr> <tr><td>Tuesday</td><td>08:00</td><td>to</td><td>23:00</td></tr> <tr><td>Wednesday</td><td>08:00</td><td>to</td><td>23:00</td></tr> <tr><td>Thursday</td><td>08:00</td><td>to</td><td>23:00</td></tr> <tr><td>Friday</td><td>08:00</td><td>to</td><td>23:00</td></tr> <tr><td>Saturday</td><td>08:00</td><td>to</td><td>23:00</td></tr> <tr><td>Sunday</td><td>08:00</td><td>to</td><td>23:00</td></tr> </table> 	Monday	08:00	to	23:00	Tuesday	08:00	to	23:00	Wednesday	08:00	to	23:00	Thursday	08:00	to	23:00	Friday	08:00	to	23:00	Saturday	08:00	to	23:00	Sunday	08:00	to	23:00
Monday	08:00	to	23:00																									
Tuesday	08:00	to	23:00																									
Wednesday	08:00	to	23:00																									
Thursday	08:00	to	23:00																									
Friday	08:00	to	23:00																									
Saturday	08:00	to	23:00																									
Sunday	08:00	to	23:00																									

Gaming Machine Provision:
Not applicable

The opening hours of the premises:																												
<table style="margin-left: 20px;"> <tr><td>Monday</td><td>00:00</td><td>to</td><td>00:00</td></tr> <tr><td>Tuesday</td><td>00:00</td><td>to</td><td>00:00</td></tr> <tr><td>Wednesday</td><td>00:00</td><td>to</td><td>00:00</td></tr> <tr><td>Thursday</td><td>00:00</td><td>to</td><td>00:00</td></tr> <tr><td>Friday</td><td>00:00</td><td>to</td><td>00:00</td></tr> <tr><td>Saturday</td><td>00:00</td><td>to</td><td>00:00</td></tr> <tr><td>Sunday</td><td>00:00</td><td>to</td><td>00:00</td></tr> </table>	Monday	00:00	to	00:00	Tuesday	00:00	to	00:00	Wednesday	00:00	to	00:00	Thursday	00:00	to	00:00	Friday	00:00	to	00:00	Saturday	00:00	to	00:00	Sunday	00:00	to	00:00
Monday	00:00	to	00:00																									
Tuesday	00:00	to	00:00																									
Wednesday	00:00	to	00:00																									
Thursday	00:00	to	00:00																									
Friday	00:00	to	00:00																									
Saturday	00:00	to	00:00																									
Sunday	00:00	to	00:00																									

Where the licence authorises supplies of alcohol whether these are on and/or off supplies
On supplies

Name, (registered) address, telephone number and e-mail (where relevant) of holder of premises licence

Mr Riza Berktas
6 Turner House
Corbayn Street
London
N4 3DD

Registered number of holder, for example company number, charity number (where applicable)

Name of designated premises supervisor where the premises licence authorises the supply of alcohol

Mr Riza Berktas **Error! Reference source not found.**

State whether access to the premises by children is restricted or prohibited

No restrictions

Islington Council
Public Protection Division
222 Upper Street
London N1 1XR
Tel: 020 7527 3031
Email: licensing@islington.gov.uk

Summary

Suggested conditions of approval consistent with the operating schedule

1. All staff shall be trained regularly on licensing provisions and this to be documented.
2. All instances of crime and disorder shall be reported to the police.
3. An incident book shall be used to record all instances of public disorder.
4. CCTV shall be installed, operated and maintained in agreement with the police. The system will enable frontal identification of every person entering the premises. The system shall record in real time and operate whilst the premises are open for licensable activities. The recordings shall be kept available for a minimum of 31 days. Recordings shall be made available to an authorised officer or a police officer (subject to the data protection act 1998) within 24hrs of any request.
5. The premises shall comply with the fire regulations and the provisions of the management regulations.
6. The licence holder shall maintain and check systems in place, smoke detectors, fire extinguishers, emergency safety lighting and fire alarms
7. The licence holder shall discourage noise from patrons arriving at, queuing or departing from the premises by displaying polite notices for customers' attention.
8. The licensee shall adopt the challenge 25, the retail of alcohol standards group's advice for off-licenses.
9. The licensee shall ensure that staff are trained about age restricted products and ensure that they sign to confirm that they have understood the training. The licensee shall keep records of training and instruction given to staff.
10. The licensee shall put arrangements in place to ensure that before serving alcohol to young persons, staff ask to see accredited proof of age cards for example proof of age cards carrying the 'pass' logo, a passport, or uk drivers licence bearing the photograph and the date of birth of the bearer.
11. The licensee shall require staff to note any refusals to sell to young people in a refusals log.