



Report of: Service Director, Public Protection

Meeting of	Date	Agenda Item	Ward(s)
Licensing Sub-Committee	12 September 2017		Tollington

Delete as appropriate		Non-exempt
-----------------------	--	------------

**Subject: PREMISES LICENCE NEW APPLICATION
HOPSMITHS, 29 CROUCH HILL, LONDON N4 4AP**

1. Synopsis

- 1.1 This is an application for a new premise licence under the Licensing Act 2003.
- 1.2 The new application is to:
 - I. Supply alcohol for consumption on or off the premises, from 11:00 until 23:00 Monday to Wednesday, 11:00 to 00:00 Thursday to Saturday and from 12:00 until 22:30 on Sunday;
 - II. Recorded music and Performance of Dance from 11:00 until 23:00 Monday to Wednesday, 11:00 to 00:00 Thursday to Saturday and from 12:00 until 22:30 on Sunday;
 - III. Late Night Refreshment from 23:00 to 00:00 Thursday to Saturday;
 - IV. Opening hours of the premises from 11:00 to 23:30 Monday to Wednesday, from 11:00 to 00:30 Friday and Saturday and 12:00 to 23:00 on Sunday.

2. Relevant Representations

Licensing Authority	No
Metropolitan Police	Yes – Conditions Proposed

Noise	Yes – Conditions Proposed
Health and Safety	No
Trading Standards	No
Public Health	No
Safeguarding Children	No
London Fire Brigade	No
Local residents	Yes – 1 resident
Other bodies	No

3. Background

3.1 Papers are attached as follows:-

Appendix 1: application form;

Appendix 2: representations;

Appendix 3: suggested conditions and map of premises location.

3.2 The premises is currently unlicensed.

4. Planning Implications

4.1 No adverse observations have been received from Planning regarding this new application.

5 Recommendations

5.1 To determine the application for a new premises licence under Section 17 of the Licensing Act 2003.

5.2 If the Committee grants the application it should be subject to:

- i. conditions prepared by the Licensing Officer which are consistent with the Operating Schedule (see appendix 4)
- ii. any conditions deemed appropriate by the Committee to promote the four licensing objectives.(see appendix 4)

6 Conclusion and reasons for recommendations

6.1 The Council is required to consider this application in the light of all relevant information, and if approval is given, it may attach such conditions as appropriate to promote the licensing objectives.

Background papers:

The Council's Statement of Licensing Policy

Licensing Act 2003

Secretary of States Guidance

Final Report Clearance

Signed by

Service Director – Public Protection

Date

31/8/17

Received by

Head of Scrutiny and Democratic Services

Date

Report author: Licensing Service

Tel: 020 75027 3031

E-mail: licensing@islington.gov.uk

KEYSTONE LAW

Application for a premises licence to be granted

under the Licensing Act 2003

PLEASE READ THE FOLLOWING INSTRUCTIONS FIRST

Before completing this form please read the guidance notes at the end of the form. If you are completing this form by hand please write legibly in block capitals. In all cases ensure that your answers are inside the boxes and written in black ink. Use additional sheets if necessary.

You may wish to keep a copy of the completed form for your records.

I/We Carouse London LTD

(Insert name(s) of applicant)

apply for a premises licence under section 17 of the Licensing Act 2003 for the premises described in Part 1 below (the premises) and I/we are making this application to you as the relevant licensing authority in accordance with section 12 of the Licensing Act 2003

Part 1 – Premises details

Postal address of premises or, if none, ordnance survey map reference or description Hopsmiths, 29 Crouch Hill,			
Post town	London	Postcode	N4 4AP

Telephone number at premises (if any)	N/A
Non-domestic rateable value of premises	£17,250

Part 2 - Applicant details

Please state whether you are applying for a premises licence as

Please tick as appropriate

- | | | |
|--|-------------------------------------|-----------------------------|
| a) an individual or individuals * | <input type="checkbox"/> | please complete section (A) |
| b) a person other than an individual * | | |
| i as a limited company/limited liability partnership | <input checked="" type="checkbox"/> | please complete section (B) |
| ii as a partnership (other than limited liability) | <input type="checkbox"/> | please complete section (B) |
| iii as an unincorporated association or | <input type="checkbox"/> | please complete section (B) |
| iv other (for example a statutory corporation) | <input type="checkbox"/> | please complete section (B) |
| c) a recognised club | <input type="checkbox"/> | please complete section (B) |
| d) a charity | <input type="checkbox"/> | please complete section (B) |
| e) the proprietor of an educational establishment | <input type="checkbox"/> | please complete section (B) |
| f) a health service body | <input type="checkbox"/> | please complete section (B) |

112/163248
£190. 10/7/17.

- g) a person who is registered under Part 2 of the Care Standards Act 2000 (c14) in respect of an independent hospital in Wales ☐ please complete section (B)
- ga) a person who is registered under Chapter 2 of Part 1 of the Health and Social Care Act 2008 (within the meaning of that Part) in an independent hospital in England ☐ please complete section (B)
- h) the chief officer of police of a police force in England and Wales ☐ please complete section (B)

* If you are applying as a person described in (a) or (b) please confirm (by ticking yes to one box below):

I am carrying on or proposing to carry on a business which involves the use of the premises for licensable activities; or ☒

I am making the application pursuant to a

statutory function or ☐

a function discharged by virtue of Her Majesty's prerogative ☐

(A) INDIVIDUAL APPLICANTS (fill in as applicable)

Mr <input type="checkbox"/>	Mrs <input type="checkbox"/>	Miss <input type="checkbox"/>	Ms <input type="checkbox"/>	Other Title (for example, Rev)	
Surname			First names		
Date of birth		I am 18 years old or over		<input type="checkbox"/> Please tick yes	
Nationality					
Current residential address if different from premises address					
Post town				Postcode	
Daytime contact telephone number					
E-mail address (optional)					

SECOND INDIVIDUAL APPLICANT (if applicable)

Mr <input type="checkbox"/>	Mrs <input type="checkbox"/>	Miss <input type="checkbox"/>	Ms <input type="checkbox"/>	Other Title (for example, Rev)	
Surname			First names		
Date of birth		I am 18 years old or over		<input type="checkbox"/> Please tick yes	

Nationality			
Current postal address if different from premises address			
Post town		Postcode	
Daytime contact telephone number			
E-mail address (optional)			

(B) OTHER APPLICANTS

Please provide name and registered address of applicant in full. Where appropriate please give any registered number. In the case of a partnership or other joint venture (other than a body corporate), please give the name and address of each party concerned.

Name Carouse London LTD
Address Unit 3 Gateway Mews Ringway N11 2UT
Registered number (where applicable) 08925723
Description of applicant (for example, partnership, company, unincorporated association etc.) Company
Telephone number (if any)
E-mail address (optional)

Part 3 Operating Schedule

When do you want the premises licence to start?

DD	MM	YYYY
08	08	2017

If you wish the licence to be valid only for a limited period, when do you want it to end?

DD	MM	YYYY

Please give a general description of the premises (please read guidance note 1)

Public House

If 5,000 or more people are expected to attend the premises at any one time, please state the number expected to attend.

What licensable activities do you intend to carry on from the premises?

(please see sections 1 and 14 and Schedules 1 and 2 to the Licensing Act 2003)

Provision of regulated entertainment (please read guidance note 2)

Please tick all that apply

- | | |
|---|-------------------------------------|
| a) plays (if ticking yes, fill in box A) | <input type="checkbox"/> |
| b) films (if ticking yes, fill in box B) | <input type="checkbox"/> |
| c) indoor sporting events (if ticking yes, fill in box C) | <input type="checkbox"/> |
| d) boxing or wrestling entertainment (if ticking yes, fill in box D) | <input type="checkbox"/> |
| e) live music (if ticking yes, fill in box E) | <input type="checkbox"/> |
| f) recorded music (if ticking yes, fill in box F) | <input checked="" type="checkbox"/> |
| g) performances of dance (if ticking yes, fill in box G) | <input checked="" type="checkbox"/> |
| h) anything of a similar description to that falling within (e), (f) or (g) (if ticking yes, fill in box H) | <input type="checkbox"/> |

Provision of late night refreshment (if ticking yes, fill in box I)

☒

Supply of alcohol (if ticking yes, fill in box J)

☒

In all cases complete boxes K, L and M

A

Plays Standard days and timings (please read guidance note 7)			Will the performance of a play take place indoors or outdoors or both – please tick (please read guidance note 3)		Indoors	<input type="checkbox"/>
					Outdoors	<input type="checkbox"/>
					Both	<input type="checkbox"/>
Day	Start	Finish	Please give further details here (please read guidance note 4)			
Mon						
Tue						
			State any seasonal variations for performing plays (please read guidance note 5)			
Wed						
Thur						
			Non standard timings. Where you intend to use the premises for the performance of plays at different times to those listed in the column on the left, please list (please read guidance note 6)			
Fri						
Sat						
Sun						

B

Films Standard days and timings (please read guidance note 7)			<u>Will the exhibition of films take place indoors or outdoors or both – please tick</u> (please read guidance note 3)	Indoors	<input type="checkbox"/>
				Outdoors	<input type="checkbox"/>
				Both	<input type="checkbox"/>
Day	Start	Finish	<u>Please give further details here</u> (please read guidance note 4)		
Mon					
Tue			<u>State any seasonal variations for the exhibition of films</u> (please read guidance note 5)		
Wed			<u>Non standard timings. Where you intend to use the premises for the exhibition of films at different times to those listed in the column on the left, please list</u> (please read guidance note 6)		
Thur					
Fri					
Sat					
Sun					

C

Indoor sporting events Standard days and timings (please read guidance note 7)			Please give further details (please read guidance note 4)
Day	Start	Finish	
Mon			
			State any seasonal variations for indoor sporting events (please read guidance note 5)
Tue			
Wed			Non standard timings. Where you intend to use the premises for indoor sporting events at different times to those listed in the column on the left, please list (please read guidance note 6)
Thur			
Fri			
Sat			
Sun			

D

Boxing or wrestling entertainments Standard days and timings (please read guidance note 7)			<u>Will the boxing or wrestling entertainment take place indoors or outdoors or both – please tick</u> (please read guidance note 3)	Indoors	<input type="checkbox"/>
				Outdoors	<input type="checkbox"/>
				Both	<input type="checkbox"/>
Day	Start	Finish	<u>Please give further details here</u> (please read guidance note 4)		
Mon					
Tue			<u>State any seasonal variations for boxing or wrestling entertainment</u> (please read guidance note 5)		
Wed			<u>Non standard timings. Where you intend to use the premises for boxing or wrestling entertainment at different times to those listed in the column on the left, please list</u> (please read guidance note 6)		
Thur					
Fri					
Sat					
Sun					

E

Live music Standard days and timings (please read guidance note 7)			<u>Will the performance of live music take place indoors or outdoors or both – please tick</u> (please read guidance note 3)	Indoors	<input type="checkbox"/>
				Outdoors	<input type="checkbox"/>
				Both	<input type="checkbox"/>
Day	Start	Finish	<u>Please give further details here</u> (please read guidance note 4)		
Mon					
Tue					
			<u>State any seasonal variations for the performance of live music</u> (please read guidance note 5)		
Wed					
Thur					
			<u>Non standard timings. Where you intend to use the premises for the performance of live music at different times to those listed in the column on the left, please list</u> (please read guidance note 6)		
Fri					
Sat					
Sun					

F

Recorded music Standard days and timings (please read guidance note 7)			<u>Will the playing of recorded music take place indoors or outdoors or both – please tick</u> (please read guidance note 3)	Indoors	<input checked="" type="checkbox"/>
				Outdoors	<input type="checkbox"/>
				Both	<input type="checkbox"/>
Day	Start	Finish	<u>Please give further details here</u> (please read guidance note 4)		
Mon	11:00	23:00			
Tue	11:00	23:00			
Wed	11:00	23:00			
			<u>State any seasonal variations for the playing of recorded music</u> (please read guidance note 5)		
Thur	11:00	00:00			
Fri	11:00	00:00			
			<u>Non standard timings. Where you intend to use the premises for the playing of recorded music at different times to those listed in the column on the left, please list</u> (please read guidance note 6)		
Sat	11:00	00:00			
			All licensable activities shall be extended from the end of permitted hours on New Year's Eve to the start of permitted hours on New Year's Day.		
Sun	12:00	22:30			

G

Performances of dance Standard days and timings (please read guidance note 7)			Will the performance of dance take place indoors or outdoors or both – please tick (please read guidance note 3)	Indoors	<input checked="" type="checkbox"/>
				Outdoors	<input type="checkbox"/>
				Both	<input type="checkbox"/>
Day	Start	Finish	Please give further details here (please read guidance note 4)		
Mon	11:00	23:00			
Tue	11:00	23:00			
Wed	11:00	23:00			
			State any seasonal variations for the performance of dance (please read guidance note 5)		
Thur	11:00	00:00			
Fri	11:00	00:00			
			Non standard timings. Where you intend to use the premises for the performance of dance at different times to those listed in the column on the left, please list (please read guidance note 6)		
Sat	11:00	00:00			
			All licensable activities shall be extended from the end of permitted hours on New Year's Eve to the start of permitted hours on New Year's Day.		
Sun	12:00	22:30			

H

Anything of a similar description to that falling within (e), (f) or (g) Standard days and timings (please read guidance note 7)			Please give a description of the type of entertainment you will be providing		
Day	Start	Finish	<u>Will this entertainment take place indoors or outdoors or both – please tick</u> (please read guidance note 3)	Indoors	<input type="checkbox"/>
Mon				Outdoors	<input type="checkbox"/>
				Both	<input type="checkbox"/>
Tue			<u>Please give further details here</u> (please read guidance note 4)		
Wed					
Thur			<u>State any seasonal variations for entertainment of a similar description to that falling within (e), (f) or (g)</u> (please read guidance note 5)		
Fri					
Sat			<u>Non standard timings. Where you intend to use the premises for the entertainment of a similar description to that falling within (e), (f) or (g) at different times to those listed in the column on the left, please list</u> (please read guidance note 6)		
Sun					

Late night refreshment Standard days and timings (please read guidance note 7)			Will the provision of late night refreshment take place indoors or outdoors or both – please tick (please read guidance note 3)	Indoors	<input type="checkbox"/>
				Outdoors	<input type="checkbox"/>
				Both	<input checked="" type="checkbox"/>
Day	Start	Finish	<u>Please give further details here</u> (please read guidance note 4)		
Mon					
Tue					
Wed			<u>State any seasonal variations for the provision of late night refreshment</u> (please read guidance note 5)		
Thur	23:00	00:00			
Fri	23:00	00:00	<u>Non standard timings. Where you intend to use the premises for the provision of late night refreshment at different times, to those listed in the column on the left, please list</u> (please read guidance note 6) All licensable activities shall be extended from the end of permitted hours on New Year's Eve to the start of permitted hours on New Year's Day.		
Sat	23:00	00:00			
Sun					

J

Supply of alcohol Standard days and timings (please read guidance note 7)			Will the supply of alcohol be for consumption – please tick (please read guidance note 8)	On the premises	<input type="checkbox"/>
				Off the premises	<input type="checkbox"/>
				Both	<input checked="" type="checkbox"/>
Day	Start	Finish	State any seasonal variations for the supply of alcohol (please read guidance note 5)		
Mon	11:00	23:00			
Tue	11:00	23:00			
Wed	11:00	23:00			
Thur	11:00	00:00			
Fri	11:00	00:00	Non standard timings. Where you intend to use the premises for the supply of alcohol at different times to those listed in the column on the left, please list (please read guidance note 6) All licensable activities shall be extended from the end of permitted hours on New Year's Eve to the start of permitted hours on New Year's Day.		
Sat	11:00	00:00			
Sun	12:00	22:30			

State the name and details of the individual whom you wish to specify on the licence as designated premises supervisor (Please see declaration about the entitlement to work in the checklist at the end of the form):

Name Christopher Hurd	
Date of birth	
Address	
Postcode	
Personal licence number (if known)	
Issuing licensing authority (if known)	

K

Please highlight any adult entertainment or services, activities, other entertainment or matters ancillary to the use of the premises that may give rise to concern in respect of children (please read guidance note 9).

N/A

L

Hours premises are open to the public Standard days and timings (please read guidance note 7)			<u>State any seasonal variations</u> (please read guidance note 5)
Day	Start	Finish	
Mon	11:00	23:30	
Tue	11:00	23:30	
Wed	11:00	23:30	
Thur	11:00	00:30	
Fri	11:00	00:30	
Sat	11:00	00:30	
Sun	12:00	23:00	

Non standard timings. Where you intend the premises to be open to the public at different times from those listed in the column on the left, please list (please read guidance note 6)

All licensable activities shall be extended from the end of permitted hours on New Year's Eve to the start of permitted hours on New Year's Day.

M Describe the steps you intend to take to promote the four licensing objectives:

a) General – all four licensing objectives (b, c, d and e) (please read guidance note 10)

Please see presentation and conditions attached.

b) The prevention of crime and disorder

Please see presentation and conditions attached.

c) Public safety

Please see presentation and conditions attached.

d) The prevention of public nuisance

Please see presentation and conditions attached.

e) The protection of children from harm

Please see presentation and conditions attached.

Checklist:

Please tick to indicate agreement

- I have made or enclosed payment of the fee. ☒
- I have enclosed the plan of the premises. ☒
- I have sent copies of this application and the plan to responsible authorities and others where applicable. ☒
- I have enclosed the consent form completed by the individual I wish to be designated premises supervisor, if applicable. ☒
- I understand that I must now advertise my application. ☒
- I understand that if I do not comply with the above requirements my application will be rejected. ☒
- ☐ [Applicable to all individual applicants, including those in a partnership which is not a limited liability partnership, but not companies or limited liability partnerships] I have included documents demonstrating my entitlement to work in the United Kingdom (please read note 15).

IT IS AN OFFENCE, UNDER SECTION 158 OF THE LICENSING ACT 2003, TO MAKE A FALSE STATEMENT IN OR IN CONNECTION WITH THIS APPLICATION. THOSE WHO MAKE A FALSE STATEMENT MAY BE LIABLE ON SUMMARY CONVICTION TO A FINE OF ANY AMOUNT.

IT IS AN OFFENCE UNDER SECTION 24B OF THE IMMIGRATION ACT 1971 FOR A PERSON TO WORK WHEN THEY KNOW, OR HAVE REASONABLE CAUSE TO BELIEVE, THAT THEY ARE DISQUALIFIED FROM DOING SO BY REASON OF THEIR IMMIGRATION STATUS. THOSE WHO EMPLOY AN ADULT WITHOUT LEAVE OR WHO IS SUBJECT TO CONDITIONS AS TO EMPLOYMENT WILL BE LIABLE TO A CIVIL PENALTY UNDER SECTION 15 OF THE IMMIGRATION, ASYLUM AND NATIONALITY ACT 2006 AND PURSUANT TO SECTION 21 OF THE SAME ACT, WILL BE COMMITTING AN OFFENCE WHERE THEY DO SO IN THE KNOWLEDGE, OR WITH REASONABLE CAUSE TO BELIEVE, THAT THE EMPLOYEE IS DISQUALIFIED.

Part 4 – Signatures (please read guidance note 11)

Signature of applicant or applicant's solicitor or other duly authorised agent (see guidance note 12). If signing on behalf of the applicant, please state in what capacity.

Declaration	<ul style="list-style-type: none">• [Applicable to individual applicants only, including those in a partnership which is not a limited liability partnership] I understand I am not entitled to be issued with a licence if I do not have the entitlement to live and work in the UK (or if I am subject to a condition preventing me from doing work relating to the carrying on of a licensable activity) and that my licence will become invalid if I cease to be entitled to live and work in the UK (please read guidance note 15).• The DPS named in this application form is entitled to work in the UK (and is not subject to conditions preventing him or her from doing work relating to a licensable activity) and I have seen a copy of his or her proof
--------------------	---

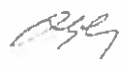
	of entitlement to work, if appropriate (please see note 15)
Signature	Keystone Law Ltd 
Date	10/07/2017
Capacity	Solicitors on behalf of applicant

For joint applications, signature of 2nd applicant or 2nd applicant's solicitor or other authorised agent (please read guidance note 13). If signing on behalf of the applicant, please state in what capacity.

Signature	
Date	
Capacity	

Contact name (where not previously given) and postal address for correspondence associated with this application (please read guidance note 14) Andrew Wong Keystone Law 48 Chancery Lane			
Post town	London	Postcode	WC2A 1JF
Telephone number (if any)			
If you would prefer us to correspond with you by e-mail, your e-mail address (optional)			

Notes for Guidance

- Describe the premises, for example the type of premises, its general situation and layout and any other information which could be relevant to the licensing objectives. Where your application includes off-supplies of alcohol and you intend to provide a place for consumption of these off-supplies, you must include a description of where the place will be and its proximity to the premises.
- In terms of specific regulated entertainments please note that:
 - Plays: no licence is required for performances between 08:00 and 23.00 on any day, provided that the audience does not exceed 500.
 - Films: no licence is required for 'not-for-profit' film exhibition held in community premises between 08.00 and 23.00 on any day provided that the audience does not exceed 500 and the organiser (a) gets consent to the screening from a person who is responsible for the premises; and (b) ensures that each such screening abides by age classification ratings.
 - Indoor sporting events: no licence is required for performances between 08.00 and 23.00 on any day, provided that the audience does not exceed 1000.
 - Boxing or Wrestling Entertainment: no licence is required for a contest, exhibition or display of Greco-Roman wrestling, or freestyle wrestling between 08.00 and 23.00 on any day, provided that the audience does not exceed 1000. Combined

Hopsmiths – Proposed Conditions

1. Alcohol shall not be sold, supplied, consumed in or taken from the premises except during permitted hours. In this condition permitted hours means the authorised hours specified on this licence for the sale by retail of alcohol. This restriction does not prohibit:
 - a. during the first twenty minutes after the above hours the consumption of the alcohol on the premises;
 - b. during the first twenty minutes after the above hours, the taking of the alcohol from the premises unless the alcohol is supplied or taken in an open vessel;
 - c. during the first thirty minutes after the above hours the consumption of the alcohol on the premises by persons taking meals there if the alcohol was supplied for consumption as ancillary to the meals;
 - d. consumption of the alcohol on the premises or the taking of sale or supply of alcohol to any person residing in the licensed premises;
 - e. the ordering of alcohol to be consumed off the premises, or the despatch by the vendor of the alcohol so ordered;
 - f. the sale of alcohol to a trader or club for the purposes of the trade or club;
 - g. the sale or supply of alcohol to any canteen or mess, being a canteen in which the sale or supply of alcohol is carried out under the authority of the Secretary of State or an authorised mess of members of Her Majesty's naval, military or air forces;
 - h. the taking of alcohol from the premises by a person residing there; or
 - i. the supply of alcohol for consumption on the premises to any private friends of a person residing there who are bona fide entertained by him at his own expense, or the consumption of alcohol by persons so supplied; or
 - j. the supply of alcohol for consumption on the premises to persons employed there for the purposes of the business carried on by the holder of the licence, or the consumption of liquor so supplied, if the liquor is supplied at the expense of their employer or of the person carrying on or in charge of the business on the premises.
2. No person under fourteen shall be in the bar of the licensed premises during the permitted hours for the sale by retail of alcohol unless one of the following applies:
 - a. He is the child of the holder of the premises licence.
 - b. He resides in the premises, but is not employed there.
 - c. He is in the bar solely for the purpose of passing to or from some part of the premises which is not a bar and to or from which there is no other convenient means of access or egress.
 - d. The bar is in railway refreshment rooms or other premises constructed, fitted and intended to be used bona fide for any purpose to which the holding of the licence is ancillary.

In this condition "bar" includes any place exclusively or mainly used for the consumption of intoxicating liquor. But an area is not a bar when it is usual for it to be, and it is, set apart for the service of table meals and alcohol is only sold or supplied to persons as an ancillary to their table meals.

3. This licence is subject to such further conditions as are consistent with any restrictions imposed on the use of the premises for the existing licensable activities under the licence by virtue of the enactments hereinafter set out:

Children and Young Persons Act 1933
Cinematograph (Safety) Regulations 1955
Sporting Events (Control of Alcohol Etc) Act 1985

4. Any customer suspected of possessing or using drugs on the premises will be immediately removed from the premises by the DPS, barred from entering the premises again and shall be reported to the Police. Notices to this effect shall be prominently displayed on the premises.
5. The premises shall raise awareness of safer drinking and travel at night by use of the premises in house display boards, these board shall also prominently display local licence mini cab numbers.
6. Notices will be prominently displayed at exits requesting the public to respect the needs of local residents; to use the toilet facilities prior to leaving the premises; and to leave the premises and the area quietly.
7. The premises shall enforce a proof of age scheme, which is approved by the authorised officer of the Council and by the local Police.
8. No unaccompanied children will be allowed in the premises at any time. Children accompanied by an adult will vacate the premises by 20.00.

Carouse London Ltd – Proposal for the Hopsmiths 29 Crouch Hill N4 4AP



Introduction

In the spring of 2014 Carouse London Ltd was formed with the initial motivation of converting the Torriano, a small under loved pub in Kentish Town, North London into a thriving public house serving the community a diverse range of craft beers from all around the country, further afield and most importantly to showcase the wealth of craft breweries that have sprung up in the city over the past 7 years whose products we were noticing were in considerable growth around the capital.

Carouse London Ltd comprises Ben Caudell, Theo Caudell & Chris Hurd.

By Summer of the same year we had bought the lease on the premises, completely upgraded the décor, dispense system, sourced a whole range of bespoke products and some fantastic staff to serve them. On July 23rd 2014 The Rose & Crown was born, re acquainted with its original name, ready to serve the public.





The pub's previous guise had lost its way and was no longer a part of the broader community, we wanted to re-open the business to all sections of the area's population so that the pub could be used as a community hub.

The Rose & Crown provides a quality product range across the board including showcasing the best breweries across London & further afield. A bespoke wine and spirit range to compliment. Our food offer showcases the best in London Street food, operating pop up kitchens on a 3-6 month rotation. Giving Local business a platform from which to grow & springboard. An example of this is www.coqfighter.com who operated their first long term pop up kitchen at the Rose & Crown and have since moved on to operate two restaurants, one in Croydon boxpark and one in Shoreditch.

The opening and subsequent operation of the Rose & Crown has not gone unnoticed, winning best pub in Kentish town & Tufnell park 2014 and 2015 <http://www.timeout.com/london/things-to-do/kentish-town-a-locals-guide>



also appeared in the top ten new openings of 2014 in the Kentish town area
<http://www.kentishtowner.co.uk/2014/12/19/top-10-new-openings-2014-revealed/>

Key personal & company directors



The key personnel and founders of Carouse London Ltd are from Left to right Ben Caudell, Christopher Hurd and Theo Caudell.

Christopher Hurd (Operations Manager)

Chris has been running the operational side of venues for fifteen years, ranging from niche drinking establishments to high footfall nightclubs.

After working within a number of different businesses he discovered his niche running high foot-fall, multi-faceted businesses, putting structured operational foundations into practice, thus increasing the productivity and profitability of independent venues.

Since joining The Colombo Group in 2008 he made the transition from Assistant Manager of one site to Operations Manager of three, showing consistency and efficiency across the running of this diverse group of businesses.

Since the creation of Carouse London Ltd and the Rose & Crown Chris has been running the operational side of the business. Ensuring systems are in place for the provision of health & safety, fire safety, HR to ensure smooth succession in the event of expansion. Chris takes responsibility for all licensing adherence and liaison with all agencies including fire department, police, Environmental health and neighbourhood watch to ensure that the long term health of the business is good. Chris will work across both sites moving forward ensuring healthy relationships with licensing, nearby residents and all associated agencies to ensure the long term viability of the business.

Ben Caudell (Finance manager)

Since the inception of Carouse Ben has been responsible for the companies finances and all associated activities, keeping the companies finances healthy, working with our bookkeeper Sam, Ben ensures organization of payments of suppliers and services and that cash flow has stayed healthy and that VAT payments are provided for ect. Moving forward Ben would look after the financial and administrative side of both sites

Theo Caudell (Purchasing manager)

For the past six years Theo has been working for Barmetrix as a consultant in the bar/pub/club industry with clients spread all over London. As part of his job specification, Theo has been studying and analysing the sales quantities for itemized products.

Theo spearheads the companies purchasing in terms of new products. With an ever-growing number of breweries in the uk, spread across London and more further afield. Theo keeps us ahead of the game in terms of our beer list which will bring custom from a further flung audience seeking out rare and hard to find examples of beers from artisan breweries near and far

The Hopsmiths

The Hopsmiths (formally known as the Nobel) has been vacant now for around 9 months. In its latest incarnation whilst introducing a diverse beer list to the small cornerstone pub it failed to impress the community with its shortfalls in terms of comfort and product range. Being part of a company that operated number of other venues alongside a small brewery the collapse of the brewery in mid 2016 led to the liquidation of Hopsmiths and the unfortunate expiration of its license.

Following an extensive period of research on the surrounding area, investigating historic reviews and forum comments relating to the pub we believe we have the perfect formula to provide the area with a new community hub that we feel can serve the inhabitants of crouch hill with a quality product in terms of comfort, drinks, food, ambiance and atmosphere.

As well as providing a new personality and offer for the pub and completely repositioning the venue in the marketplace we will also go to great lengths to ensure that the new incarnation of the pub and its management, led by myself, goes to great lengths to align with the community and work alongside agencies to ensure the long term health of the business and position within its locality

Look forward to hearing from you

Many thanks

Christopher Hurd
Carouse London Ltd

IMPORTANT: Licensable activities can take place anywhere within the red line. The position of loose furniture and equipment is shown for diagrammatic purposes only. Any lighting adjustment is shown for diagrammatic purposes only. The fire risk assessment is not intended to be moved subject to the fire risk assessment carried out under the Regulatory Reform (Fire Safety) Order 2005 or by agreement with the fire officer.

- FIRE ALARM BREAK GLASS UNIT
- ILLUMINATED EXIT SIGN (ABOVE DOOR)
- FIRE ALARM PANEL
- FIRE BLANKET
- SMOKE DETECTOR (CEILING MOUNTED)
- PORTABLE FIRE EXTINGUISHER (CO, + FOAM)

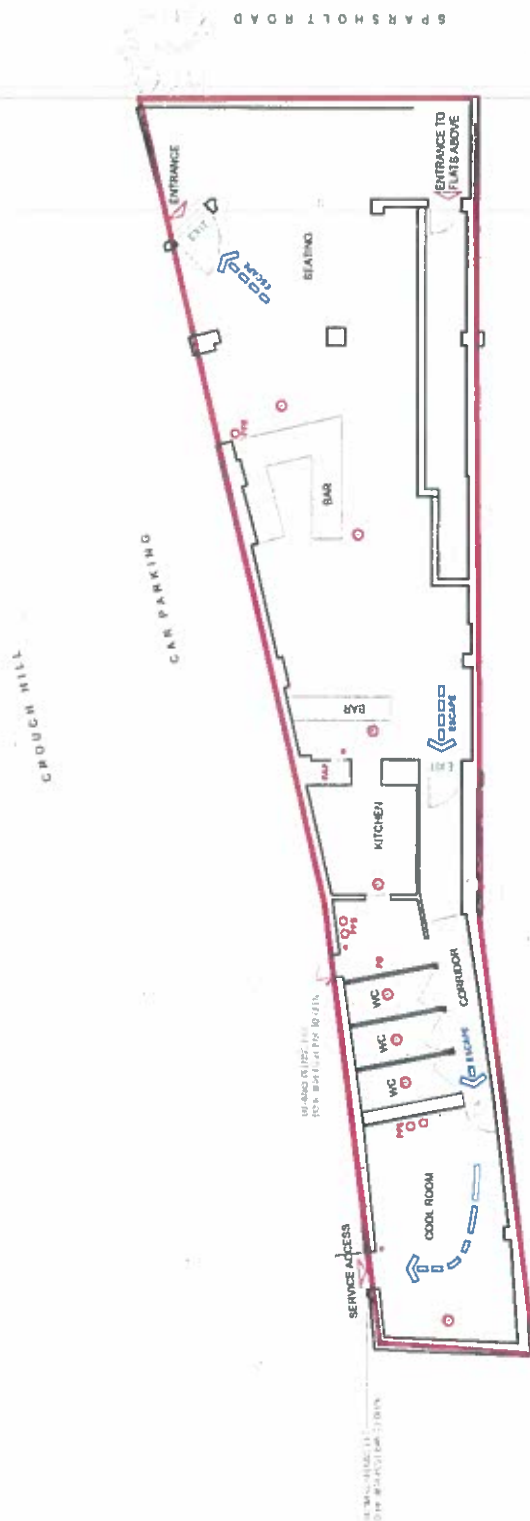

51605143

CAROUSEL LTD.

THE HOPKINS PUBLIC HOUSE
39 CROUCH HILL
CHICAGO, ILL. 44F

GROUND FLOOR FIRE PLAN LAYOUT

LEASE PLAN

100 @ A1 APRIL 2017 ICA

1111

RAY ...



ISLINGTON

**Islington Licensing Authority
Licensing Act 2003**

REPRESENTATION FORM FROM RESPONSIBLE AUTHORITIES

Responsible Authority Environmental Protection

Your Name	Anne Brothers	
Job Title	Noise Liaison Officer	
Postal and email address	222 Upper Street, London N1 1XR anne.brothers@islington.gov.uk	
Contact telephone number	020 7527 3047	
Name of the premises you are making a representation about	Hopsmiths	
Address of the premises you are making a representation about	29 Crouch Hill, London N4 4AP	
Which of the four licensing Objectives does your representation relate to?	Yes Or No	Please detail the evidence supporting your representation. Or the reason for your representation. Please use separate sheets if necessary
To prevent public nuisance	Yes	There is some history of noise nuisance from amplified sound to structurally adjoining dwellings. The premises is in a residential area.
Suggested conditions that could be added to the licence to remedy your representation or other suggestions you would like the Licensing Sub Committee to take into account. Please use separate sheets where necessary and refer to checklist.	See attached sheet	

Signed: Anne Brothers Date: 21 July 2017 _____

Please return this form along with any additional sheets to: Licensing Support Team, Public Protection, 222 Upper Street, London N1 1XR or email to licensing@islington.gov.uk

This form must be returned within the Statutory Period. For more details please check with the Licensing Support Team on 020 7527 3031

Suggested Noise Conditions for Hopsmiths, 29 Crouch Hill

- Noise or vibration must not emanate from the premises so as to cause a nuisance to nearby properties.
- The beer garden/outside drinking area shall be cleared of drinking customers by 22:00. After that time up to 6 customers shall be permitted to smoke on the frontage. No drinks shall be taken outside after 22:00
- Prominent, clear and legible notices must be displayed at all exits requesting the public to respect the needs of local residents and to leave the premises and the area quietly.
- The licensee shall appoint a noise consultant registered with the Institute of Acoustics or Association of Noise Consultants to survey locally in order to come to agreements with the council regarding maximum levels of amplified sound. This will include the installation of a noise limiting device, to prevent persons in the neighbourhood from being unreasonably disturbed by noise of music from the premises. The scheme of noise control shall be submitted for approval by the Council, and the approved scheme fully implemented to the satisfaction of the Council and the licensee notified in writing accordingly, prior to the premises being used for regulated entertainment. Agreed levels of sound shall be expressed on the premises licence.
- All pre-recorded music played through the in-house music system shall be controlled by an automatic electronic noise limiting device which restricts the sound system output to below pre-set threshold levels. All music from live bands, or DJs utilising their own amplification equipment, shall be controlled by a continual music noise level monitoring device which cuts the power supply to the sound system if a pre-set threshold is exceeded.
- The entertainment noise control system shall be monitored, checked and calibrated as necessary, so that the levels approved by the Council, are not exceeded.
- The controls for the entertainment noise control system shall be located in a secure, lockable cupboard or similar location. The entertainment noise control system is to be independent of control by persons other than the licensee. Access to the entertainment noise control system is to be restricted to the Licensee or a designated manager.
- Doors and windows to the premises will be kept closed, so far as practicable, at all times when noise generating regulated entertainment is taking place i.e. live and recorded music.
- Bottling out from the premises is prohibited between 23:00 hours and 08:00 hours.
- In the event of a noise complaint substantiated by an authorised officer, the licensee shall take appropriate measures in order to prevent any recurrence.
- The delivery of licensable goods shall be restricted to the hours between 09:00 and 19:00 Monday-Saturday. No deliveries shall be made on a Sunday or Bank Holiday.
- There shall be no collections of refuse or bottles between the hours of 23:00 and 08:00.
- Exterior lighting shall be directed away from residential properties.
- Any off sales shall be limited to drinks in sealed containers for customers to take away and consume at home.

Your New License Application

Our Licensing/NI

Date: 03/08/2017



New Licenses Application

Hopsmiths

29 Crouch Hill
London
N4 4AP

**METROPOLITAN POLICE
SERVICE**
Islington Police Licensing Team
Islington Police Station
2 Tolpuddle Street
London
N1 0YY

Telephone: 07799133204

Email:

Licensingpolice@islington.gov.uk

Date 3rd August 2017

Dear Sir

Re: Premises License New: HOPSMITHS 29 CROUCH HILL LONDON N4 4AP

With reference to the above application, I am writing to inform you that the Metropolitan Police, as a Responsible Authority, will be objecting to this application to vary the License as it is our belief that if granted the application would undermine the Licensing Objective, The prevention of Crime & Disorder.

Upon receipt of the above application I emailed the applicants agent on 25/07/2017 putting forward suggested conditions concerning the use of CCTV and the reporting of serious assaults, both conditions aimed at assisting in the prevention of crime and disorder. I also asked a question about what form the proposed off sales would take. I requested a response within 7 days to allow me to fully process the application. At the time of writing this representation I have still not had a response from neither the applicant nor their agent. I am disappointed at this lack of response as it does not bode well for future communication with the venue if a license was to be granted.

It is for these reasons that we are objecting to the application and propose that it is refused.

If the Committee is minded to grant the license then I would put forward the following.

No off sales, unless the applicant can give a full and detailed explanation as to what form these sales will take and how they will be controlled.

CCTV:

- **CCTV shall be installed, operated and maintained, at all times that the premises is open for licensable activities, so as to comply with the following criteria:**
- **The licensee will ensure that the system is checked every two weeks to ensure that the system is working properly and that the date and time are correct. A record of these checks, showing the date and name of the person checking, shall be kept and made available to Police or authorised Council officers on request;**
- **One camera will show a close-up of the entrance to the premises, to capture a clear, full length image of anyone entering;**
- **The system will provide full coverage of the interior of the premises and any exterior part of the premises accessible to the public;**
- **The system shall record in real time and recordings will be date and time stamped;**

- **Recordings will be kept for a minimum of 31 days and downloaded footage will be provided free of charge to Police or authorised Council officers on request (subject to the Data Protection Act 1998) within 24 hours of any request; &**
- **At all times, there will be a person on the premises who can operate the system sufficiently to allow Police or authorised Council officers to view footage on request and to supply a copy of footage immediately to Police to assist with the immediate investigation of an offence.**

Serious Assaults:

- **In the event that a serious assault is committed on the premises (or appears to have been committed) the management will immediately ensure that:**
- **The police (and, where appropriate, the London Ambulance Service) are called without delay;**
- **All measures that are reasonably practicable are taken to apprehend any suspects pending the arrival of the police;**
- **The crime scene is preserved so as to enable a full forensic investigation to be carried out by the police; and**
- **Such other measures are taken (as appropriate) to fully protect the safety of all persons present on the premises.**

Should you wish to discuss the matter further please contact us on Mobile 07799133204 or via email, Licensingpolice@islington.gov.uk

Yours sincerely
Islington Police Licensing Team
Steven Harrington Pc 2425CN
Ed Joseph Ps 259CN
Petros Loizou Pc 3757CN

Licensing Act 2003 representation pro-forma

Should you wish to comment on the licence application please use this form to help you. Please feel free to attach additional sheets.

You do not have to make any comment, and comments may be made in support of as well as against the application, providing they refer to one or more of the licensing objectives (please see the guidance notes for further advice).

Premises Name and address:

Hopsmiths, 29 Crouch Hill, Islington, London, N4 4AP

Your Name:

[REDACTED]

Interest:

RESIDENT

(E.g. resident, business, TRA Chair, Councillor, solicitor)

Your Address:

[REDACTED]

Email:

[REDACTED]

Telephone:

Please comment on the licensing objectives below relevant to your concerns or observations, you may also wish to include suggestions how your concerns could be addressed:

Public Nuisance. This premises is on the corner of a quiet residential street. It has open-air areas both front and back. When it was open before, the noise from these areas was sometimes very disturbing, with drinkers thick on the pavement. I can accept this in an established place - within reason - but would object very strongly to the opening hours being extended at night.

Crime and Disorder

Protection of Children from Harm

Public Safety

I wish my identity to be kept anonymous: **Yes** / No

We will treat representations as anonymous where there is a genuine reason to do so; if you wish your name and address details to be withheld then please explain the reason:

Copies of this representation will be sent to the applicant, or their agent/solicitor, including name and address details (but other personal contact information such as telephone numbers and email addresses will be removed) unless you have specifically requested anonymity. Copies of this representation will be included in a report that will be available to the public and will be published on the internet; however the published on-line version of the report will have name and address details removed.

Signature: 

Date: 28.07.17

Please ensure name and address details completed above

Return to:

Licensing Service
London Borough of Islington
3rd Floor
222 Upper Street
London N1 1XR

or send by email to:

licensing@islington.gov.uk

Suggested conditions of approval consistent with the operating schedule

1. Alcohol shall not be sold, supplied, consumed in or taken from the premises except during permitted hours. In this condition permitted hours means the authorised hours specified on this licence for the sale by retail of alcohol. This restriction does not prohibit:
 - a) during the first twenty minutes after the above hours the consumption of the alcohol on the premises;
 - b) during the first twenty minutes after the above hours, the taking of the alcohol from the premises unless the alcohol is supplied or taken in an open vessel;
 - c) during the first thirty minutes after the above hours the consumption of the alcohol on the premises by persons taking meals there if the alcohol was supplied for consumption as ancillary to the meals;
 - d) consumption of the alcohol on the premises or the taking of sale or supply of alcohol to any person residing in the licensed premises;
 - e) the ordering of alcohol to be consumed off the premises, or the despatch by the vendor of the alcohol so ordered;
 - f) the sale of alcohol to a trader or club for the purposes of the trade or club;
 - g) the sale or supply of alcohol to any canteen or mess, being a canteen in which the sale or supply of alcohol is carried out under the authority of the Secretary of State or an authorised mess of members of Her Majesty's naval, military or air forces;
 - h) the taking of alcohol from the premises by a person residing there; or
 - i) the supply of alcohol for consumption on the premises to any private friends of a person residing there who are bona fide entertained by him at his own expense, or the consumption of alcohol by persons so supplied; or
 - j) the supply of alcohol for consumption on the premises to persons employed there for the purposes of the business carried on by the holder of the licence, or the consumption of liquor so supplied, if the liquor is supplied at the expense of their employer or of the person carrying on or in charge of the business on the premises.
2. No person under fourteen shall be in the bar of the licensed premises during the permitted hours for the sale by retail of alcohol unless one of the following applies:
 - a) He is the child of the holder of the premises licence.
 - b) He resides in the premises, but is not employed there.
 - c) He is in the bar solely for the purpose of passing to or from some part of the premises which is not a bar and to or from which there is no other convenient means of access or egress.
 - d) The bar is in railway refreshment rooms or other premises constructed, fitted and intended to be used bona fide for any purpose to which the holding of the licence is ancillary.

In this condition "bar" includes any place exclusively or mainly used for the consumption of intoxicating liquor. But an area is not a bar when it is usual for it to be, and it is, set apart for the service of table meals and alcohol is only sold or supplied to persons as an ancillary to their table meals.
3. This licence is subject to such further conditions as are consistent with any restrictions imposed on the use of the premises for the existing licensable activities under the licence by virtue of the enactments hereinafter set out:

Children and Young Persons Act 1933

Cinematograph (Safety) Regulations 1955

Sporting Events (Control of Alcohol Etc) Act 1985

4. Any customer suspected of possessing or using drugs on the premises will be immediately removed from the premises by the DPS, barred from entering the premises again and shall be reported to the Police. Notices to this effect shall be prominently displayed on the premises.
5. The premises shall raise awareness of safer drinking and travel at night by use of the premises in house display boards, these board shall also prominently display local licence mini cab numbers.
6. Notices will be prominently displayed at exits requesting the public to respect the needs of local residents; to use the toilet facilities prior to leaving the premises; and to leave the premises and the area quietly.
7. The premises shall enforce a proof of age scheme, which is approved by the authorised officer of the Council and by the Local Police.
8. No unaccompanied children will be allowed in the premises at any time. Children accompanied by an adult will vacate the premises by 20.00.
9. The licensee shall adopt the Challenge 25 and the BII National Standards Proof of Age Scheme

Suggested conditions of approval suggested by the Police

10. CCTV shall be installed, operated and maintained, at all times that the premises is open for licensable activities, so as to comply with the following criteria:
 - a. The licensee will ensure that the system is checked every two weeks to ensure that the system is working properly and that the date and time are correct. A record of these checks, showing the date and name of the person checking, shall be kept and made available to Police or authorised Council officers on request;
 - b. The Police must be informed if the system will not be operating for longer than one day of business for any reason;
 - c. One camera will show a close-up of the entrance to the premises, to capture a clear, full length image of anyone entering;
 - d. The system will provide coverage of any exterior part of the premises accessible to the public;
 - e. The system shall record in real time and recordings will be date and time stamped;
 - f. Recordings will be kept for a minimum of 31 days and downloaded footage will be provided free of charge to Police or authorised Council officers on request (subject to the Data Protection Act 1998) within 24 hours of any request; &
 - g. At all times, there will be a person on the premises who can operate the system sufficiently to allow Police or authorised Council officers to view footage on request.
11. In the event that a serious assault is committed on the premises (or appears to have been committed) the management will immediately ensure that:
 - a. The police (and, where appropriate, the London Ambulance Service) are called without delay;
 - b. All measures that are reasonably practicable are taken to apprehend any suspects pending the arrival of the police;
 - c. The crime scene is preserved so as to enable a full forensic investigation to be carried out by the police; and
 - d. Such other measures are taken (as appropriate) to fully protect the safety of all persons present on the premises.

Suggested conditions of approval suggested by the Pollution Team

12. Noise and vibration must not emanate from the premises so as to cause a nuisance to nearby properties.
13. The beer garden/outside drinking area shall be cleared of drinking customers by 22:00. After that time up to 6 customers shall be permitted to smoke on the frontage. No drinks shall be taken outside after 22:00

- 14 Prominent, clear and legible notices must be displayed at all exits requesting the public to respect the needs of local residents and to leave the premises and the area quietly.
- 15 The licensee shall appoint a noise consultant registered with the Institute of Acoustics or Association of Noise Consultants to survey locally in order to come to agreements with the council regarding maximum levels of amplified sound. This will include the installation of a noise limiting device, to prevent persons in the neighbourhood from being unreasonably disturbed by noise of music from the premises. The scheme of noise control shall be submitted for approval by the Council, and the approved scheme fully implemented to the satisfaction of the Council and the licensee notified in writing accordingly, prior to the premises being used for regulated entertainment. Agreed levels of sound shall be expressed on the premises licence.
- 16 All pre-recorded music played through the in-house music system shall be controlled by an automatic electronic noise limiting device which restricts the sound system output to below pre-set threshold levels. All music from live bands, or DJs utilising their own amplification equipment, shall be controlled by a continual music noise level monitoring device which cuts the power supply to the sound system if a pre-set threshold is exceeded.
- 17 The entertainment noise control system shall be monitored, checked and calibrated as necessary, so that the levels approved by the Council, are not exceeded.
- 18 The controls for the entertainment noise control system shall be located in a secure, lockable cupboard or similar location. The entertainment noise control system is to be independent of control by persons other than the licensee. Access to the entertainment noise control system is to be restricted to the Licensee or a designated manager.
- 19 •Doors and windows to the premises will be kept closed, so far as practicable, at all times when noise generating regulated entertainment is taking place i.e. live and recorded music.
- 20 Bottling out from the premises is prohibited between 23:00 hours and 08:00 hours.
- 21 In the event of a noise complaint substantiated by an authorised officer, the licensee shall take appropriate measures in order to prevent any recurrence.
- 22 The delivery of licensable goods shall be restricted to the hours between 09:00 and 19:00 Monday-Saturday. No deliveries shall be made on a Sunday or Bank Holiday.
- 23 There shall be no collections of refuse or bottles between the hours of 23:00 and 08:00.
- 24 •Exterior lighting shall be directed away from residential properties.
- 25 Any off sales shall be limited to drinks in sealed containers for customers to take away and consume at home.

Title: 29 Crouch Hill

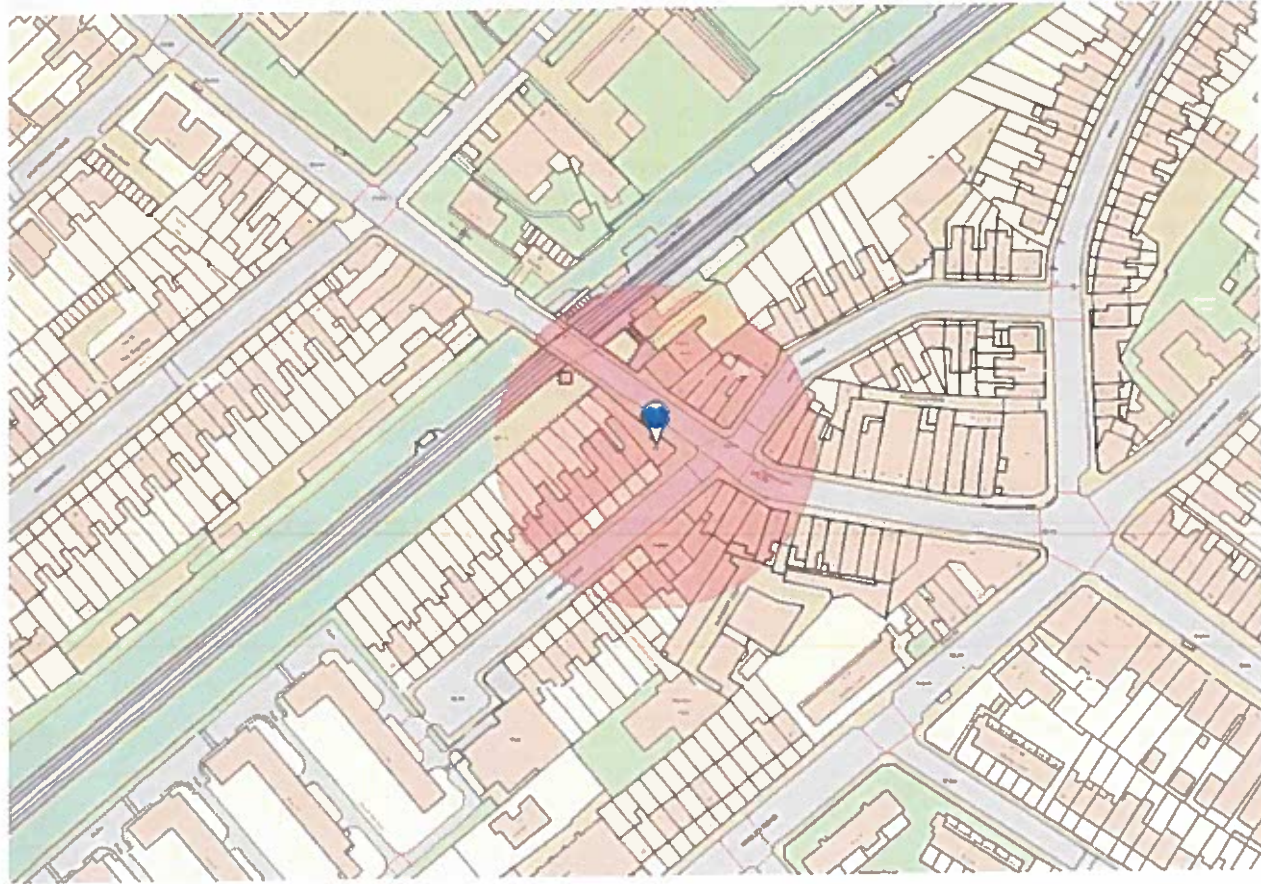

Printed By:
RO RO

Printed At:
30-08-2017