



Report of: **Service Director, Public Protection**

Meeting of	Date	Agenda Item	Ward(s)
Licensing Sub-Committee	18 th April 2013	B2	St. Mary's

Delete as appropriate		Non-exempt
-----------------------	--	------------

Subject: PREMISES LICENCE NEW APPLICATION
RE: MOONLIGHT SUPERMARKET, 131-133 HOLLOWAY ROAD, LONDON, N7 8LX.

1. Synopsis

- 1.1 This is an application for a new premise licence under the Licensing Act 2003.
- 1.2 The new application is to:
 - i) Allow the sale by retail of alcohol, off supplies only, 24 hours a day 7 days a week.

2. Recommendations

- 2.1 To determine the application for a new premises licence under Section 17 of the Licensing Act 2003.
- 2.2 To consider the representation from the Police in the light of the revised Secretary of State Guidance to Local Authorities issued on 25th April 2012 namely:

The Licensing Authority should accept all reasonable and proportionate representations made by the Police unless the Authority has evidence that to do so would not be appropriate for the promotion of the Licensing Objectives.
- 2.3 To consider that this address is in the Holloway and Finsbury Park Saturation or "Cumulative Impact Policy" of Islington. This special policy creates a rebuttable presumption that applications for new premises licences, club premises certificates, or variation applications that are likely to add to the existing cumulative impact will normally be refused, unless the applicant can demonstrate why the operation of the premises involved will not add to the cumulative impact or otherwise impact adversely on the promotion of the licensing objectives.

- 2.4 If the Committee grants the application it should be subject to:
- i. conditions prepared by the Licensing Officer which are consistent with the Operating Schedule (See appendix 3);
 - ii. conditions recommended by responsible Authorities (see appendix 3);
 - iii. any conditions deemed necessary by the Committee to promote the four licensing objectives.

3. Background

3.1 Papers are attached as follows:-

- Appendix 1: application form;
Appendix 2: representations;
Appendix 3: suggested conditions and map of premise location.

3.2 Proposed licensee, Mr Cihangir Eren, currently holds a 24 hours licence for the sale of alcohol, off supplies only, for the premises situated at 135 Holloway Road.

3.3 The Licensing Authority has received 4 letters of representation, none of which are from people who requested that they remain anonymous.

4. Planning Implications

4.1 No planning issues have been identified.

5. Conclusion and reasons for recommendations

5.1 The Council is required to consider this application in the light of all relevant information, and if approval is given, it may attach such conditions necessary to promote the licensing objectives.

Background papers:

The Council's Statement of Licensing Policy

Licensing Act 2003

Secretary of States Guidance

Final Report Clearance

Signed by

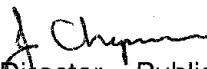
Service Director – Public Protection

Date 8/4/13

Received by

Head of Scrutiny and Democratic Services

Date

Report author: Licensing Service

Tel: 020 7527 3031

Fax: 020 7527 3430

E-mail: licensing@islington.gov.uk

wc/201303157

Appendix 1.
App. Received + Ok.
5th Feb 2013
MTW.

Application for a premises licence to be granted under the Licensing Act 2003

PLEASE READ THE FOLLOWING INSTRUCTIONS FIRST

Before completing this form please read the guidance notes at the end of the form. If you are completing this form by hand please write legibly in block capitals. In all cases ensure that your answers are inside the boxes and written in black ink. Use additional sheets if necessary. You may wish to keep a copy of the completed form for your records.

I/We CIHANGIR EREN

(Insert name(s) of applicant)

apply for a premises licence under section 17 of the Licensing Act 2003 for the premises described in Part 1 below (the premises) and I/we are making this application to you as the relevant licensing authority in accordance with section 12 of the Licensing Act 2003

Part 1 - Premises Details

Postal address of premises or, if none, ordnance survey map reference or description MOONLIGHT SUPERMARKET 131-133, HOLLOWAY ROAD			
Post town	LONDON	Post code	N7 8LX

Telephone number at premises (if any)	
Non-domestic rateable value of premises	£14750

COMMERCIAL LICENSING

Part 2 - Applicant Details

Please state whether you are applying for a premises licence as

Please tick yes

- a) an individual or individuals * please complete section (A)
- b) a person other than an individual *
 - i. as a limited company please complete section (B)
 - ii. as a partnership please complete section (B)
 - iii. as an unincorporated association or please complete section (B)
 - iv. other (for example a statutory corporation) please complete section (B)
- c) a recognised club please complete section (B)
- d) a charity please complete section (B)

LONDON COUNCIL LICENSING	
DATE 5/2/13	FEE PAID 190.00
000861	
54500	115
AP1	

- e) the proprietor of an educational establishment please complete section (B)
- f) a health service body please complete section (B)
- g) a person who is registered under Part 2 of the Care Standards Act 2000 (c14) in respect of an independent hospital please complete section (B)
- h) the chief officer of police of a police force in England and Wales please complete section (B)

* If you are applying as a person described in (a) or (b) please confirm:

Please tick yes

- I am carrying on or proposing to carry on a business which involves the use of the premises for licensable activities; or
- I am making the application pursuant to a
 - statutory function or
 - a function discharged by virtue of Her Majesty's prerogative

(A) INDIVIDUAL APPLICANTS (fill in as applicable)

Mr <input checked="" type="checkbox"/>	Mrs <input type="checkbox"/>	Miss <input type="checkbox"/>	Ms <input type="checkbox"/>	Other Title (for example, Rev)	
Surname EREN			First names CIHANGER		
I am 18 years old or over				<input checked="" type="checkbox"/> Please tick yes	
Current postal address if different from premises address		8 KARIBA CLOSE			
Post Town	LONDON		Postcode	N9 0FR	
Daytime contact telephone number					
E-mail address (optional)					

SECOND INDIVIDUAL APPLICANT (if applicable)

Mr <input type="checkbox"/>	Mrs <input type="checkbox"/>	Miss <input type="checkbox"/>	Ms <input type="checkbox"/>	Other Title (for example, Rev)	
Surname			First names		
I am 18 years old or over				<input type="checkbox"/> Please tick yes	

Current postal address if different from premises address			
Post Town		Postcode	
Daytime contact telephone number			
E-mail address (optional)			

(B) OTHER APPLICANTS

Please provide name and registered address of applicant in full. Where appropriate please give any registered number. In the case of a partnership or other joint venture (other than a body corporate), please give the name and address of each party concerned.

Name
Address
Registered number (where applicable)
Description of applicant (for example, partnership, company, unincorporated association etc.)
Telephone number (if any)
E-mail address (optional)

Part 3 Operating Schedule

When do you want the premises licence to start?

Day		Month		Year	
0	7	0	3	2	0
1	3	1	3		

If you wish the licence to be valid only for a limited period, when do you want it to end?

Day		Month		Year	
1	1	1	1	1	1
1	1	1	1	1	1

Please give a general description of the premises (please read guidance note1)
The premises is a tradition shop consisting of a ground floor, located on a major road.

Please refer to the enclosed plan.

If 5,000 or more people are expected to attend the premises at any one time, please state the number expected to attend.

What licensable activities do you intend to carry on from the premises?

(Please see sections 1 and 14 of the Licensing Act 2003 and Schedules 1 and 2 to the Licensing Act 2003)

Provision of regulated entertainment

Please tick yes

- a) plays (if ticking yes, fill in box A)
- b) films (if ticking yes, fill in box B)
- c) indoor sporting events (if ticking yes, fill in box C)
- d) boxing or wrestling entertainment (if ticking yes, fill in box D)
- e) live music (if ticking yes, fill in box E)
- f) recorded music (if ticking yes, fill in box F)
- g) performances of dance (if ticking yes, fill in box G)
- h) anything of a similar description to that falling within (e), (f) or (g) (if ticking yes, fill in box H)

Provision of entertainment facilities:

- i) making music (if ticking yes, fill in box I)
- j) dancing (if ticking yes, fill in box J)
- k) entertainment of a similar description to that falling within (i) or (j) (if ticking yes, fill in box K)

Provision of late night refreshment (if ticking yes, fill in box L)

Supply of alcohol (if ticking yes, fill in box M)

In all cases complete boxes N, O and P

A

Plays Standard days and timings (please read guidance note 6)			Will the performance of a play take place indoors or outdoors or both – please tick (please read guidance note 2)	Indoors	<input type="checkbox"/>
				Outdoors	<input type="checkbox"/>
				Both	<input type="checkbox"/>
Day	Start	Finish	Please give further details here (please read guidance note 3)		
Mon					
Tue			State any seasonal variations for performing plays (please read guidance note 4)		
Wed					
Thur			Non standard timings. Where you intend to use the premises for the performance of plays at different times to those listed in the column on the left, please list (please read guidance note 5)		
Fri					
Sat					
Sun					

B

Films Standard days and timings (please read guidance note 6)			Will the exhibition of films take place indoors or outdoors or both – please tick (please read guidance note 2)	Indoors	<input type="checkbox"/>
				Outdoors	<input type="checkbox"/>
				Both	<input type="checkbox"/>
Day	Start	Finish	Please give further details here (please read guidance note 3)		
Mon					
Tue					
Wed			State any seasonal variations for the exhibition of films (please read guidance note 4)		
Thur					
Fri			Non standard timings. Where you intend to use the premises for the exhibition of films at different times to those listed in the column on the left, please list (please read guidance note 5)		
Sat					
Sun					

C

Indoor sporting events Standard days and timings (please read guidance note 6)			<u>Please give further details</u> (please read guidance note 3)
Day	Start	Finish	
Mon			
Tue			<u>State any seasonal variations for indoor sporting events</u> (please read guidance note 4)
Wed			
Thur			<u>Non standard timings. Where you intend to use the premises for indoor sporting events at different times to those listed in the column on the left, please list</u> (please read guidance note 5)
Fri			
Sat			
Sun			

D

Boxing or wrestling entertainments Standard days and timings (please read guidance note 6)			<u>Will the boxing or wrestling entertainment take place indoors or outdoors or both – please tick</u> (please read guidance note 2)	Indoors	<input type="checkbox"/>
				Outdoors	<input type="checkbox"/>
				Both	<input type="checkbox"/>
Day	Start	Finish	<u>Please give further details here</u> (please read guidance note 3)		
Mon					
Tue					
Wed			<u>State any seasonal variations for boxing or wrestling entertainment</u> (please read guidance note 4)		
Thur					
Fri			<u>Non standard timings. Where you intend to use the premises for boxing or wrestling entertainment at different times to those listed in the column on the left, please list</u> (please read guidance note 5)		
Sat					
Sun					

E

Live music Standard days and timings (please read guidance note 6)			Will the performance of live music take place indoors or outdoors or both – please tick (please read guidance note 2)	Indoors	<input type="checkbox"/>
				Outdoors	<input type="checkbox"/>
				Both	<input type="checkbox"/>
Day	Start	Finish	Please give further details here (please read guidance note 3)		
Mon					
Tue					
Wed			State any seasonal variations for the performance of live music (please read guidance note 4)		
Thur					
Fri					
Sat					
Sun					

F

Recorded music Standard days and timings (please read guidance note 6)			Will the playing of recorded music take place indoors or outdoors or both – please tick (please read guidance note 2)	Indoors	<input type="checkbox"/>
				Outdoors	<input type="checkbox"/>
				Both	<input type="checkbox"/>
Day	Start	Finish	Please give further details here (please read guidance note 3)		
Mon					
Tue					
Wed			State any seasonal variations for the playing of recorded music (please read guidance note 4)		
Thur					
Fri			Non standard timings. Where you intend to use the premises for the playing of recorded music at different times to those listed in the column on the left, please list (please read guidance note 5)		
Sat					
Sun					

G

Performances of dance Standard days and timings (please read guidance note 6)			Will the performance of dance take place indoors or outdoors or both – please tick (please read guidance note 2)	Indoors	<input type="checkbox"/>
				Outdoors	<input type="checkbox"/>
				Both	<input type="checkbox"/>
Day	Start	Finish			
Mon			Please give further details here (please read guidance note 3)		
Tue			State any seasonal variations for the performance of dance (please read guidance note 4)		
Wed			Non standard timings. Where you intend to use the premises for the performance of dance at different times to those listed in the column on the left, please list (please read guidance note 5)		
Thur					
Fri					
Sat					
Sun					

H

Anything of a similar description to that falling within (e), (f) or (g) Standard days and timings (please read guidance note 6)			<u>Please give a description of the type of entertainment you will be providing</u>		
Day	Start	Finish	<u>Will this entertainment take place indoors or outdoors or both – please tick</u> (please read guidance note 2)	Indoors	<input type="checkbox"/>
Mon				Outdoors	<input type="checkbox"/>
				Both	<input type="checkbox"/>
Tue			<u>Please give further details here</u> (please read guidance note 3)		
Wed					
Thur			<u>State any seasonal variations for entertainment of a similar description to that falling within (e), (f) or (g)</u> (please read guidance note 4)		
Fri					
Sat			<u>Non standard timings. Where you intend to use the premises for the entertainment of a similar description to that falling within (e), (f) or (g) at different times to those listed in the column on the left, please list</u> (please read guidance note 5)		
Sun					

I

Provision of facilities for making music Standard days and timings (please read guidance note 6)			<u>Please give a description of the facilities for making music you will be providing</u>	
			<u>Will the facilities for making music be indoors or outdoors or both – please tick</u> (please read guidance note 2)	
			Indoors	<input type="checkbox"/>
			Outdoors	<input type="checkbox"/>
			Both	<input type="checkbox"/>
Day	Start	Finish	<u>Please give further details here</u> (please read guidance note 3)	
Mon				
Tue				
Wed				
			<u>State any seasonal variations for the provision of facilities for making music</u> (please read guidance note 4)	
Thur			<u>Non standard timings. Where you intend to use the premises for provision of facilities for making music at different times to those listed in the column on the left, please list</u> (please read guidance note 5)	
Fri				
Sat				
Sun				

J

Provision of facilities for dancing Standard days and timings (please read guidance note 6)			Will the facilities for dancing be indoors or outdoors or both – please tick (see guidance note 2)	Indoors	<input type="checkbox"/>
				Outdoors	<input type="checkbox"/>
				Both	<input type="checkbox"/>
			<u>Please give a description of the facilities for dancing you will be providing</u>		
Day	Start	Finish			
Mon			<u>Please give further details here</u> (please read guidance note 3)		
Tue					
Wed			<u>State any seasonal variations for providing dancing facilities</u> (please read guidance note 4)		
Thur					
Fri			<u>Non standard timings. Where you intend to use the premises for the provision of facilities for dancing entertainment at different times to those listed in the column on the left, please list</u> (please read guidance note 5)		
Sat					
Sun					

K

Provision of facilities for entertainment of a similar description to that falling within i or j Standard days and timings (please read guidance note 6)			<u>Please give a description of the type of entertainment facility you will be providing</u>		
Day	Start	Finish	<u>Will the entertainment facility be indoors or outdoors or both – please tick</u> (please read guidance note 2)	Indoors	<input type="checkbox"/>
Mon				Outdoors	<input type="checkbox"/>
				Both	<input type="checkbox"/>
Tue			<u>Please give further details here</u> (please read guidance note 3)		
Wed					
Thur					
Fri			<u>State any seasonal variations for the provision of facilities for entertainment of a similar description to that falling within i or j</u> (please read guidance note 4)		
Sat					
Sun					
			<u>Non standard timings. Where you intend to use the premises for the provision of facilities for entertainment of a similar description to that falling within i or j at different times to those listed in the column on the left, please list</u> (please read guidance note 5)		

L

Late night refreshment Standard days and timings (please read guidance note 6)			Will the provision of late night refreshment take place indoors or outdoors or both – please tick (please read guidance note 2)	Indoors	<input type="checkbox"/>
				Outdoors	<input type="checkbox"/>
				Both	<input type="checkbox"/>
Day	Start	Finish	<u>Please give further details here</u> (please read guidance note 3)		
Mon					
Tue			<u>State any seasonal variations for the provision of late night refreshment</u> (please read guidance note 4)		
Wed					
Thur			<u>Non standard timings. Where you intend to use the premises for the provision of late night refreshment at different times, to those listed in the column on the left, please list</u> (please read guidance note 5)		
Fri					
Sat					
Sun					

M

Supply of alcohol Standard days and timings (please read guidance note 6)			Will the supply of alcohol be for consumption (Please tick box) (please read guidance note 7)	On the premises	<input type="checkbox"/>
				Off the premises	<input checked="" type="checkbox"/>
				Both	<input type="checkbox"/>
Day	Start	Finish	State any seasonal variations for the supply of alcohol (please read guidance note 4) The premises shall be open for licensable activities without limit. (24 Hour)		
Mon	00:00	00:00			
Tue	00:00	00:00			
Wed	00:00	00:00			
Thur	00:00	00:00			
Fri	00:00	00:00			
Sat	00:00	00:00			
Sun	00:00	00:00			
			Non standard timings. Where you intend to use the premises for the supply of alcohol at different times to those listed in the column on the left, please list (please read guidance note 5) N/A		

State the name and details of the individual whom you wish to specify on the licence as premises supervisor

Name CIHANGIR EREN	
Address	
Postcode	
Personal Licence number (if known)	
Issuing licensing authority (if known) ENFIELD COUNCIL	

N

Please highlight any adult entertainment or services, activities, other entertainment or matters ancillary to the use of the premises that may give rise to concern in respect of children (please read guidance note 8)

None.

O

Hours premises are open to the public Standard days and timings (please read guidance note 6)			State any seasonal variations (please read guidance note 4) The premises shall be open for licensable activities without limit.
Day	Start	Finish	Non standard timings. Where you intend the premises to be open to the public at different times from those listed in the column on the left, please list (please read guidance note 5)
Mon	00:00	00:00	
Tue	00:00	00:00	
Wed	00:00	00:00	
Thur	00:00	00:00	
Fri	00:00	00:00	
Sat	00:00	00:00	
Sun	00:00	00:00	

P Describe the steps you intend to take to promote the four licensing objectives:

a) General – all four licensing objectives (b,c,d,e) (please read guidance note 9)

PLEASE SEE ATTACHED PROPOSED CONDITIONS.

b) The prevention of crime and disorder

PLEASE SEE ATTACHED PROPOSED CONDITIONS.

c) Public safety

Appropriate fire safety procedures are in place including fire extinguishers (foam, H2O and CO2), fire blanket, internally illuminated fire exit signs, numerous smoke detectors and emergency lighting (see enclosed plan for details of locations). All appliances are inspected annually.

All emergency exits shall be kept free from obstruction at all times.

d) The prevention of public nuisance

All customers will be asked to leave quietly.

Clear and legible notices will be prominently displayed to remind customers to leave quietly and have regard to our neighbours.

e) The protection of children from harm

PLEASE SEE ATTACHED PROPOSED CONDITIONS.

Please tick yes

- I have made or enclosed payment of the fee
- I have enclosed the plan of the premises
- I have sent copies of this application and the plan to responsible authorities and others where applicable
- I have enclosed the consent form completed by the individual I wish to be premises supervisor, if applicable
- I understand that I must now advertise my application
- I understand that if I do not comply with the above requirements my application will be rejected

IT IS AN OFFENCE, LIABLE ON CONVICTION TO A FINE UP TO LEVEL 5 ON THE STANDARD SCALE, UNDER SECTION 158 OF THE LICENSING ACT 2003 TO MAKE A FALSE STATEMENT IN OR IN CONNECTION WITH THIS APPLICATION

Part 4 – Signatures (please read guidance note 10)

Signature of applicant or applicant's solicitor or other duly authorised agent (See guidance note 11). **If signing on behalf of the applicant please state in what capacity.**

Signature	
Date	5 th February 2013
Capacity	Agent for the Applicant

For joint applications signature of 2nd applicant or 2nd applicant's solicitor or other authorised agent. (please read guidance note 12). **If signing on behalf of the applicant please state in what capacity.**

Signature	
Date	
Capacity	

Contact name (where not previously given) and postal address for correspondence associated with this application (please read guidance note 13)

Jun Simon
ADA GROUP
167 STOKE NEWINGTON ROAD

Post town LONDON

Post code N16 8BP

Telephone number (if any) 0207 193 8393

If you would prefer us to correspond with you by e-mail your e-mail address (optional)

Proposed Conditions

- ~~No alcoholic goods will ever be purchased from sellers calling to the shop.~~
- ~~The licensee will immediately report to Trading Standards any instance of a caller to the shop attempting to sell alcohol.~~
- ~~No spirits in re-sealed cases will be purchased.~~
- ~~Invoices (or copies) for all alcoholic goods on the premises will be kept at the shop and made available to officers from the council, police or HMRC upon request.~~
- ~~A stock control system will be introduced, so that the licensee can quickly identify where and when alcoholic goods have been purchased.~~
- ~~An ultra-violet light will be available at the premises for the purpose of checking the UK Duty Stamp on spirits as soon as practical after they have been purchased.~~
- ~~If any spirits bought by the company have UK Duty Stamps that do not fluoresce under ultra-violet light, or are otherwise suspicious, the licensee shall identify the supplier to Islington Trading Standards and HMRC as soon as possible.~~
- ~~The licensee shall adopt the Challenge 25, the Retail of Alcohol Standards Group's advice for off-licences.~~
- ~~The licensee shall ensure that staff are trained about age-restricted products and ensure that they sign to confirm that they have understood the training. The licensee shall keep records of training and instruction given to staff.~~
- ~~The licensee shall put arrangements in place to ensure that before serving alcohol to young persons, staff ask to see accredited proof of age cards for example proof of age cards carrying the 'PASS' logo (and no others), a Passport, or UK Driving Licence bearing the photograph and date of birth of the bearer.~~
- ~~The licensee shall require staff to note any refusals to sell to young people in a refusals log. The refusals log shall be checked and signed monthly by the designated premises supervisor. The refusals log shall be made available for inspection by the licensing team, police or trading standards.~~
- A digital CCTV system shall be installed, operated and maintained inside and outside the premises [subject to planning permission] in agreement with the Police. The system will enable a frontal head and shoulders image of every person entering the premises. The system shall record in real time and operate whilst the premises are open for licensable activities. The recordings shall be kept available for a minimum of 31 days. A working copy shall be supplied free of charge to a Police Officer within 24 hours of any request to assist in the investigation of a crime or apprehending or prosecuting an offender. It is the responsibility of the premise to download any recording requests.
- Incident Book to be maintained and checked and signed weekly by DPS.

* for those conditions ruled out here see those agreed with Trading Standards.

Consent of individual to being specified as premises supervisor

CIHANGIR EREN

I

[full name of prospective premises supervisor]

of

[home address of prospective premises supervisor]

hereby confirm that I give my consent to be specified as the designated premises supervisor in relation to the application for

APPLICATION FOR NEW PREMISES LICENCE

[type of application]

by

CIHANGIR EREN

[name of applicant]

relating to a premises licence

N/A

[number of existing licence, if any]

for

MOONLIGHT SUPERMARKET,
131-133, HOLLOWAY ROAD,
LONDON,
N7 8LX

[name and address of premises to which the application relates]

and any premises licence to be granted or varied in respect of this application made by

CIHANGIR EREN

[name of applicant]

concerning the supply of alcohol at
MOONLIGHT SUPERMARKET,
131-133, HOLLOWAY ROAD,
LONDON,
N7 8LX

[name and address of premises to which application relates]

I also confirm that I am applying for, intend to apply for or currently hold a personal licence, details of which I set out below.

Personal licence number

[insert personal licence number, if any]

Personal licence issuing authority

ENFIELD COUNCIL
LICENSING TEAM
ENFIELD
EN1 3XH

[insert name and address and telephone number of personal licence issuing authority, if any]

Signed

Name (please print)

CIHANGIR EREN

Date

04/02/2013

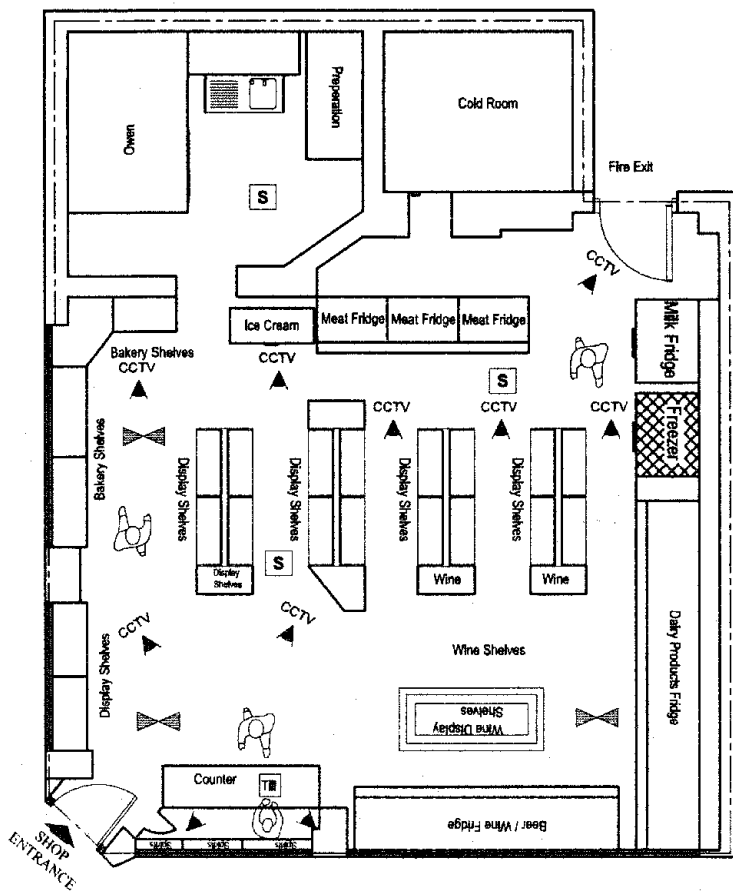

LEGEND

- FRIDGES
- FREEZER
- WC AREA
- AMBIT OF LICENSED PREMISES
- SAFETY LIGHTS
- CCTV
- S 20** FIRE ESCAPE KEEP CLEAR
- FIRE EXTINGUISHER
- SMOKE DETECTOR

Moon Light
Supermarket,

131-133 Holloway
Road, London,
N7 8LX

FLOOR PLAN

REF: VC-13-03

SCALE : 1/100@A4

DATE : 03/02/2013

The condition that is not copied, reproduced, retained or disclosed to any unauthorized person without the prior consent in written of ADA GROUP. Dimensions in mm. Not construction drawings.

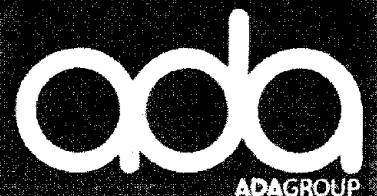

Appendix 2. ①

Your
Our Licensing/NI
Date: 7/2/2013



**METROPOLITAN POLICE
SERVICE
Robin Clark Ps 45NI
Islington Police Licensing Unit
Islington Police Station
2 Tolpuddle Street
London
N1 0YY**

Telephone: 020 7421 0194
Facsimile: 020 7421 0138
Email: ni_licensing@met.police.uk

Date

Ada Group
167 Stoke Newington Road
London
N16

Dear Sirs

Re: Moonlight Supermarket, 131-133 Holloway Road, N7

With reference to the above application, I am writing to inform you that the Metropolitan Police, as a Responsible Authority, will be objecting to this application as it is our belief that if granted the application would undermine the Licensing Objectives.

The venue is situated in the 'Holloway Road stress area', a locality where this is traditionally high crime and disorder and there are concerns that this application will cause further policing problems in an already demanding area.

It is for these reasons that we are objecting to the application.

Should you wish to discuss the matter further please contact your details on **0207 421 0194/0248** or via email, ni_licensing@met.police.uk

Yours sincerely,

Robin Clark Ps 45NI
Islington Police Licensing Team

Your

Our Licensing/NI

Date: 7/2/2013



**METROPOLITAN POLICE
SERVICE**

Robin Clark Ps 45NI
Islington Police Licensing Unit
Islington Police Station
2 Tolpuddle Street
London
N1 0YY

Telephone: 020 7421 0194
Facsimile: 020 7421 0138
Email: ni_licensing@met.police.uk

Date 22.02.2013

Ada Group
167 Stoke Newington Road
London
N16

Dear Sirs

Re: Moonlight Supermarket, 131-133 Holloway Road, N7

With reference to the above application, and further to my earlier letter on the matter I now include the crime statistics and other information relevant to the local of these premise. It is with these facts in mind that Det Ch Insp Wallace has made his comments regarding the application and it is on these facts that Islington Police object to the application for an Alcohol Licence in this " stress area "

Should you wish to discuss the matter further please contact your details on **0207 421 0194/0248** or via email, ni_licensing@met.police.uk

Yours sincerely.

Robin Clark Ps 45NI
Islington Police Licensing Team

Moonlight Supermarket (500m Radius)- Alcohol Related Crime:
January 2012-December 2012

Contents Page

1. Statement from DCI Wallace.....	2
2. Licensed Premises Map.....	3
3. Alcohol Related Violence.....	4
4. Alcohol Related Crime.....	5
5. Alcohol Related 999 Calls.....	6
6. London Ambulance Calls.....	7
7. Moonlight Supermarket Area Key Issues.....	8
8. Borough Comparison Figures.....	8

I formally oppose the granting of this licence application on behalf of Islington Police. This statement provides the rationale for my decision.

Over recent years Islington has experienced rapid growth in its night time economy. The cumulative effect of this is a heavy footfall of persons who are not resident in Islington Borough but who are present between the hours of 8pm and 6am to take advantage of the extremely vibrant night-time economy.

Unfortunately there has not been commensurate increase in public services. Each new license or extension of an existing license will create additional demand on a range of public services. There is a direct link between the number of persons in public places who have consumed alcohol and the number of violent assaults that take place in that public place. This 'new' business for the police will involve reporting and investigating more instances of theft, anti social behaviour, drunkenness and serious assaults. No additional police resource will be available to cope with this extra demand. More people will be the victims of crime and more people will be injured.

The number of Police personnel available both in terms of uniform deterrence and investigative capacity is at its lowest between the hours of 11pm and 8am. At a time when both Police resources are being severely squeezed long with the resources available to NHS I would strongly resist increasing the number of persons who have consumed alcohol onto the streets of Islington. I have dwindling resources to deal with the consequences. The average investigation into an allegation of Grievous Bodily Harm costs Islington Police £2000 to investigate. Last year Islington investigated over 350 such crimes. This takes no account of the costs to the NHS. It also takes no account of the thousands of alcohol-related Actual Bodily Harm and Common Assault investigations that are taken on by Islington Police every year.

In an area that is already saturated with Licensed Premises it is just not sustainable to keep increasing the number of people on those streets after midnight. No matter how well any establishment is run internally their very business case is based on growing the number of people who end up on the streets of Islington having been drinking. As local public services are already stretched then the inevitable consequence of granting more post-midnight licences is an increase in the number of victims of serious violence. I would ask that the licence application be rejected.

Detective Chief Inspector Steve Wallace
Islington Police

Licensed Premises within 500m of Moonlight Supermarket

The map below shows licensed premises within 500m of Moonlight Supermarket, 131-133 Holloway Road according to MapInfo Points of Interest dataset:

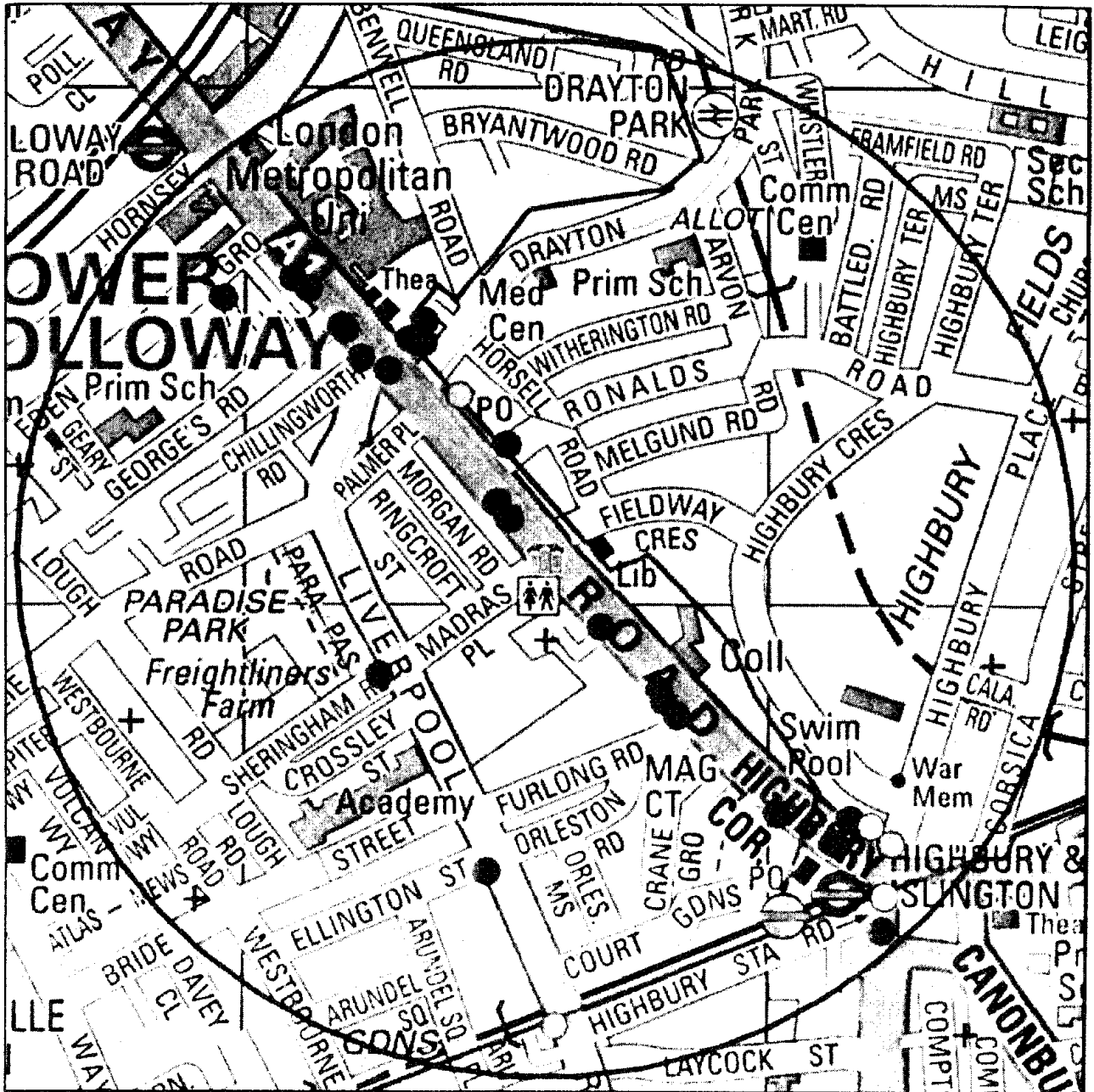

There are 9 pubs, 15 restaurants, 3 [unclear], and 2 [unclear] in this area.

Alcohol Related Violence

The maps and tables below show locations and hotspot areas for alcohol related violent crime offences within 500m of Moonlight Supermarket, and a breakdown of crime types and peak days/times:

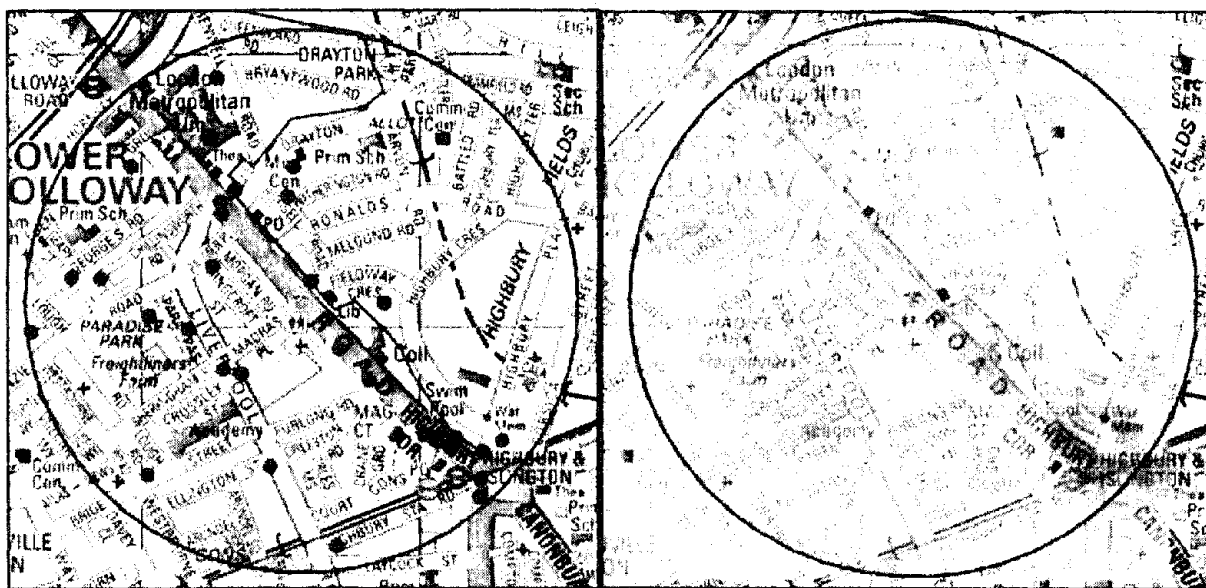

Most offences are located along the main roads, Holloway Road and Liverpool Road. The densest hotspot area is located around Highbury Corner/Highbury & Islington LU station.

Offence	Total
Crime Related Incident	1
GBH/Wound	2
Off Weapon	1
Pub Order S 5	1
Racial Agg Ass	1
Racial Agg Har	1
Rob pers	1
Shoplift <£200	1
Spec Investing	1
Grand Total	38

	Mon	Tue	Wed	Thu	Fri	Sat	Sun	Total
0800-1159	1	1						2
1200-1559	1	1				1	2	5
1600-1959						1	2	3
2000-2359		1		1	2			7
0000-0359				2				
0400-0759		1					1	5
Total	2	4	3	3	2			38

ABH and common assault were the most frequent types of alcohol violence. Saturday-Sunday are the peak days overall, with peak times between 0000-0400 hours. Alcohol related violence in this area equates to 5.5% of the borough total.

Alcohol Related Crime

The maps and tables below show locations and hotspot areas for all alcohol related crime offences, and a breakdown of crime types and peak days/times:

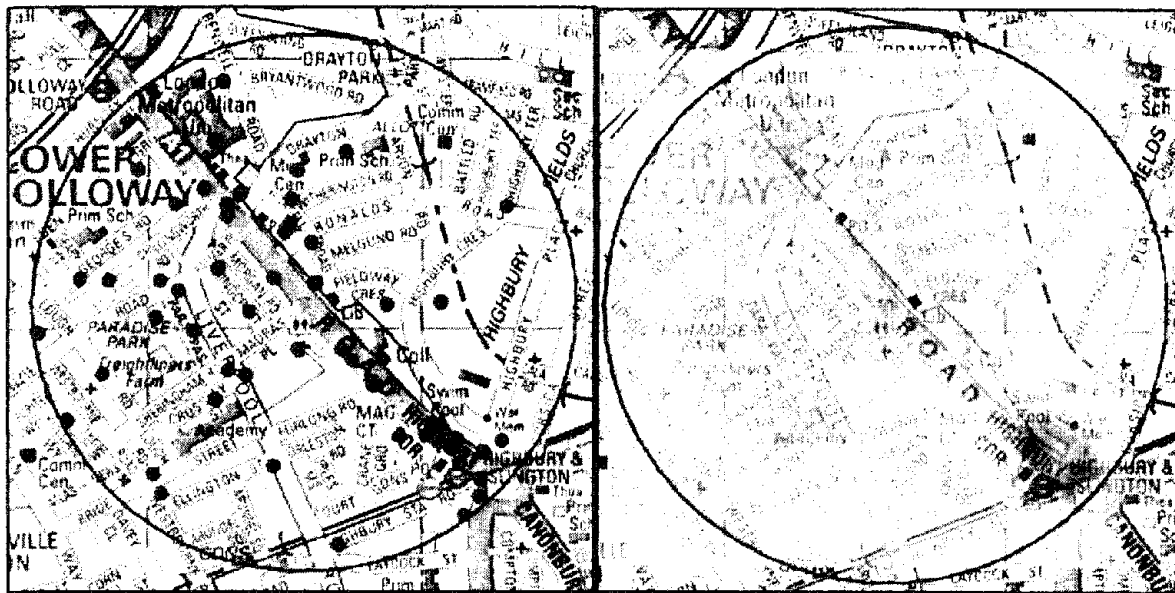

Highbury Corner is the densest hotspot for alcohol related crime in this area.

Offence	Total	Mon	Tue	Wed	Thu	Fri	Sat	Sun	Total
		1	2			2	1		6
		1	1	2			1	3	8
Spec Investing	11	1	2		1	1	1	3	9
Other theft	9	1	4		2	4		2	
Rob pers	9	1		3	4				
Shoplift <£200	6		2		1	1	3	2	9
ated Incident	3								
Crim Dam <£500	3								
Theft Person	3								
C/Dam Veh <£500	2								
GBH/Wound	2								
Sex Ass F	2								
Other offence	8								
Grand Total	90	5	11	15	8	8			90

ABH and common assault were the most frequent crimes. Saturday-Sunday were the busiest days overall with peak times being between 2000-0400 hours. Alcohol related crime in this area equates to 5.5% of the borough total.

999 Calls - Alcohol Qualifiers

The tables below show areas of high 999 call activity within the defined area that include an alcohol qualifier in the report, along with main call types and peak days/times:

CAD Call Type	Total
Violence offence	7
Concern for safety	5
Illness/injury	3
Suspicious circs	3
Other theft	2
Road related offence	2
Contact	2
Assistance required	2
Highway disruption	1
Animal problems	1
Street drinking	1
Begging	1
Abandoned call	1
Domestic incident	1
Misper	1
Grand Total	54

	Mon	Tue	Wed	Thu	Fri	Sat	Sun	Total
0800-1159		1				1		2
1200-1559	1		2		1	1		5
1600-1959			2		1			
2000-2359					1		1	
0000-0359	2		1	1	1			
0400-0759		1	2			1		8
Total	3	8		5	4			54

Calls regarding rowdy behaviour and police generated activity were most frequent in the area. Wednesday and Saturday-Sunday were the peak days, with peak times between 1600-0400 hours. Alcohol related calls in this area equates to 8.2% of the borough total overall.

Alcohol Issues - LBI Only

London Ambulance data indicates that between December 2011 and November 2012 (most recent data available) ambulances were called to 96 incidents in the area (Islington only) where alcohol was noted as a feature. Data mapped according to output areas highlights the area around Highbury Corner in the south, and Holloway Road near London Met university/Holloway Road in the north.

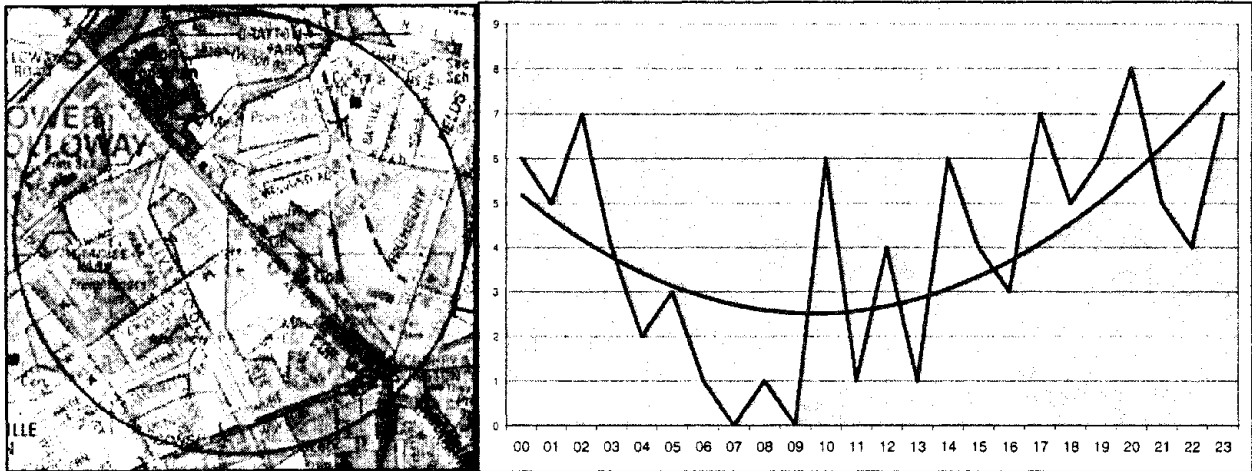

Temporal data for the town centre indicates that alcohol related attendances fluctuate throughout the day, but peak at 17:00, 20:00, and 02:00 hours. The general trend data indicates that call out levels were higher in the hours before midnight.

Key Issues

The figures for below highlight some of the key issues linked to alcohol and the night time economy within 500m of Moonlight Supermarket. Offences listed have occurred during the hours of 8pm to 6am between January 2012-December 2012.

- There were 93 violent offences, including:
 - 1 threat to kill
 - 6 GBH
- There were 423 property crimes, including 36 personal robberies.

Borough Comparison Figures

The figures below show borough wide statistics for alcohol violence, alcohol related offences, and 999 calls with an **alcohol qualifier**. The time period in question is January 2012-December 2012 unless stated:

- There were 692 violent offences involving alcohol.
- The borough suffered 1622 crimes with alcohol as a contributing factor.
- Police were called to 657 emergency calls involving alcohol.
- There were 1846 violence offences between the hours of 2000-0600.
- There were 6754 property crime offences between the hours of 2000-0600.
- The London Ambulance Service attended 1417 incidents in Islington between Dec 2011 and Nov 2012 where alcohol was recorded as a feature.
- Islington has a known cohort of street drinkers. These individuals often congregate in favoured places such as particular parks or areas of street pavement. Between Jan 2012-Dec 2012, outreach teams recorded a total of 212 contacts with street drinkers across the borough.



North Central London

Licensing Act 2003

**Representation from NHS North Central London (Islington Public Health) on behalf of health bodies providing services in Islington
Moonlight Supermarket, 131-133 Holloway Road, London, N7 8LX.**

I am submitting a representation against the application to vary the premises license to permit the sale of alcohol 24 hours a day from the above premises. This representation is on behalf of NHS North Central London's Islington Public Health Department, which as a health body is a responsible authority.

The impact of alcohol is particularly great in Islington with some of the greatest levels of alcohol-related problems in London, including:

- The highest rate of alcohol-specific deaths in men in London
- One of the highest rates of alcohol-related hospital admissions in London
- Significantly higher levels of alcohol-related violent crime and claimants of incapacity benefit where main medical reason for being a claimant is alcoholism

St Mary's ward, in which Moonlight Supermarket is located, seems to particularly feel the affects of alcohol related harm and has higher rates of alcohol-related ambulance callouts compared with Islington as a whole.

The grounds for the representation are:

- Public safety
- Crime and disorder

The relevant policies in Islington's Licensing Policy

- Policy 2: Cumulative impact and saturation
- Policy 4: Shops selling alcohol
- Policy 7: Licensing hours

The area in which Moonlight Supermarket is located already has relatively high density of premises. Currently within St Mary's ward there are:

- 174 premises licensed to sell alcohol, equivalent to one premises for every 54 residents aged 18 and over. This is higher than the Islington average of one licenced premises per 128 residents.
- 30 premises are licensed for off-sales of alcohol only (i.e. excluding on-licences that also sell alcohol for consumption off the premises), one for every 312 residents aged 18 and over in the ward, and 4th highest rate in Islington (the Islington average is one per 374 residents aged 18 and over).
- There are four 24-hour off-licences within 300m walk of the premises, nine within 1km of the premises, and 16 within 1 mile (1.6km) of the premises.

The premises is located within the Holloway Road and Finsbury Park cumulative impact area defined in Islington's Licensing Policy 2013-2017.

I am concerned that if this application is granted it will increase the availability of alcohol for consumption off premises. This could lead to an increase in public nuisance and crime and disorder, and impact adversely on health of both those buying and consuming the alcohol and also the health of others who come in contact with them.

The area already has sufficient premises to meet demand of local residents and additional outlets supplying alcohol will be detrimental to the local residents in terms of noise and disturbance in the early hours of the morning.

Alcohol and health

Alcohol misuse imposes a major preventable burden to health and the effect of this in Islington is felt across all health services. Recent analysis has estimated that in Islington the cost of hospital admissions where alcohol was an attributable factor was £7429.9k (£39.4 per Islington resident during the financial year 2008/09¹).

There is a growing body of evidence that an increased number of alcohol outlets results in significant increases in both alcohol consumption and alcohol-related harm, including injury, violence and medical harm. Evidence from a number of countries indicates reducing alcohol outlet density can have an impact on reducing violence and problem drinking. There is also strong and reasonably consistent evidence that changes in hours or days

of trading can have a significant impact on volume of alcohol consumed and rates of alcohol related problems^{2,3,4,5,6} North Central London

Impact of alcohol on health in Islington

The impact of alcohol on health in Islington is particularly severe. Alcohol-specific hospital admissions are those which are wholly related to alcohol (e.g. alcoholic liver disease or alcohol overdose). Islington has the second highest rate in London for hospital admissions where alcohol is the specific cause of admission. For men the rate is also significantly worse than England, with Islington having the 24th highest rate out of 326 boroughs nationally.

Currently Islington has one of the highest rates of alcohol-related hospital admissions (all hospital admissions in which alcohol is likely to have played a part, for example injuries/falls or high blood pressure) in London. The rate for both men and women is significantly worse than the England average. Increases in alcohol related admissions have been much higher in Islington than in England as a whole. For instance, in Islington, the increase in alcohol-related admissions in men was 39% and 44% for women between 2003/04 and 2009/10, compared to increases of 25% for both men and women in England.

St Mary's Ward

Ambulance callouts

The data on alcohol-related ambulance callouts reflects where the ambulance attended, not where the individual lives, and therefore includes people who live outside the borough but who come into Islington to work, socialise, etc. In 2011/12, there were 193 alcohol-related ambulance callouts in St Mary's ward (8.3% of all alcohol-related callouts in Islington), compared to an average of 146 per ward. Local analysis indicates that there is a general trend of ambulance callouts increasing as the number of licensed premises increases. At the smaller geographical Lower Super Output Area (equal to an area of around 1,500 residents), there were 60 alcohol-related ambulance call-outs in the vicinity of the Moonlight Supermarket, compared to an average of 20 across all Islington LSOAs. Across Islington, 53% of alcohol-related callouts resulted in conveying a person to hospital, and 6% resulted in assistance being given at the scene or conveyed to an NHS walk-in centre – this results in a substantial use of health service resource. The pattern of alcohol-related ambulance callouts corresponds with the pattern of alcohol-related crime in Islington.

Hospital admissions

St Mary's ward had the lowest rate of alcohol-specific hospital admissions among Islington wards in 2011/12, with a rate of 384 per 100,000 people – equivalent to 39 residents admitted to hospital. The low rate of alcohol-specific hospital admissions but high rate of alcohol-related ambulance callouts reflects the status of St Mary's ward as an area attracting visitors from other parts of Islington and from outside of Islington.

Conclusion

Islington experiences some of the highest levels of alcohol-related harm in London and the cumulative availability of alcohol is one area that is likely to be impacting on this.

Rates of hospital admissions as a result of alcohol are lower in St Mary's ward than in the borough as a whole, whilst alcohol-related ambulance call-outs are higher. This suggests that the immediate impact of alcohol misuse may be experienced by visitors to the area, which is likely to correspond with the impact of alcohol misuse on crime and anti-social behaviour in the area.

There is already good availability of alcohol in St Mary's, with a higher than average density as measured by the number residents aged 18 and over per off licence.

There is evidence that increased availability of alcohol, both in terms of the time period in which alcohol is available (hours of sale) and number of premises from which alcohol is available results in an increase in alcohol related harm. The effect of this is increased pressure and costs to the NHS. The impacts are also felt across a range of groups including the council, policing and the community as a whole.

Recommendation

NHS North Central London's Islington Public Health Department recommends that:

1. The application for a licence to supply alcohol is refused.

References

- 1 Baker, A., Lodge, H., Jacobson, B., Hamm, J. and Murage, P. (2012) Closing Time: Counting the cost of alcohol-attributable hospital admissions in London. London: London Health Observatory
- 2 Popova, S., Giesbrecht, N., Bekmuradov, D. And Patra, J. Hours and days of sale and density of alcohol outlets: impact on alcohol consumption and damage: a systematic review. Alcohol and alcoholism 2009;44(5): 500-516

attendances: a cohort study. Emergency Medicine Journal 2007;24:532-534

4 Highes K, Jones L, Bellis M. Reducing harm in drinking environments factsheet. European Union 2009.

5 Livingstone M. et al. Changing the density of alcohol outlets to reduce alcohol related harm. Drug and Alcohol Review 2007; 26: 557-566

6 Bryden A et al. A systematic review of the influence on alcohol use of community level availability and marketing of alcohol. Health and Place 2012; 18(2):349-357

Appendix 1: 24-hour off-licences within 1.6km (1 mile) of Moonlight supermarket

Licence number	Address			Postcode	Distance
LN/000004665	Good Value	126 Holloway Road	Islington	N7 8JE	0.1km
LN/000003363	Kool Food And Wine	138 Holloway Road	Islington	N7 8DD	0.2km
LN/000008697	Costcutter	146-152 Holloway Road	Islington	N7 8DD	0.2km
LN/000002969	Your Local	261 Holloway Road	Islington	N7 8HG	0.3km
LN/000008615	ST Food & Wine	308 St Paul's Road	Islington	N1 2LF	0.6km
LN/000003312	Zaco Mini Market	175 Upper Street	Islington	N1 1RG	0.7km
LN/000010592	Holloway Express	Flat B At 304	302-304 Holloway Road	N7 6NJ	0.7km
LN/000006639	Foodlink	Piccadilly Court	457-463 Caledonian Road	N7 9BJ	0.8km
LN/000007466	Londis	Unit A	453 Caledonian Road	N7 9BA	0.8km
LN/000009176	Nisa Local	476A Caledonian Road	Islington	N7 8TB	1.0km
LN/000005797	Sunset Off-Licence & Supermarket	349 Holloway Road	Islington	N7 0RN	1.2km
LN/000002537	Holloway Food Centre	Ground Floor	59 Seven Sisters Road	N7 6BH	1.4km
LN/000008979	EDA Food Centre	116-120 Seven Sisters Road	Islington	N7 6AE	1.4km
LN/000010502	Holloway Supermarket	554 Holloway Road	Islington	N7 6JU	1.4km
LN/000011205	Deniz 1 Supermarket	520 Holloway Road	Islington	N7 6JD	1.4km
LN/000004497	Gizem Supermarket	156 Seven Sisters Road	Islington	N7 7PL	1.6km

Distances calculated using www.walkit.com/london

**Licensing Act 2003- Representation from the Licensing Authority
Application: Moonlight 131-133 Holloway Road London N7**

I am submitting a representation on behalf of the Licensing Authority against the new application for a Premises Licence to permit the sale of alcohol 24 hours a day from the above premises.

The grounds for the representation are:

- Public nuisance
- Crime and disorder

The Licensing Authority is concerned that if this application is granted it will increase the availability of alcohol for consumption late at night which could lead to an increase in public nuisance and crime and disorder.

The premises is located in the Holloway and Finsbury Park Cumulative Impact area which means that the council has determined that the area is already saturated with licenced premises and any licence applications need to be carefully examined to ensure that the proposed activities, opening hours, style of operation and management arrangements contained in the operating schedule will not add to the cumulative impact to such an extent that the licensing objectives are undermined.

In assessing this application the Licensing Authority has considered the following evidence:

The Islington Alcohol Crime Profile Aug 2011 to July 2012

The profile shows that:

- The premises is located in an alcohol related violence and crime hotspot area
- Peak levels of alcohol related crime and violence is occurring between 8pm and 4am- this is particularly noticeable at weekends
- 30% calls to the police are classified as rowdy behaviour and these calls peak between 8pm and 4am, specially at weekends

Annual Public Health Report 2012

- The premises is located on the edge of a hotspot area for alcohol related ambulance callouts
- In Islington as the density of licenced premises increases the number of ambulance callouts and alcohol related crime increases

Licenced premises in St Marys Ward

The premise is located on the boundary of St Marys Ward with Highbury East and although it is located on a busy main road it is surrounded by residential premises with high density housing to the north.

There are 172 premises licensed to sell alcohol in St Marys ward and of these 80 premises are licensed for off sales of alcohol.

There are 48 premises licensed to sell alcohol in Highbury East ward and of these 16 premises are licensed for off sales of alcohol.

In the immediate area there are the following licenced premises

Holloway Road	Main Activity	Hours
113	nightclub	24 hour
119	takeaways	alcohol sales to 11pm M-Sat

		10.30 Sun
123A	restaurant	11pm M-Sat 10.30 Sun
127	off licence	11pm M-Sat 10.30 Sun
129	restaurant	midnight
135	supermarket	24 hour
149	restaurants	2am Sun to Thurs, 4am Fri & Sat
155	restaurant	midnight
159	supermarket	11pm M-Sat 10.30 Sun
163	late night refreshment only	1am
104-106	supermarket	24 hour
126	supermarket	24 hour
130	retail shop	9pm
134	restaurant	2am Mon to Thurs, 4am Fri and Sat
138	supermarket	24 hour
144	restaurant	midnight Sun to Thurs, 5am Fri and Sat
146	club/restaurant	midnight Sun to Wed, 2am Thurs, 4am Fri and Sat
150-152	supermarket	24 hour

The area already has sufficient licensed premises to cater for demands of local residents and any additional outlets supplying alcohol in the early hours of the morning will be detrimental to the local residents in terms of noise and disturbance and increase the potential for increasing alcohol related crime and disorder.

Whilst the section 10.13 of the Guidance issued under s82 Licensing Act 2003 encourages Local Authorities to grant premises licences for shops and supermarkets to permit alcohol sales whenever the outlet is open for shopping the Licensing Authority may restrict hours where there are good reasons, based up the licensing objectives. The Licensing Authority is of the opinion that the alcohol related crime hotspot data and ambulance callout for this area provides good reasons for departing from this guidance.

In determining this application the Licensing Committee should be mindful of:

Licensing Policy Considerations

Licensing Policy 2 – ‘... the type of premises and their cumulative impact upon the area

The Licensing Authority has adopted a special policy relating to cumulative impact in relation to Bunhill

This special policy creates a rebuttable presumption that applications for new premises licences, that are likely to add to the existing cumulative impact will normally be refused, unless the applicant can demonstrate why the operation of the premises involved will not add to the cumulative impact or otherwise impact adversely on the promotion of the licensing objectives.

Licensing Policy 4- shops selling alcohol

The Licensing Authority is concerned about the adverse impact on the licensing objectives arising from the increasing numbers of shops selling alcohol for consumption off the premises. The Licensing Authority will consider restricting the

number of premises and the licensing hours in locations where representations are received and that longer hours will undermine the licensing objectives.

Licensing Policy 7- Licensing Hours

The Licensing Authority supports the principle of flexibility in its approach to licensing hours and will consider the merits of each individual application however it is mindful that Islington has become saturated with late night premises selling alcohol and it is concerned about the cumulative impact that the proliferation of late night venues and retailers in the borough is having on the promotion of the licensing objectives.

Where representations are received from responsible authorities or other persons the Licensing Authority may seek to restrict hours of opening where it is appropriate to promote the licensing objectives.

Licensing policy 8- licensing hours

When dealing with new and variation applications the Licensing Authority will give more favourable consideration to applications with the following closing times:

Off Licences

11pm – Monday to Sundays

Summary and recommendations

The premise is located in a cumulative impact area and a 24 hour off licence selling alcohol will add to the cumulative impact. In making its recommendation the Licensing Authority has considered the style and hours of operation proposed by the applicant, the management arrangements described in the operating schedule, the special considerations described in paragraphs 5, 6 & 7 of the Licensing Policy.

It has also considered whether the imposition of conditions or restrictions would be an effective solution to promoting the licensing objectives.

The Licensing Authority recommends that the application for a 24 hour licence is refused.

If the applicant can demonstrate to the Licensing Committee that the premises will not add to the cumulative impact consideration could be given to granting a licence to permit off sales of alcohol until 8pm Monday to Sunday.

Janice Gibbons
Service Manager
Islington Council
Public Protection Division
222 Upper St
London N1 1XR

5 March 2013

Fitzsimons, Aiden

From: Davis, Rhiannon
Sent: 21 February 2013 17:02
To: Fitzsimons, Aiden
Subject: RE: Premises Licence Application: Moonlight Supermarket, 131-133 Holloway Road

Hi

I object to this as 24hrs 7days a week is excessive and is totally contrary to the aims of our new licensing policy. There are also already a number of off licenses in the nearby area and adding to this would be detrimental to local residents in terms of the likely increase in on street drinking and ASB.

Regards
Rhiannon

-----Original Message-----

From: Fitzsimons, Aiden
Sent: Tuesday, February 19, 2013 02:44 PM GMT Standard Time
To: Poole, Gary; Buchanan, Susan; Davis, Rhiannon
Cc: Whitton, Daniel
Subject: Premises Licence Application: Moonlight Supermarket, 131-133 Holloway Road

Dear Sir/Madam,

We have received the following attached application for a Premises Licence (New):

Proposed licence holder: Cihangir Eren, 8 Kariba Close, London, N9 0FR

Premises name: Moonlight Supermarket

Address: 131-133 Holloway Road, London, N7 8LX

Application received: 05 February 2013

Last date for representations: 05 March 2013

Licensable activities and timings applied for:

the sale of alcohol for consumption off the premises 24 hours a day, seven days a week.

You then have 28 days from the date of receipt of application to make any representations. Please confirm to us within this time if you do/don't wish to make representation.

Aiden Fitzsimons

Technical Support Officer
Licensing Team
Public Protection Division
Environment & Regeneration
Islington Council

3rd Floor, 222 Upper Street, London, N1 1XR
Tel: 020 7527 3031

Email: licensing@islington.gov.uk

Website: www.islington.gov.uk <file:///www.islington.gov.uk <file:///www.islington.gov.uk> >

The information contained in this E-Mail may be subject to public disclosure under the Freedom of Information Act 2000. Unless the information is legally exempt from disclosure, the confidentiality of this E-Mail and your reply cannot be guaranteed.

The information in this message is confidential and may be legally privileged. It is intended solely for the addressee. Access to this message by any other person is not permitted. If you are not the intended recipient, any disclosure, copying, distribution or any action taken or omitted to be taken in reliance on it, is prohibited and may be unlawful.

Please help save resources by not printing this e-mail if you can avoid it, and by using recycled paper.

Suggested conditions of approval consistent with the operating schedule

1. A digital CCTV system shall be installed, operated and maintained inside and outside the premises (subject to planning permission) in agreement with the Police. The system will enable a frontal head and shoulders image of every person entering the premises. The system shall record in real time and operate whilst the premises are open for licensable activities. The recordings shall be kept available for a minimum of 31 days. A working copy shall be supplied free of charge to a Police Officer within 24 hours of any request to assist in the investigation of a crime or apprehending or prosecuting an offender. It is the responsibility of the premises to download any recording requests.
2. An Incident Book is to be maintained. This must be checked and signed weekly by the Designated Premises Supervisor.
3. Appropriate fire safety procedures shall be in place including fire extinguishers (Foam, H₂O and CO₂), fire blanket, internally illuminated exit signs, numerous smoke detectors and emergency lighting. All alliances are to be inspected annually.
4. All emergency exits shall be kept free from obstruction at all times.
5. All customers will be asked to leave quietly.
6. Clear and legible notices will be prominently displayed to remind customers to leave quietly and have regard for the neighbours.

Suggested conditions of approval agreed with the Council's Trading Standards team

7. No alcoholic goods will ever be purchased or taken from persons calling to the shop.
8. No spirits shall be purchased in a resealed box.
9. The licensee will immediately report to Trading Standards any instance of a caller to the shop attempting to sell alcohol.
10. Invoices (or copies) for all alcoholic goods on the premises will be kept at the shop and made available to officers from the council, police or HMRC upon request.
11. A stock control system will be introduced, so that the licensee can quickly identify where and when alcoholic goods have been purchased.
12. An ultra-violet light will be available at the premises for the purpose of checking the UK Duty Stamp on spirits as soon as practical after they have been purchased.
13. If any spirits bought by the business have UK Duty Stamps that do not fluoresce under ultra-violet light, or are otherwise suspicious, the licensee shall identify the supplier to Islington Trading Standards and HMRC as soon as possible.
14. The licensee shall adopt 'Challenge 25', the Retail of Alcohol Standards Group's advice for off-licences, and promote it through the display of posters.
15. The licensee shall ensure that staff are trained about age restricted products and ensure that they sign to confirm that they have understood the training. The training shall include the assessment of age; making a challenge; acceptable proof of age; and recording refusals. The licensee shall keep records of training and instruction given to staff, detailing the areas covered, and make them available for inspection upon request by the licensing team, police or trading standards.
16. The licensee shall put arrangements in place to ensure that before serving alcohol to persons they believe to be less than 25, staff ask to see accredited proof of age: that is, proof of age cards carrying the 'PASS' logo (and no others), a Passport, or UK Driving Licence bearing the photograph and date of birth of the bearer.
17. The licensee shall require staff to note any refusals to sell to young people in a refusals log. The refusals log shall be checked and signed monthly by the designated premises supervisor. The refusals log shall be made available for inspection upon request by the licensing team, police or trading standards.

