



Report of: **Service Director, Public Protection**

Meeting of	Date	Agenda Item	Ward(s)
Licensing Sub-Committee	22 June 2016		Bunhill

Delete as appropriate		Non-exempt
-----------------------	--	------------

**Subject: PREMISES LICENCE NEW APPLICATION
72 ST JOHN STREET, LONDON EC1M 4DT**

1.

Synopsis

- 1.1 This is an application for a new premise licence under the Licensing Act 2003.
- 1.2 The new application is to:
 - I. Supply alcohol for consumption on the premises from 12:00 until 22:30 Monday to Saturday;
 - II. Opening hours of the premises from 12:00 until 23:00 Monday to Saturday.

2.

Relevant Representations

Licensing Authority	No
Metropolitan Police	No
Noise	No
Health and Safety	No
Trading Standards	No
Public Health	No

Safeguarding Children	No
London Fire Brigade	No
Local residents	Yes – 4 Local Resident
Other bodies	Yes – 1 Management Agent

3. Background

3.1 Papers are attached as follows:-

Appendix 1: application form;

Appendix 2: representations;

Appendix 3: suggested conditions and map of premises location.

3.2 The application originally had a terminal hour of 23:00 for the sale of alcohol. This was reduced by the applicant to 22:30 following consultation with the Pollutions Team.

3.3 The premises is currently unlicensed.

4. Planning Implications

4.1 No adverse observations have been received from Planning regarding this new application.

5 Recommendations

5.1 To determine the application for a new premises licence under Section 17 of the Licensing Act 2003.

5.2 To consider that this address is in the Bunhill Saturation or “Cumulative Impact Policy” of Islington. This special policy creates a rebuttable presumption that applications for new premises licences, club premises certificates, or variation applications that are likely to add to the existing cumulative impact will normally be refused, unless the applicant can demonstrate why the operation of the premises involved will not add to the cumulative impact or otherwise impact adversely on the promotion of the licensing objectives.

5.3 If the Committee grants the application it should be subject to:

i. conditions prepared by the Licensing Officer which are consistent with the Operating Schedule (see appendix 4)

ii. any conditions deemed appropriate by the Committee to promote the four licensing objectives.(see appendix 4)

6 Conclusion and reasons for recommendations

6.1 The Council is required to consider this application in the light of all relevant information, and if approval is given, it may attach such conditions as appropriate to promote the licensing objectives.

Background papers:

The Council's Statement of Licensing Policy

Licensing Act 2003

Secretary of States Guidance

Final Report Clearance

Signed by

Service Director – Public Protection

Date 8 June 2016

Received by

Head of Scrutiny and Democratic Services

Date

Report author: Licensing Service

Tel: 020 75027 3031

E-mail: licensing@islington.gov.uk

WK/160012009.



ISLINGTON

OK
Lant 22 April 16
KT
OK.?

22/4/16

Application for a premises licence to be granted under the Licensing Act 2003

PLEASE READ THE FOLLOWING INSTRUCTIONS FIRST

Before completing this form please read the guidance notes at the end of the form. If you are completing this form by hand please write legibly in block capitals. In all cases ensure that your answers are inside the boxes and written in black ink. Use additional sheets if necessary.

You may wish to keep a copy of the completed form for your records.

I/We Roccamora UK Limited

(Insert name(s) of applicant)

apply for a premises licence under section 17 of the Licensing Act 2003 for the premises described in Part 1 below (the premises) and I/we are making this application to you as the relevant licensing authority in accordance with section 12 of the Licensing Act 2003

Part 1 – Premises Details

Postal address of premises or, if none, ordnance survey map reference or description			
72 St John Street Clerkenwell			
Post town	LONDON	Postcode	EC1M 4DT

Telephone number at premises (if any)	
Non-domestic rateable value of premises	£24,250.00

Part 2 - Applicant Details

Please state whether you are applying for a premises licence as

Please tick as appropriate

- a) an individual or individuals * please complete section (A)
- b) a person other than an individual *
 - i. as a limited company please complete section (B)
 - ii. as a partnership please complete section (B)
 - iii. as an unincorporated association or please complete section (B)
 - iv. other (for example a statutory corporation) please complete section (B)
- c) a recognised club please complete section (B)
- d) a charity please complete section (B)

RECEIPT IP2/735818.
£190 22/4/16.

- e) the proprietor of an educational establishment please complete section (B)
- f) a health service body please complete section (B)
- g) a person who is registered under Part 2 of the Care Standards Act 2000 (c14) in respect of an independent hospital in Wales please complete section (B)
- ga) a person who is registered under Chapter 2 of Part 1 of the Health and Social Care Act 2008 (within the meaning of that Part) in an independent hospital in England please complete section (B)
- h) the chief officer of police of a police force in England and Wales please complete section (B)

* If you are applying as a person described in (a) or (b) please confirm:

Please tick yes

- I am carrying on or proposing to carry on a business which involves the use of the premises for licensable activities; or
- I am making the application pursuant to a
 - statutory function or
 - a function discharged by virtue of Her Majesty's prerogative

(A) INDIVIDUAL APPLICANTS (fill in as applicable)

Mr <input type="checkbox"/>	Mrs <input type="checkbox"/>	Miss <input type="checkbox"/>	Ms <input type="checkbox"/>	Other Title (for example, Rev)	
Surname			First names		
I am 18 years old or over				<input type="checkbox"/> Please tick yes	
Current postal address if different from premises address					
Post town				Postcode	
Daytime contact telephone number					
E-mail address (optional)					

SECOND INDIVIDUAL APPLICANT (if applicable)

Mr <input type="checkbox"/>	Mrs <input type="checkbox"/>	Miss <input type="checkbox"/>	Ms <input type="checkbox"/>	Other Title (for example, Rev)	
Surname			First names		
I am 18 years old or over				<input type="checkbox"/>	Please tick yes
Current postal address if different from premises address					
Post town		Postcode			
Daytime contact telephone number					
E-mail address (optional)					

(B) OTHER APPLICANTS

Please provide name and registered address of applicant in full. Where appropriate please give any registered number. In the case of a partnership or other joint venture (other than a body corporate), please give the name and address of each party concerned.

✓ Name	Roccamora UK Limited
✓ Address	C/o Unit 1, Trade City 13 Crown Road Enfield EN1 1TH WELLINGTON HOUSE 273 - 275 HIGH ST LONDON COLNEY ST ALBANS HERTS. AL2 1HA .
✓ Registered number (where applicable)	07097732
Description of applicant (for example, partnership, company, unincorporated association etc.)	Company
Telephone number (if any)	
E-mail address (optional)	

Part 3 Operating Schedule

When do you want the premises licence to start?

DD	MM	YYYY
2	1	05 2016

If you wish the licence to be valid only for a limited period, when do you want it to end?

DD	MM	YYYY

Please give a general description of the premises (please read guidance note 1)

GROUND FLOOR & BASEMENT FULLY SEATED RESTAURANT.

If 5,000 or more people are expected to attend the premises at any one time, please state the number expected to attend.

N/A

What licensable activities do you intend to carry on from the premises?

(Please see sections 1 and 14 of the Licensing Act 2003 and Schedules 1 and 2 to the Licensing Act 2003)

Provision of regulated entertainment

Please tick any that apply

- a) plays (if ticking yes, fill in box A)
- b) films (if ticking yes, fill in box B)
- c) indoor sporting events (if ticking yes, fill in box C)
- d) boxing or wrestling entertainment (if ticking yes, fill in box D)
- e) live music (if ticking yes, fill in box E)
- f) recorded music (if ticking yes, fill in box F)
- g) performances of dance (if ticking yes, fill in box G)
- h) anything of a similar description to that falling within (e), (f) or (g) (if ticking yes, fill in box H)

Provision of late night refreshment (if ticking yes, fill in box I)

Supply of alcohol (if ticking yes, fill in box J)

In all cases complete boxes K, L and M

A

Plays Standard days and timings (please read guidance note 6)			Will the performance of a play take place indoors or outdoors or both – please tick (please read guidance note 2)	Indoors	<input type="checkbox"/>
				Outdoors	<input type="checkbox"/>
				Both	<input type="checkbox"/>
Day	Start	Finish			
Mon			Please give further details here (please read guidance note 3) Not applicable		
Tue			State any seasonal variations for performing plays (please read guidance note 4)		
Wed			Non standard timings. Where you intend to use the premises for the performance of plays at different times to those listed in the column on the left, please list (please read guidance note 5)		
Thur					
Fri					
Sat					
Sun					

B

Films Standard days and timings (please read guidance note 6)			Will the exhibition of films take place indoors or outdoors or both – please tick (please read guidance note 2)	Indoors	<input type="checkbox"/>
				Outdoors	<input type="checkbox"/>
				Both	<input type="checkbox"/>
Day	Start	Finish	Please give further details here (please read guidance note 3) Not applicable		
Mon					
Tue			State any seasonal variations for the exhibition of films (please read guidance note 4)		
Wed					
Thur			Non standard timings. Where you intend to use the premises for the exhibition of films at different times to those listed in the column on the left, please list (please read guidance note 5)		
Fri					
Sat					
Sun					

C

Indoor sporting events Standard days and timings (please read guidance note 6)			Please give further details (please read guidance note 3) Not applicable
Day	Start	Finish	
Mon			
Tue			State any seasonal variations for indoor sporting events (please read guidance note 4)
Wed			
Thur			Non standard timings. Where you intend to use the premises for indoor sporting events at different times to those listed in the column on the left, please list (please read guidance note 5)
Fri			
Sat			
Sun			

D

Boxing or wrestling entertainments Standard days and timings (please read guidance note 6)			Will the boxing or wrestling entertainment take place indoors or outdoors or both – please tick (please read guidance note 2)	Indoors	<input type="checkbox"/>
Day	Start	Finish		Outdoors	<input type="checkbox"/>
				Both	<input type="checkbox"/>
Mon				Please give further details here (please read guidance note 3) Not applicable	
Tue					
Wed			State any seasonal variations for boxing or wrestling entertainment (please read guidance note 4)		
Thur					
Fri			Non standard timings. Where you intend to use the premises for boxing or wrestling entertainment at different times to those listed in the column on the left, please list (please read guidance note 5)		
Sat					
Sun					

E

Live music Standard days and timings (please read guidance note 6)			Will the performance of live music take place indoors or outdoors or both – please tick (please read guidance note 2)	Indoors	<input type="checkbox"/>
				Outdoors	<input type="checkbox"/>
				Both	<input type="checkbox"/>
Day	Start	Finish	Please give further details here (please read guidance note 3) Not applicable		
Mon					
Tue			State any seasonal variations for the performance of live music (please read guidance note 4)		
Wed					
Thur			Non standard timings. Where you intend to use the premises for the performance of live music at different times to those listed in the column on the left, please list (please read guidance note 5)		
Fri					
Sat					
Sun					

F

Recorded music Standard days and timings (please read guidance note 6)			Will the playing of recorded music take place indoors or outdoors or both – please tick (please read guidance note 2)	Indoors	<input type="checkbox"/>
				Outdoors	<input type="checkbox"/>
				Both	<input type="checkbox"/>
Day	Start	Finish	Please give further details here (please read guidance note 3) Not applicable		
Mon					
Tue			State any seasonal variations for the playing of recorded music (please read guidance note 4)		
Wed					
Thur					
Fri			Non standard timings. Where you intend to use the premises for the playing of recorded music at different times to those listed in the column on the left, please list (please read guidance note 5)		
Sat					
Sun					

G

Performances of dance Standard days and timings (please read guidance note 6)			<u>Will the performance of dance take place indoors or outdoors or both – please tick</u> (please read guidance note 2)	Indoors	<input type="checkbox"/>
				Outdoors	<input type="checkbox"/>
				Both	<input type="checkbox"/>
Day	Start	Finish	<u>Please give further details here</u> (please read guidance note 3) Not applicable		
Mon					
Tue			<u>State any seasonal variations for the performance of dance</u> (please read guidance note 4)		
Wed					
Thur			<u>Non standard timings. Where you intend to use the premises for the performance of dance at different times to those listed in the column on the left, please list</u> (please read guidance note 5)		
Fri					
Sat					
Sun					

H

Anything of a similar description to that falling within (e), (f) or (g) Standard days and timings (please read guidance note 6)			Please give a description of the type of entertainment you will be providing		
Day	Start	Finish	Will this entertainment take place indoors or outdoors or both – please tick (please read guidance note 2)	Indoors	<input type="checkbox"/>
Mon				Outdoors	<input type="checkbox"/>
				Both	<input type="checkbox"/>
Tue			Please give further details here (please read guidance note 3) Not applicable		
Wed					
Thur			State any seasonal variations for entertainment of a similar description to that falling within (e), (f) or (g) (please read guidance note 4)		
Fri					
Sat			Non standard timings. Where you intend to use the premises for the entertainment of a similar description to that falling within (e), (f) or (g) at different times to those listed in the column on the left, please list (please read guidance note 5)		
Sun					

I

Late night refreshment Standard days and timings (please read guidance note 6)			Will the provision of late night refreshment take place indoors or outdoors or both – please tick (please read guidance note 2)	Indoors	<input type="checkbox"/>
				Outdoors	<input type="checkbox"/>
				Both	<input type="checkbox"/>
Day	Start	Finish	Please give further details here (please read guidance note 3) Not applicable		
Mon					
Tue					
Wed			State any seasonal variations for the provision of late night refreshment (please read guidance note 4)		
Thur					
Fri			Non standard timings. Where you intend to use the premises for the provision of late night refreshment at different times, to those listed in the column on the left, please list (please read guidance note 5)		
Sat					
Sun					

J

Supply of alcohol Standard days and timings (please read guidance note 6)			Will the supply of alcohol be for consumption – please tick (please read guidance note 7)	On the premises	<input checked="" type="checkbox"/>			
				Off the premises	<input type="checkbox"/>			
				Both	<input type="checkbox"/>			
Day	Start	Finish	State any seasonal variations for the supply of alcohol (please read guidance note 4)					
Mon	12:00	23:00						
Tue	12:00	23:00						
Wed	12:00	23:00						
Thur	12:00	23:00						
Fri	12:00	23:00						
Sat	12:00	23:00						
Sun								
						Non standard timings. Where you intend to use the premises for the supply of alcohol at different times to those listed in the column on the left, please list (please read guidance note 5)		
						The premises may remain open for the sale of alcohol from the terminal hour for those activities on New Year's Eve through to the commencement time for those activities on New Year's Day.		

State the name and details of the individual whom you wish to specify on the licence as designated premises supervisor:

Name MR GAETANO ALFANO	
Address	
Postcode	
Personal licence number (if known)	
Issuing licensing authority (if known) BROXBORNE BOROUGH COUNCIL	

K

Please highlight any adult entertainment or services, activities, other entertainment or matters ancillary to the use of the premises that may give rise to concern in respect of children (please read guidance note 8).

NONE

L

Hours premises are open to the public Standard days and timings (please read guidance note 6)			<u>State any seasonal variations</u> (please read guidance note 4)
Day	Start	Finish	
Mon	12:00		<p><u>Non standard timings. Where you intend the premises to be open to the public at different times from those listed in the column on the left, please list</u> (please read guidance note 5)</p> <p>The premises may remain open for the sale of alcohol from the terminal hour for those activities on New Year's Eve through to the commencement time for those activities on New Year's Day.</p>
		23:00	
Tue	12:00		
		23:00	
Wed	12:00		
		23:00	
Thur	12:00		
		23:00	
Fri	12:00		
		23:00	
Sat	12:00		
		23:00	
Sun			

M Describe the steps you intend to take to promote the four licensing objectives:

a) General – all four licensing objectives (b, c, d and e) (please read guidance note 9)

- The supply of alcohol shall be by waiter or waitress service only.
- Notwithstanding the condition above (waiter/waitress service only), alcohol may be supplied and consumed prior to their meal in the bar area (*designated on the plan*), by up to a maximum at any one time, of 12 (Twelve) persons dining at the premises.

Please see below.

b) The prevention of crime and disorder

- The holder of the premises licence shall subscribe to and participate fully in the local pub/club/shop watch scheme.
- Alcoholic drinks may only be consumed within the premises. The premises licence holder must ensure that no alcohol is consumed outside the premises at any time.

c) Public safety

- Compliance with existing Health and Safety/Fire Safety requirements.

d) The prevention of public nuisance

- Noise or vibration must not emanate from the premises so as to cause a nuisance to nearby properties.
- Prominent, clear and legible notices must be displayed at all exits requesting the public to respect the needs of local residents and to leave the premises and the area quietly.
- Bottling out from the premises is prohibited between 22:00 hours and 10:00 hours.
- Patrons permitted to temporarily leave and then re-enter the premises, e.g. to smoke, shall be limited to 10(Ten) persons at any one time.

e) The protection of children from harm

- The licensee shall adopt the Challenge 25 and the BII National Standards Proof of Age Scheme.

Checklist:

Please tick to indicate agreement

- I have made or enclosed payment of the fee. ✓
- I have enclosed the plan of the premises. ✓
- I have sent copies of this application and the plan to responsible authorities and others where applicable. ✓
- I have enclosed the consent form completed by the individual I wish to be designated premises supervisor, if applicable. ✓
- I understand that I must now advertise my application. ✓
- I understand that if I do not comply with the above requirements my application will be rejected. ✓

IT IS AN OFFENCE, LIABLE ON SUMMARY CONVICTION TO A FINE NOT EXCEEDING LEVEL 5 ON THE STANDARD SCALE, UNDER SECTION 158 OF THE LICENSING ACT 2003, TO MAKE A FALSE STATEMENT IN OR IN CONNECTION WITH THIS APPLICATION.

Part 4 – Signatures (please read guidance note 10)

Signature of applicant or applicant’s solicitor or other duly authorised agent (see guidance note 11).
If signing on behalf of the applicant, please state in what capacity.

Signature	
Date	22/04/2016
Capacity	Licensing Agent

For joint applications, signature of 2nd applicant or 2nd applicant’s solicitor or other authorised agent (please read guidance note 12). **If signing on behalf of the applicant, please state in what capacity.**

Signature	
Date	
Capacity	

Contact name (where not previously given) and postal address for correspondence associated with this application (please read guidance note 13)

Matt Lauezzari
Sound Licensing Ltd
2 Limes Court
Limes Road

Post town **Cheshunt**

Postcode **EN8 8JE**

Telephone number (if any)

If you would prefer us to correspond with you by e-mail, your e-mail address (optional)

Notes for Guidance

1. Describe the premises, for example the type of premises, its general situation and layout and any other information which could be relevant to the licensing objectives. Where your application includes off-supplies of alcohol and you intend to provide a place for consumption of these off-supplies, you must include a description of where the place will be and its proximity to the premises.
2. Where taking place in a building or other structure please tick as appropriate (indoors may include a tent).
3. For example the type of activity to be authorised, if not already stated, and give relevant further details, for example (but not exclusively) whether or not music will be amplified or unamplified.
4. For example (but not exclusively), where the activity will occur on additional days during the summer months.
5. For example (but not exclusively), where you wish the activity to go on longer on a particular day e.g. Christmas Eve.
6. Please give timings in 24 hour clock (e.g. 16:00) and only give details for the days of the week when you intend the premises to be used for the activity.
7. If you wish people to be able to consume alcohol on the premises, please tick 'on the premises'. If you wish people to be able to purchase alcohol to consume away from the premises, please tick 'off the premises'. If you wish people to be able to do both, please tick 'both'.
8. Please give information about anything intended to occur at the premises or ancillary to the use of the premises which may give rise to concern in respect of children, regardless of whether you intend children to have access to the premises, for example (but not exclusively) nudity or semi-nudity, films for restricted age groups or the presence of gaming machines.
9. Please list here steps you will take to promote all four licensing objectives together.
10. The application form must be signed.
11. An applicant's agent (for example solicitor) may sign the form on their behalf provided that they have actual authority to do so.
12. Where there is more than one applicant, each of the applicant or their respective agent must sign the application form.
13. This is the address which we shall use to correspond with you about this application.



KEY

- LICENSED AREA
 - [FE] FIRE EXTINGUISHER
 - [FB] FIRE BLANKET
- *Final seating plan lbc

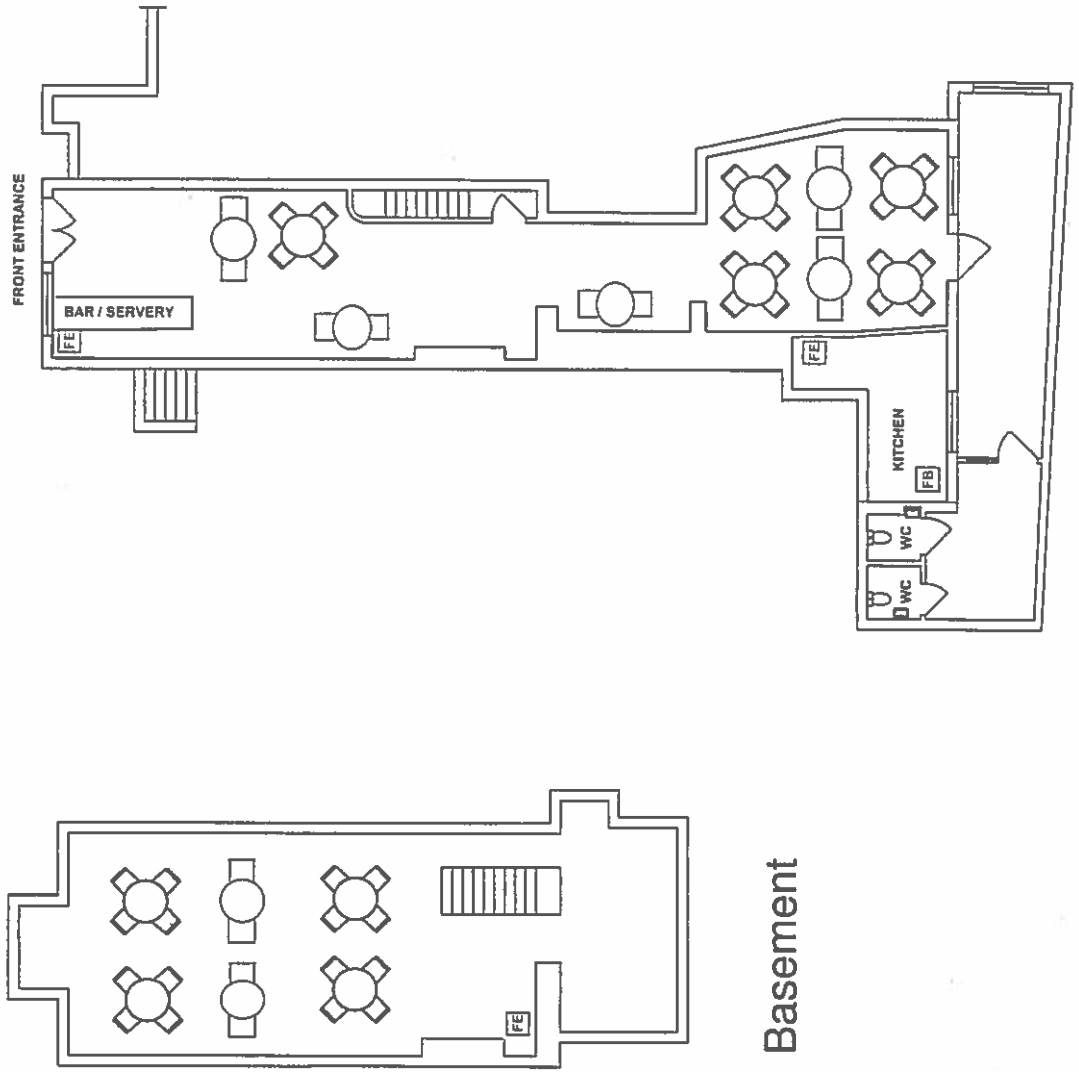

Basement

72 ST. JOHN STREET EC1M 4DT
1:100

REF: R001/01



REP 1.2.

Dear Licensing Support,

I would like to object to the application for an alcohol license on the ground floor of 72 Saint John St. EC1, on the grounds that as there are flats above the premises, after a hard day's work it would be preferable to let people enjoy the quiet of their homes.

This section of the Street does not need yet another late night drinking establishment

many thanks



Your contact with Islington Council

Your reference number: 1740611

Submitted data:

1. First name :
2. Last name :
3. First line of your address :
4. Your full postcode :
5. Your email address :
6. Phone number :
7. Which service do you want to tell us about (required) : Any other service
8. What do you want to tell us about? : I would like to object about a planning application for an alcohol license at 72 Saint John Street from 12.00 to 23.00 Mon to Sat. As there are three flats above the premises, it looks as though there is going to be more noise than usual on the ground floor late into the night. As there are several establishments in this part of Saint John Street that serve alcohol I feel that one more is unnecessary and superfluous. I'm sure my fellow flat dwellers would endorse this opinion and want to preserve the quiet of their flats during the evening
9. Have you already been in touch with someone about this? :

Res Rev 2

Montanez-Dodson, Monty

From:
Sent: 06 May 2016 12:14
To: Licensing
Cc:
Subject: New Premises Licence Application Restaurant - 72 St John Street

Follow Up Flag: Follow up
Flag Status: Flagged

Dear John,

Many thanks for your letter re New Premises Licence Application Restaurant - 72 St John Street.

We act as Managing Agents for the adjacent residential building.

We would like to object on the following grounds:

- Noise late at night adjacent to a residential block (66 St John Street)
- Hazardous littering from people throwing their glasses around the pavement, to the entrance of our building and throwing up.
- There are more than sufficient licensed premises in St John Street already.

There also needs to be a proper extract system for the restaurant as we have had problems in the past with smells at St John Street.

Please could you put me in touch with the person who deals with this.

I look forward to hearing from you that you have received our objections.

Kind regards,

Reception

This e-mail is a commercial and/or personal communication, not a financial communication. Neither this nor any other communication from Tamares Group is intended to be, or should be construed as, an invitation or inducement (direct or indirect) to any person to engage in any investment activity

This e-mail and any attached files are confidential and may be legally privileged. If you are not the addressee, any disclosure, reproduction, copying, distribution or other dissemination or use of this communication is strictly prohibited. If you have received this transmission in error please notify the sender immediately and then delete this e-mail. Opinions, advice or facts included in this message are given without any warranties or intention to enter into a contractual relationship with Tamares Group or associated companies unless specifically indicated otherwise by agreement, letter or facsimile signed by an authorised signatory of Tamares Group or associated companies. Any part of this e-mail which is purely personal in nature is not authorised by Tamares Group or its associated companies. All e-mail through the gateway of Tamares Group and associated companies is potentially the subject of monitoring. Internet communications are not secure. You should not assume that the contents originated from Tamares Group or any associated companies. All liability for errors and viruses is excluded.

Tomashevski, Katie

From:
Sent: 25 May 2016 13:38
To: Tomashevski, Katie
Cc:
Subject: RE: Licensing Service - 72 St John Street EC1M 4DT

Hi Katie,

Thanks for your kind email

My residential address is

Kind regards,

From: Tomashevski, Katie [<mailto:Katie.Tomashevski@islington.gov.uk>]
Sent: 24 May 2016 09:56
To:
Subject: RE: Licensing Service - 72 St John Street EC1M 4DT

Dear

I am the licensing officer dealing with this application. We are in receipt of your email which lacks your residential address. To validate your representation we require your full residential address. Could you please supply me with your address?

Kind regards,
Katie Tomashevski
Licensing Officer
222 Upper Street
London N1 1XR
Tel: 020-7527-3882

From:
Sent: 16 May 2016 15:05
To: Licensing
Cc:
Subject: Licensing Service - 72 St John Street EC1M 4DT

Dear John Williams,

I strongly oppose against the license application regarding 72 St John Street, EC1M 4DT and refer to the three following licensing objectives. Many thanks in advance for your help – I have added my details at the end of this email.

Kind regards,

Public nuisance

The sale of alcohol from noon until 11pm Monday to Saturday would result in significant disorder in the street during opening and closing time, outside drinkers blocking the pavement and likely disturbing traffic, as well as the entrance to our residential building.

Also importantly, there would be elevated noise from intoxicated customers leaving or drinking in outside areas. 11pm at night is particularly late for a residential area and would interfere with the lives and comfort of the local community – for instance, some residents including myself go to bed at 10pm and wake up by 6am.

Crime and disorder

In addition to significant disorder in the street at night and closing time, the sale of alcohol would encourage anti-social behaviours from customers, which could lead to harassment or distress to local residents.

It is likely to be difficult to access our building with outside drinkers blocking the pavement and entrance. I would not feel safe going home having to pass by intoxicated customers either on the pavement or leaving the restaurant/bar premises.

Public safety

The sale of alcohol under the current application would heighten the risk to public safety. Alcohol supply needs to be controlled and licence numbers limited as alcohol is a key driver of criminality. Up to 80% of arrests can be alcohol related and this would add strain on local authorities funding related to public safety.

The local community and residents do not need another licensed premise given current supply on St John Street.

.....
Premises Name and address: RESTAURANT, 72 ST JOHN STREET, EC1M 4DT

My name:

Interest: Resident

Address:

Email:

Telephone:

Tomashevski, Katie

From:
Sent: 24 May 2016 13:54
To: Tomashevski, Katie
Subject: Re: Objection - 72 St John Street, EC1M 4DT

Dear Ms Tomashevski,

Thank you for your email. Our full address is:

Yours,

2016-05-24 9:57 GMT+01:00 Tomashevski, Katie <Katie.Tomashevski@islington.gov.uk>:

Dear

I am the licensing officer dealing with this application. We are in receipt of your email which lacks your residential address. To validate your representation we require your full residential address. Could you please supply me with your address?

Kind regards,

Katie Tomashevski

Licensing Officer

222 Upper Street

London N1 1XR

Tel: 020-7527-3882

From:
Sent: 16 May 2016 16:30

To: Licensing

Subject: Objection - 72 St John Street, EC1M 4DT

Dear Council,

Please register our objection to the application for licensed premises at 72 St John St, EC1M 4DT. This area does not need another place selling alcohol. We need another daytime cafe for taxi drivers and the people who work in this area. Importantly this building is a residential building and always has been. Our family has been living here since 1983.

I trust that you will not award this licence,

Yours,

This e-mail is intended for the addressee only. If you have received it in error, please contact the sender and delete the material from your computer. Please be aware that information in this email may be confidential, legally privileged and/or copyright protected.

Kes Kes 6.

Montanez-Dodson, Monty

From:
Sent: 18 May 2016 09:11
To: Licensing
Subject: Re: Licensing Service - 72 St John Street EC1M 4DT

Follow Up Flag: Follow up
Flag Status: Flagged

Dear John Williams

I have been notified by my tenant about the planning application for 72 St John Street. As the owner of the top flat, I totally object to this being granted on the same grounds as Navann below. There are enough licensed premises on what is an already very noisy street and it would significantly affect the peaceful enjoyment of the flat and its value.

My details are:

Thank you.

Sent from my iPhone

Begin forwarded message:

From:
Date: 16 May 2016 15:05:08 BST
To: "licensing@islington.gov.uk" <licensing@islington.gov.uk>
Cc:
Subject: Licensing Service - 72 St John Street EC1M 4DT

Dear John Williams,

I strongly oppose against the license application regarding 72 St John Street, EC1M 4DT and refer to the three following licensing objectives. Many thanks in advance for your help – I have added my details at the end of this email.

Kind regards,

Public nuisance

The sale of alcohol from noon until 11pm Monday to Saturday would result in significant disorder in the street during opening and closing time, outside drinkers blocking the pavement and likely disturbing traffic, as well as the entrance to our residential building.

Also importantly, there would be elevated noise from intoxicated customers leaving or drinking in outside areas. 11pm at night is particularly late for a residential area and would interfere with the lives and comfort of the local community – for instance, some residents including myself go to bed at 10pm and wake up by 6am.

Crime and disorder

In addition to significant disorder in the street at night and closing time, the sale of alcohol would encourage anti-social behaviours from customers, which could lead to harassment or distress to local residents.

It is likely to be difficult to access our building with outside drinkers blocking the pavement and entrance. I would not feel safe going home having to pass by intoxicated customers either on the pavement or leaving the restaurant/bar premises.

Public safety

The sale of alcohol under the current application would heighten the risk to public safety. Alcohol supply needs to be controlled and licence numbers limited as alcohol is a key driver of criminality. Up to 80% of arrests can be alcohol related and this would add strain on local authorities funding related to public safety.

The local community and residents do not need another licensed premise given current supply on St John Street.

.....
Premises Name and address: RESTAURANT, 72 ST JOHN STREET, EC1M 4DT

My name:

Interest: Resident

Address:

Email:

Telephone:

This message, and any attachments, is for the intended recipient(s) only, may contain information that is privileged, confidential and/or proprietary and subject to important terms and conditions available at

If you are not the intended recipient, please delete this message.

Suggested conditions of approval consistent with the operating schedule

1. The supply of alcohol shall be by waiter or waitress service only, except in the designated area on the plan prior to a meal and the number of customers having a drink before their meal shall be limited to 12 persons.
2. The licensee shall subscribe to and fully participate in the local pubwatch.
3. Alcoholic drinks shall only be consumed within the premises.
4. The licensee shall ensure that no alcohol is consumed outside the premise at any time.
5. Noise or vibration shall not emanate from the premises so as to cause a nuisance to nearby properties.
6. Prominent, clear and legible notices must be displayed at all exits requesting the customers to respect the needs of local residents and to leave the premises and the area quietly.
7. Customers permitted to temporarily leave and then re-enter the premises (e.g. to smoke) shall be limited to 10 persons at any one time.
8. There shall be no collections of refuse or deliveries between the hours of 22:00 to 08:00.

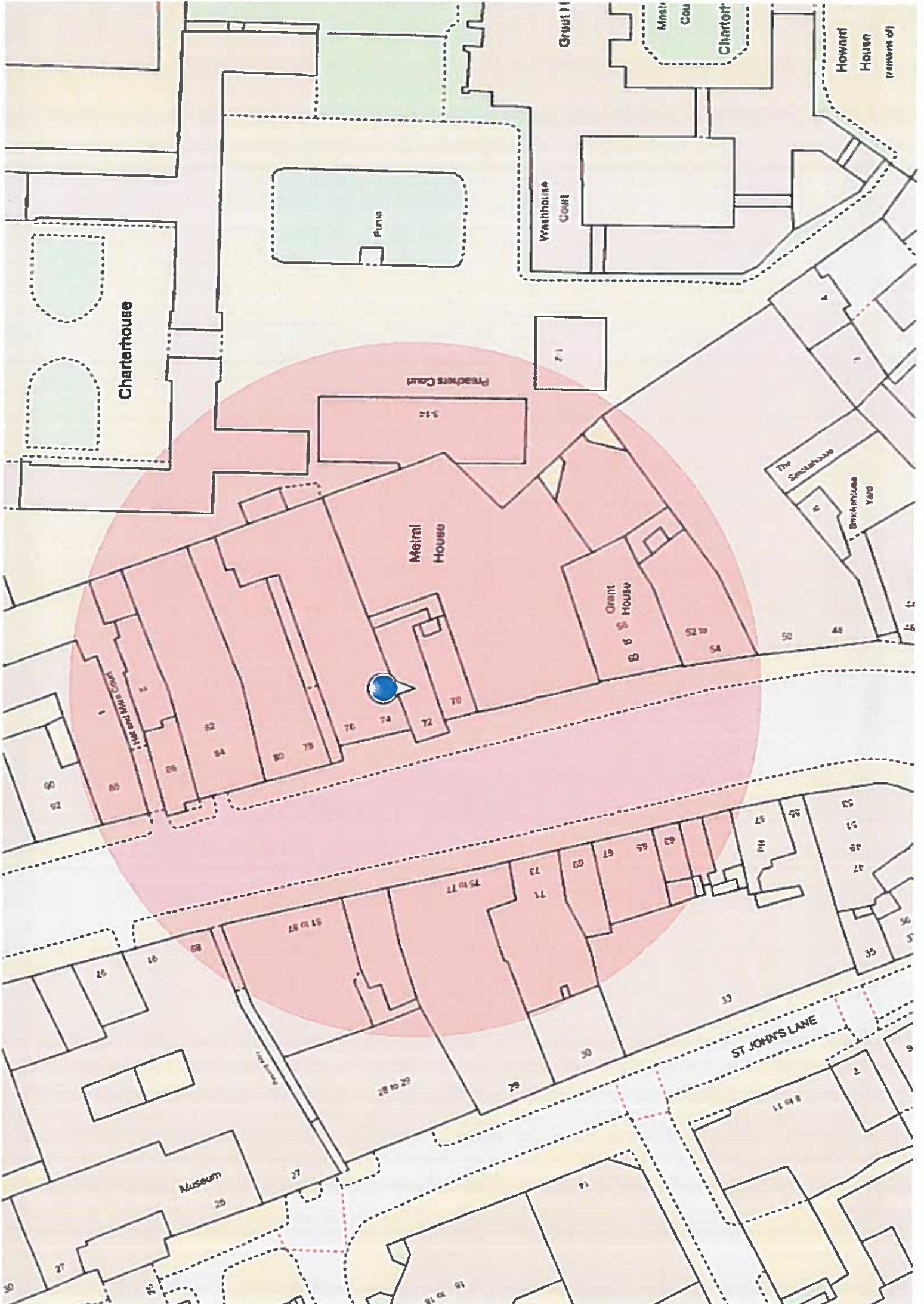

Charterhouse

Preachers Court

Metral House

Grant House

Howard House
(remnant of)

ST JOHN'S LANE

Museum

Washhouse Court

Grout II

Minty Cou

Charter

Pump

The Smockhouse

Smockhouse Yard

Preachers Court 1

75 to 77

33

11 to 11

14

15 to 18

35

37

39

41

43

45

47

49

51

53

55

57

59

61

63

71

3-12

70

72

74

76

78

80

82

84

86

88

90

92

94

96

98

100

102

104

106

30

32

34

36

38

40

42

44

46

48

50

52

54

56

58

60

62

64

66

68